

MICROFILMED  
JUL 8 1986

FOR UTILITY RELOCATION OR  
ADJUSTMENT DETAILS SEE  
SHEET NO. 230.

Remove Sewer Connections along  
St. Clair Street  
(SEE NOTE)

LAKE COUNTY  
LAK-2-14.22

NOTE:  
Field Tile this area drains  
from East to West, pattern  
unknown.

SECTION A-A THROUGH DUMPED ROCK  
LT. STA. 706+50 SEE SHEET NO. 30.  
RT. STA. 713+50

NOTE:  
New Curb and Pavement has been placed on  
St. Clair Street since the original survey.  
For a correct present plan for this area  
See Sheet No. 230

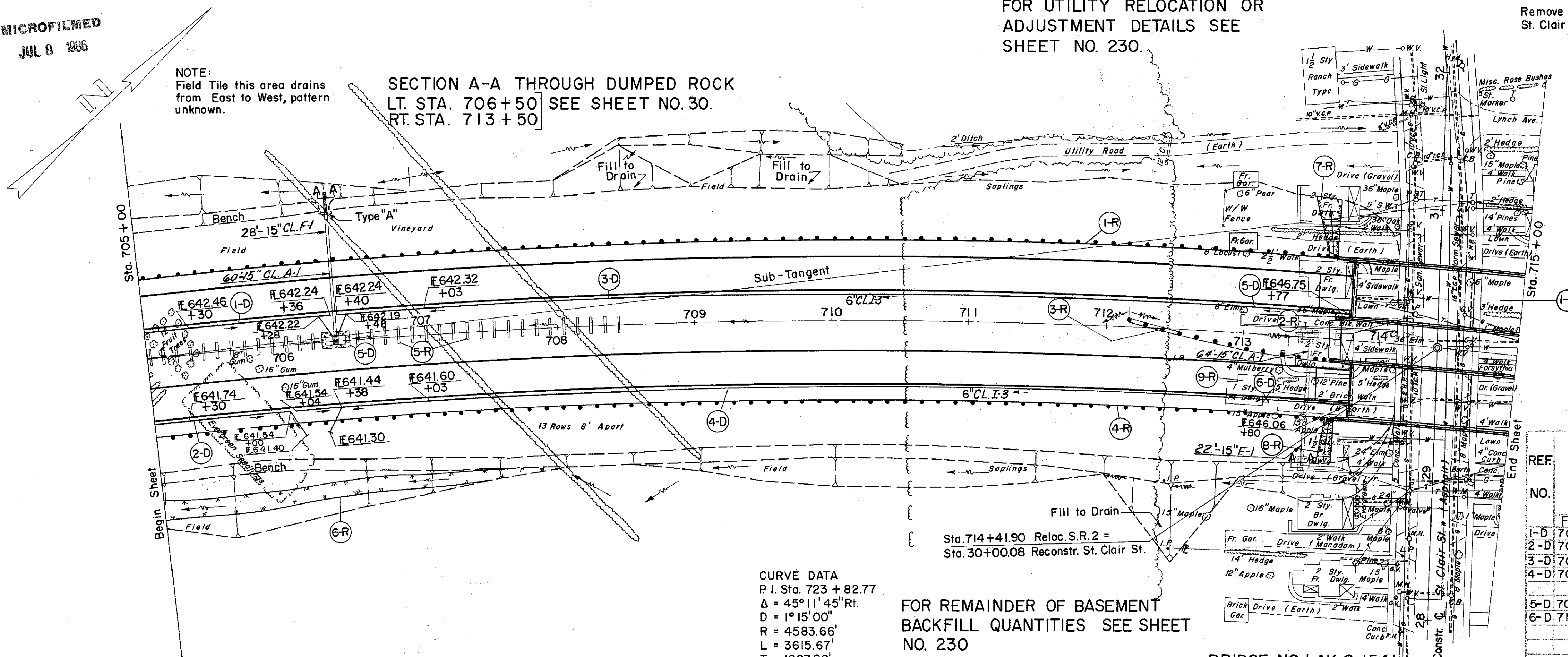

CURVE DATA  
P.I. Sta. 723 + 82.77  
Δ = 45° 11' 45" Rt.  
D = 1° 15' 00"  
R = 4583.66'  
L = 3615.67'  
T = 1907.80'  
E = 381.18'

FOR REMAINDER OF BASEMENT  
BACKFILL QUANTITIES SEE SHEET  
NO. 230

FOR CONSTRUCTION DETAILS ON  
ST. CLAIR STREET SEE SHEET  
NO. 230

BRIDGE NO. LAK-2-1541  
FOR STRUCTURE DETAILS  
SEE SHEETS NO. 331-338

**D DRAINAGE**

REF. NO.	STATION	SIDE	CLASS									
			A-1	F-1	6" PIPE CLASS I-3	8" CL. I-3	15" CL. I-3	6" FOR 60° WYE	6" FOR 60° BEND	STD. MOD. #4 C.B.	DUMPED ROCK CHANNEL PROTECT.	I-2 MASONRY (HEADWALL)
FROM	TO		L.F.	L.F.	L.F.	L.F.	EA.	EA.	EA.	EA.	C.Y.	C.Y.
1-D	705+00	LT.		139	10							
2-D	705+00	RT.		106	10							
3-D	706+40	LT.		741	10							
4-D	706+04	RT.		774	10							
5-D	706+38	R	60	28			2				2.9	3.2
6-D	713+50	R	64	22			2				2.9	3.2
TOTAL			124	50	1,760	40	4	3	1	1	5.8	6.4

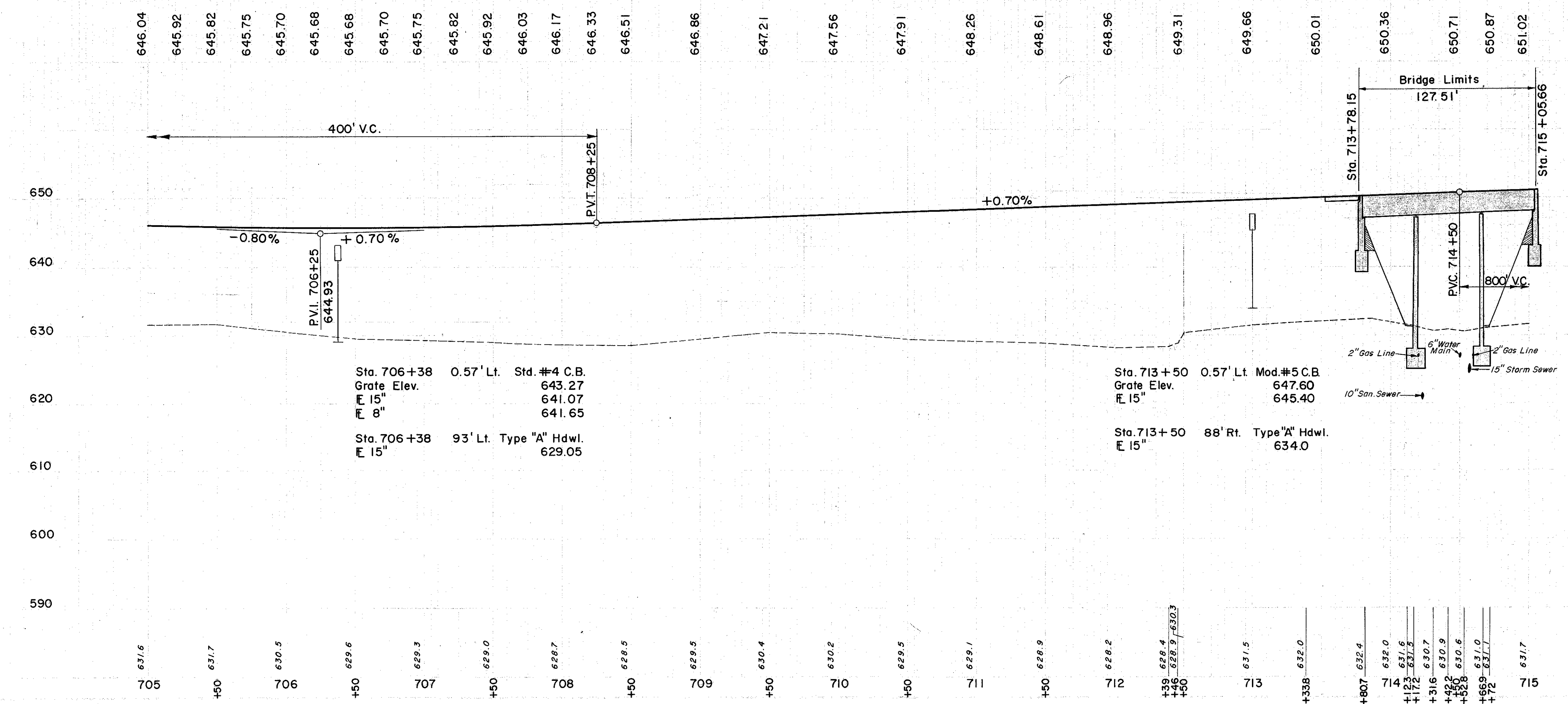

Sta. 706+38 0.57' Lt. Std. #4 C.B.  
Grate Elev. 643.27  
E 15" 641.07  
E 8" 641.65

Sta. 706+38 93' Lt. Type "A" Hdw.  
E 15" 629.05

Sta. 713+50 0.57' Lt. Mod. #5 C.B.  
Grate Elev. 647.60  
E 15" 645.40

Sta. 713+50 88' Rt. Type "A" Hdw.  
E 15" 634.0

**R ROADWAY**

REF. NO.	STATION	SIDE	CLASS				
			E-4 GRANULAR BORROW	I-15 GUARD RAIL STEEL BEAM BARRIER (DEEP)	L-10 GUARD RAIL STEEL BEAM BARRIER (DEEP)	L-10 SODDING FOR SPECIAL BERM AND SLOPE PROTECT.	
FROM	TO		C.Y.	L.F.	S.Y.	S.Y.	
1-R	705+04	LT.			862.5		
2-R	713+50	C				12.7	
3-R	712+17	LT.	112.5	375.5			
4-R	705+00	RT.	862.5				
5-R	706+38	C				98	
6-R	705+00	RT.				363	
7-R	713+61	LT.					44.8
8-R	713+66	RT.					31.8
9-R	713+10	RT.	196				
TOTAL			196	1837.5	375.5	473.7	76.6

**P PAVEMENT**

REF. NO.	STATION	SIDE	CLASS	
			I-7 REINF. CONC. APPR. SLAB T=13"	S.Y.
FROM	TO		S.Y.	
1-P	STRUCTURE		267	
TOTAL			267	

# No Federal Participation

**SODDING RIGHT DITCH**

STATION	WIDTH OF SODDING FT.	LENGTH OF SODDING FT.	S.Y.
705+00	15.3	258	363
707+50	10.0		
SUB TOTAL			

1,228 C.Y.  
87,354 C.Y.  
20 104,825 C.Y.