

FOR BASEMENT BACKFILL QUANTITIES SEE SHEET NO. 225  
FOR DETAILS ON SANFORD STREET SEE SHEET NO. 225

SECTION A-A THROUGH DUMPED ROCK  
RT. STA. 697 + 50 &  
RT. STA. 701 + 00  
SEE SHEET NO. 30

Field Tile this area Drains  
from East to West, Pattern  
Unknown.

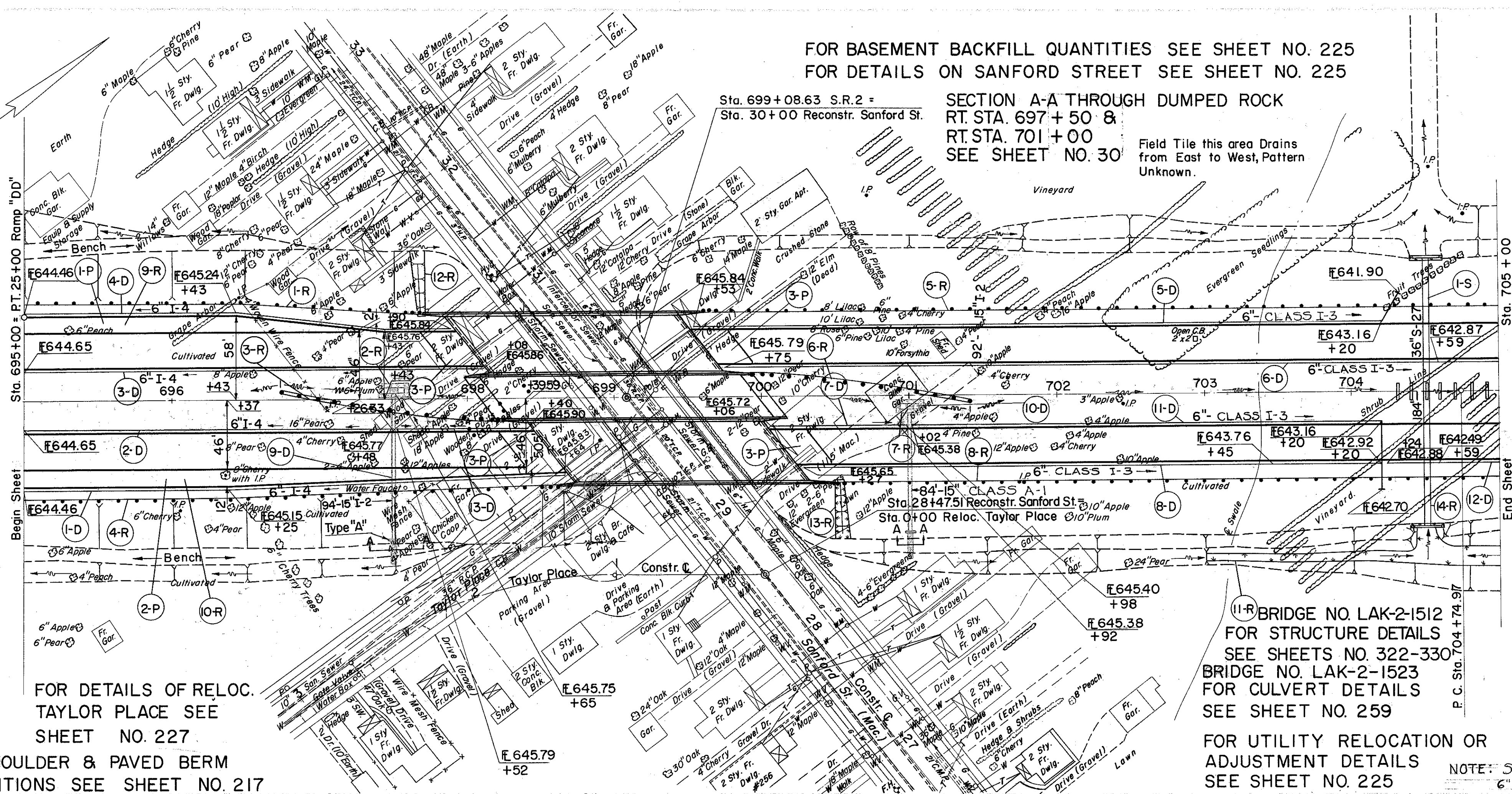

FOR DETAILS OF RELOC.  
TAYLOR PLACE SEE  
SHEET NO. 227  
FOR SHOULDER & PAVED BERM  
TRANSITIONS SEE SHEET NO. 217

BRIDGE NO. LAK-2-1512  
FOR STRUCTURE DETAILS  
SEE SHEETS NO. 322-330  
BRIDGE NO. LAK-2-1523  
FOR CULVERT DETAILS  
SEE SHEET NO. 259  
FOR UTILITY RELOCATION OR  
ADJUSTMENT DETAILS  
SEE SHEET NO. 225

NOTE: See Note For  
6" I-4 Sheet 40

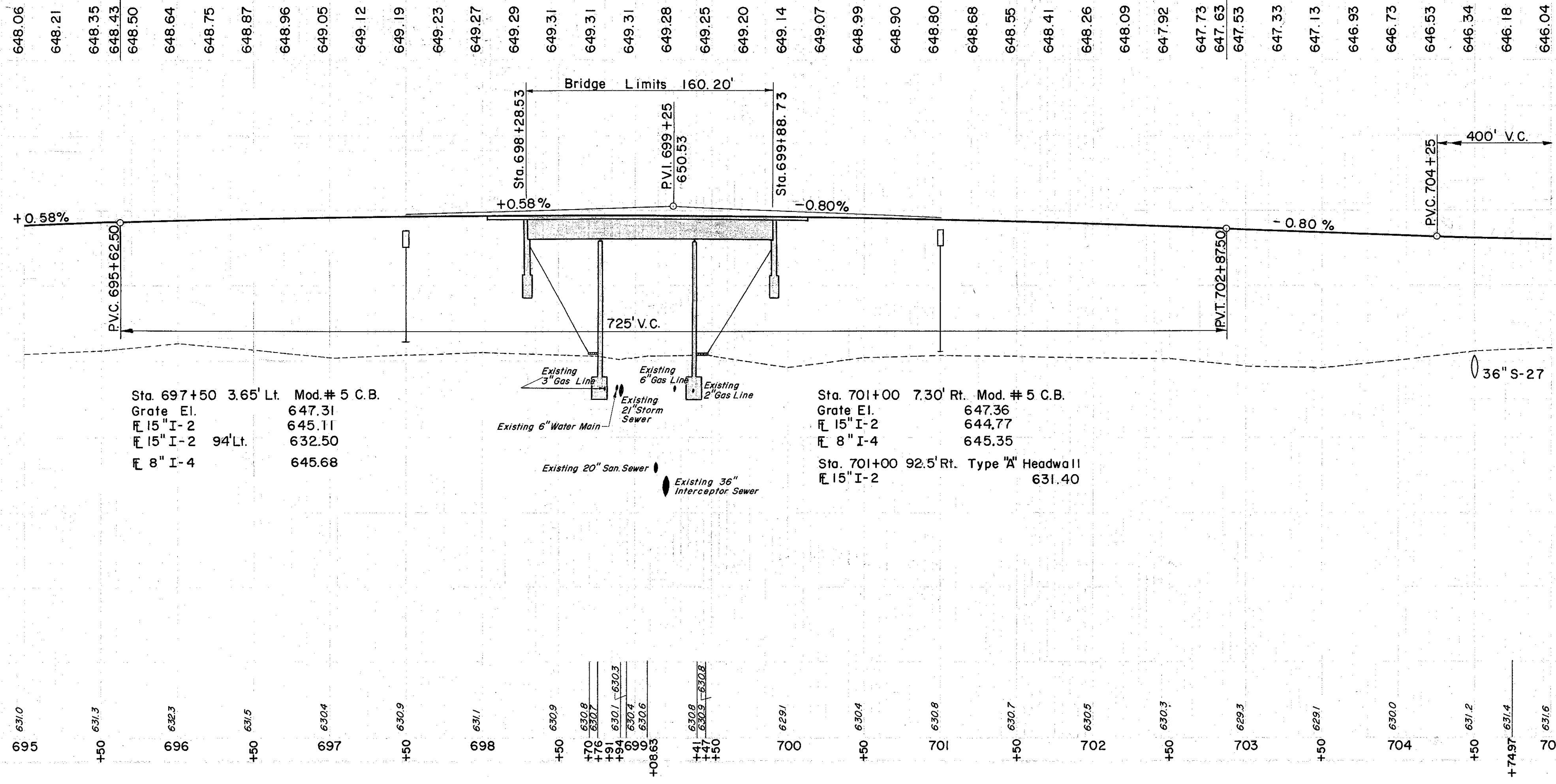

Sta. 697+50 3.65' Lt. Mod. # 5 C.B.  
Grate El. 647.31  
15" I-2 645.11  
15" I-2 94" Lt. 632.50  
8" I-4 645.68

Sta. 701+00 7.30' Rt. Mod. # 5 C.B.  
Grate El. 647.36  
15" I-2 644.77  
8" I-4 645.35  
Sta. 701+00 92.5' Rt. Type 'A' Headwall  
15" I-2 631.40

REF. NO.	STATION	S I D E		DRAINAGE		PAVEMENT		STRUCTURE		ROADWAY	
		FROM	TO	CLASS	TYPE	CLASS	TYPE	REF. NO.	STATION	FROM	TO
1-R	695+08	697+71	LI	15" FOR CLASS I-3 PIPE	I-5	EA	EA	EA	EA	EA	EA
2-R	697+50	697+50	LI	6" TO 8" TEE	I-5	EA	EA	EA	EA	EA	EA
3-R	695+00	698+63	RI	6" 60° WYEBEND/INCR	I-5	EA	EA	EA	EA	EA	EA
4-R	695+54	705+04	LI	10" 60° WYEBEND/INCR	I-5	EA	EA	EA	EA	EA	EA
5-R	699+75	701+42R	LI	10" 60° WYEBEND/INCR	I-5	EA	EA	EA	EA	EA	EA
6-R	701+00	705+00	RI	10" 60° WYEBEND/INCR	I-5	EA	EA	EA	EA	EA	EA
7-R	700+50	705+00	RI	10" 60° WYEBEND/INCR	I-5	EA	EA	EA	EA	EA	EA
8-R	700+50	705+00	RI	10" 60° WYEBEND/INCR	I-5	EA	EA	EA	EA	EA	EA
9-R	695+00	697+43	LI	10" 60° WYEBEND/INCR	I-5	EA	EA	EA	EA	EA	EA
10-R	692+50	698+70	RI	10" 60° WYEBEND/INCR	I-5	EA	EA	EA	EA	EA	EA
11-R	703+00	705+00	RI	10" 60° WYEBEND/INCR	I-5	EA	EA	EA	EA	EA	EA
12-R	697+68	705+00	RI	10" 60° WYEBEND/INCR	I-5	EA	EA	EA	EA	EA	EA
13-R	700+53	705+00	RI	10" 60° WYEBEND/INCR	I-5	EA	EA	EA	EA	EA	EA
14-R	704+50	705+00	RI	10" 60° WYEBEND/INCR	I-5	EA	EA	EA	EA	EA	EA
TOTAL		1,743	1,850	#750	279	83.9	279	112	253	195	6

REF. NO.	STATION	S I D E		PAVEMENT		STRUCTURE		ROADWAY	
		FROM	TO	CLASS	TYPE	REF. NO.	STATION	FROM	TO
1-R	695+00	697+43	LI	15" FOR CLASS I-3 PIPE	I-5	EA	EA	EA	EA
2-R	697+50	697+50	LI	6" TO 8" TEE	I-5	EA	EA	EA	EA
3-R	695+00	698+63	RI	6" 60° WYEBEND/INCR	I-5	EA	EA	EA	EA
4-R	695+54	705+04	LI	10" 60° WYEBEND/INCR	I-5	EA	EA	EA	EA
5-R	699+75	701+42R	LI	10" 60° WYEBEND/INCR	I-5	EA	EA	EA	EA
6-R	701+00	705+00	RI	10" 60° WYEBEND/INCR	I-5	EA	EA	EA	EA
7-R	700+50	705+00	RI	10" 60° WYEBEND/INCR	I-5	EA	EA	EA	EA
8-R	700+50	705+00	RI	10" 60° WYEBEND/INCR	I-5	EA	EA	EA	EA
9-R	695+00	697+43	LI	10" 60° WYEBEND/INCR	I-5	EA	EA	EA	EA
10-R	692+50	698+70	RI	10" 60° WYEBEND/INCR	I-5	EA	EA	EA	EA
11-R	703+00	705+00	RI	10" 60° WYEBEND/INCR	I-5	EA	EA	EA	EA
12-R	697+68	705+00	RI	10" 60° WYEBEND/INCR	I-5	EA	EA	EA	EA
13-R	700+53	705+00	RI	10" 60° WYEBEND/INCR	I-5	EA	EA	EA	EA
14-R	704+50	705+00	RI	10" 60° WYEBEND/INCR	I-5	EA	EA	EA	EA
TOTAL		65	65	279	112	253	195	6	965

844 C.Y.  
84,499 C.Y.  
20 101,399 C.Y.