

LAKE COUNTY
LAK-2-10.35

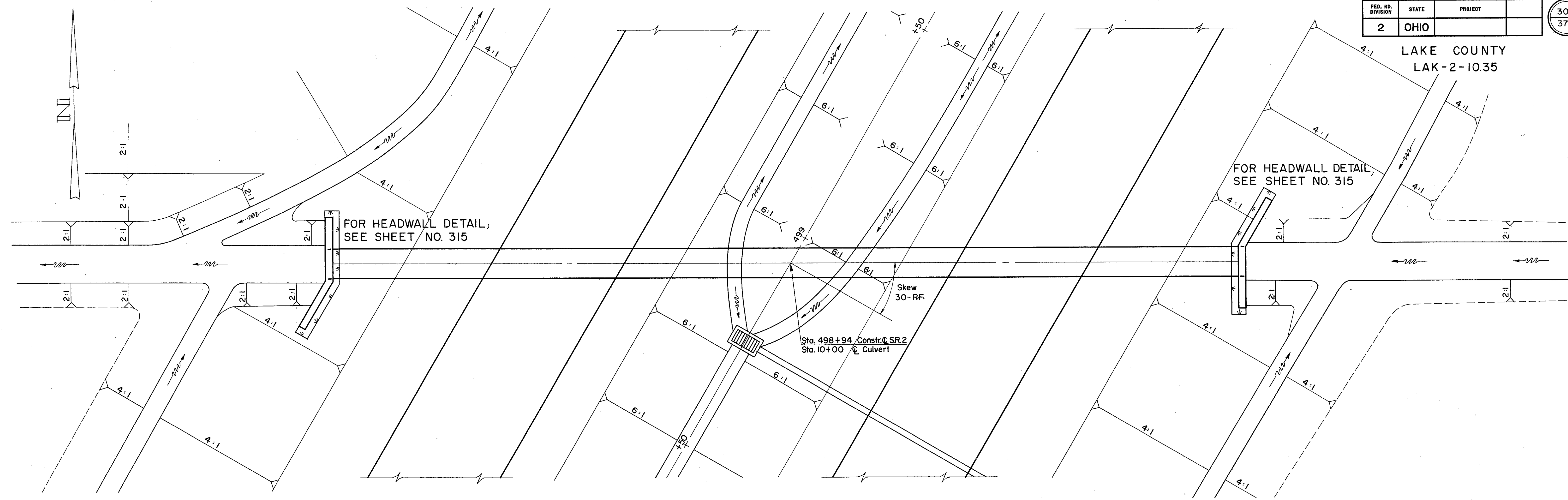

AREA = 200 ACRES
Q₂₅ = 110 C.F.S.

HEADWATER = 3.76 FT.
OUTLET VELOCITY = 6.8 F.P.S.

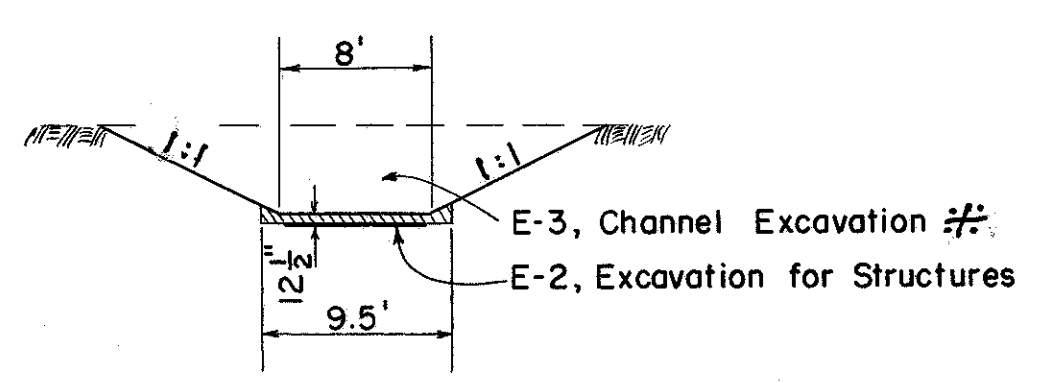
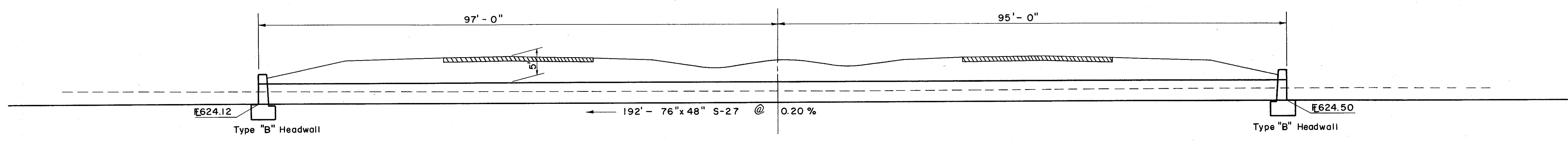

METHOD OF ESTIMATING E-3 & E-2, EXCAVATION

≠ See Note on Sheet No 11.

ESTIMATED QUANTITIES

** E-2	Excavation for Structures	125 C.Y.
* E-3	Channel Excavation	1188 C.Y. ≠
S-1	Concrete for Structures Class "C"	39.8 C.Y.
S-4	Reinforcing Steel	1564 Lbs.
L-10	Sodding	10 S.Y.
S-27	76"x 48" Pipe for Roadway Culverts Sec. M-206.6(b)	192 L.F.
** Includes Excavation for Headwalls		
* Channel Excavation beyond Structure Limits carried on Hendricks Road.		

CULVERT DATA

TYPE: S-27 Sec. M-206.6 (b)
SIZE: 192' - 76" x 48"
WORK REQUIRED: Build a pipe culvert with type "B" headwalls. Place sodding and excavate channel Rt. and Lt. as shown.