

6-5

F-15

LAKE COUNTY
LAK-2-10.35

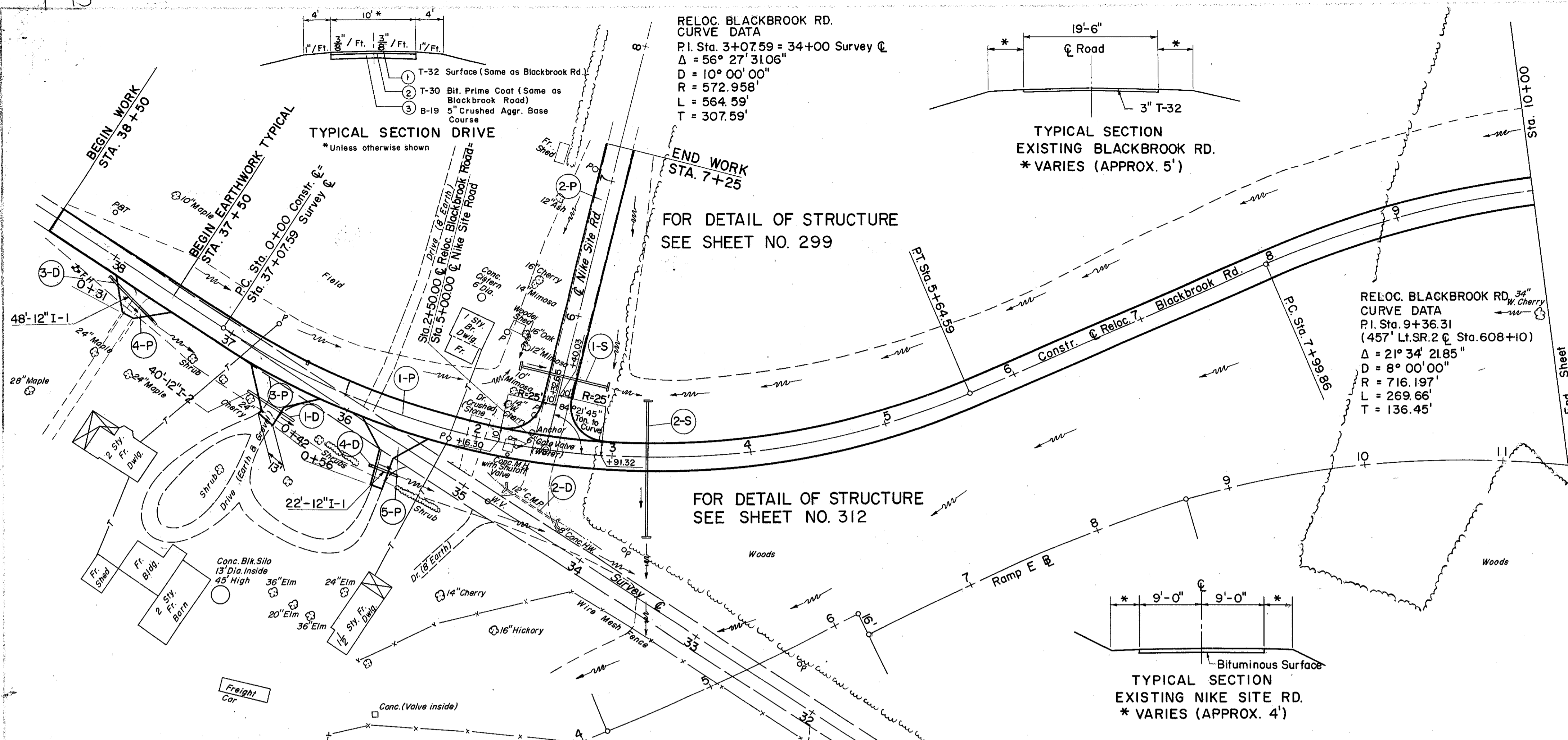

(P) PAVEMENT

REF. NO.	STATION	SIDE	T-32	T-32	T-32	T-32	T-32	T-30	B-19	I-22	I-9	E-1
			# 46 AGGR. FOR ROAD MIX	BIT. MATL. FOR ROAD MIX	# 6 AGGR. FOR CHOKES	# 6 AGGR. FOR SEAL	BIT. MATL. FOR SEAL	BIT. PRIME COAT	CRUSHED AGGR. BASE COURSE	SUB-BASE	STONE UNDER DRAIN	COMP. SUB-GRADE
FROM TO			C.Y.	GAL.	C.Y.	C.Y.	GAL.	GAL.	C.Y.	C.Y.	L.F.	S.Y.
1-P	38+50.00	10+00.00	141.86	2279.82	10.13	20.27	633.28	1013.25	369.45	309.67	300	2787.00
2-P	NIKE SITE RD.	2+50.00	LT.	28.77	462.44	2.06	4.11	128.46	205.53	74.27	61.73	84
3-P	Drive	0+55	RT.	5.44	87.50	0.39	0.78	24.31	38.89	13.50		
4-P	Drive	37+70	RT.	3.73	60.00	0.27	0.53	16.67	26.67	9.26		
5-P	Drive	1+43	RT.	5.35	86.00	0.38	0.76	23.89	38.22	13.27		

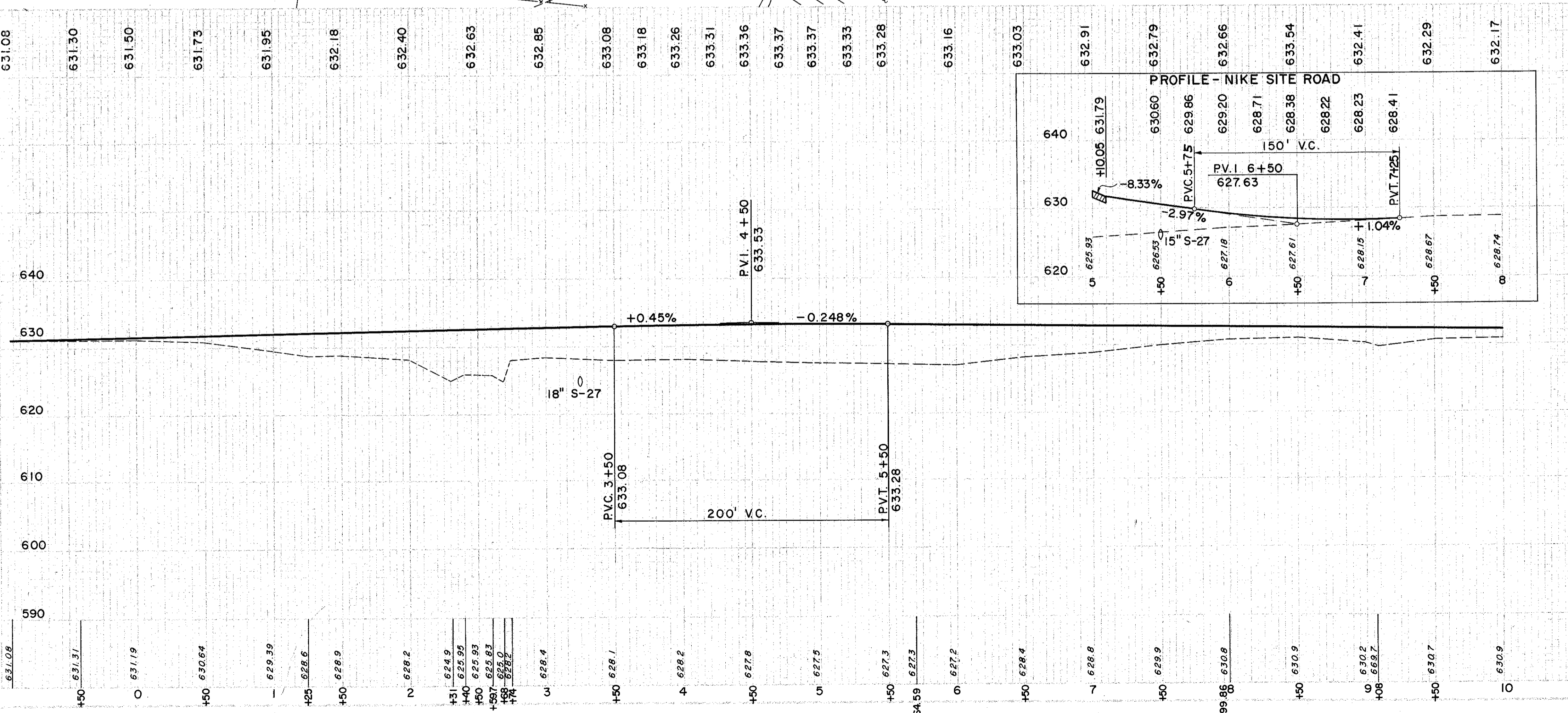

(S) STRUCTURES

REF. NO.	STATION	SIDE	E-2	E-3	L-10	S-1	S-27
			EXC. FOR STRUCT.	CHANNEL EXC.	SODDING	CONC. FOR STRUCT. CL. "E"	15" PIPE FOR RDWY. FOR RDWY. CULVERTS; SEC. M-6(8) OR M-66(b) OR M-6.6(b)
FROM TO			C.Y.	C.Y.	S.Y.	C.Y.	L.F.
1-S	5+55	NIKE Site Rd.	13.5	8	0.52	66	100
2-S	3+25	Blackbrook Rd.	46	49.5	9	0.6	

(D) DRAINAGE

REF. NO.	STATION	SIDE	I-1	E-12
			12" PIPE FOR DRIVEWAYS	PIPE REMOVAL 15" & UNDER
FROM TO			L.F.	L.F.
1-D	0+39	0+79	RT.	40
2-D	2+28	2+68	RT.	46
3-D	37+70		RT.	48
4-D	0+55		RT.	22

EXCAVATION	5,194 C.Y.
EMBANKMENT	6,929 C.Y.
GRAVELTY	20%
	8,315 C.Y.