

Seeding
End Area
Sq. Yds.

FED. ROAD DIST. NO. 2
STATE OHIO
PROJECT

217
379

LAKE COUNTY
LAK-2-10.35

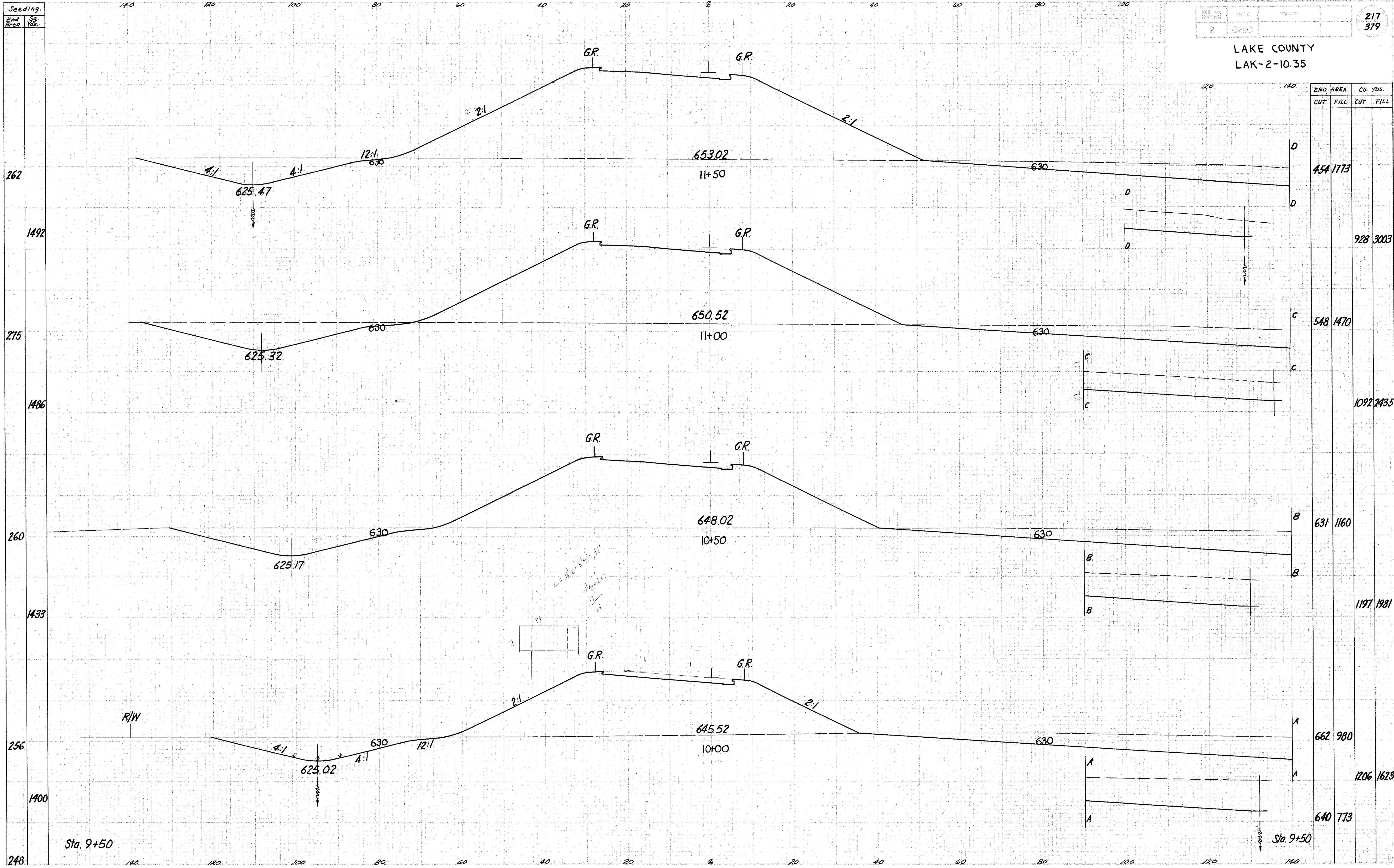

$C = 11 \frac{1}{2} + 8 \frac{1}{2} = 19'$
 $\frac{19}{2} = 9.5'$

Ramp "E" Sta. 10+00 to 11+50