

Sta. 0+00.00 Ramp D  $\square$  =  
 Sta. 12+73.45 Ramp A  $\square$  =  
 Sta. 36+30.00  $\square$  Constr. Heisley Rd.

RAMP D  
 CURVE DATA  
 P.I. Sta. 3+58.91  
 $\Delta = 47^\circ 41' 23.22''$   
 $D = 8^\circ 00' 00''$   
 $R = 716.97'$   
 $L = 596.12'$   
 $T = 316.55'$

FOR DETAILS OF RAMP D  
 SEE SHEETS NO. 195 & 197

RAMP D  
 CURVE DATA  
 P.I. Sta. 7+74.12  
 $\Delta = 10^\circ 49' 06.78''$   
 $D = 4^\circ 00' 00''$   
 $R = 1432.394'$   
 $L = 270.46'$   
 $T = 135.64'$

LAKE COUNTY  
 LAK-2-1035

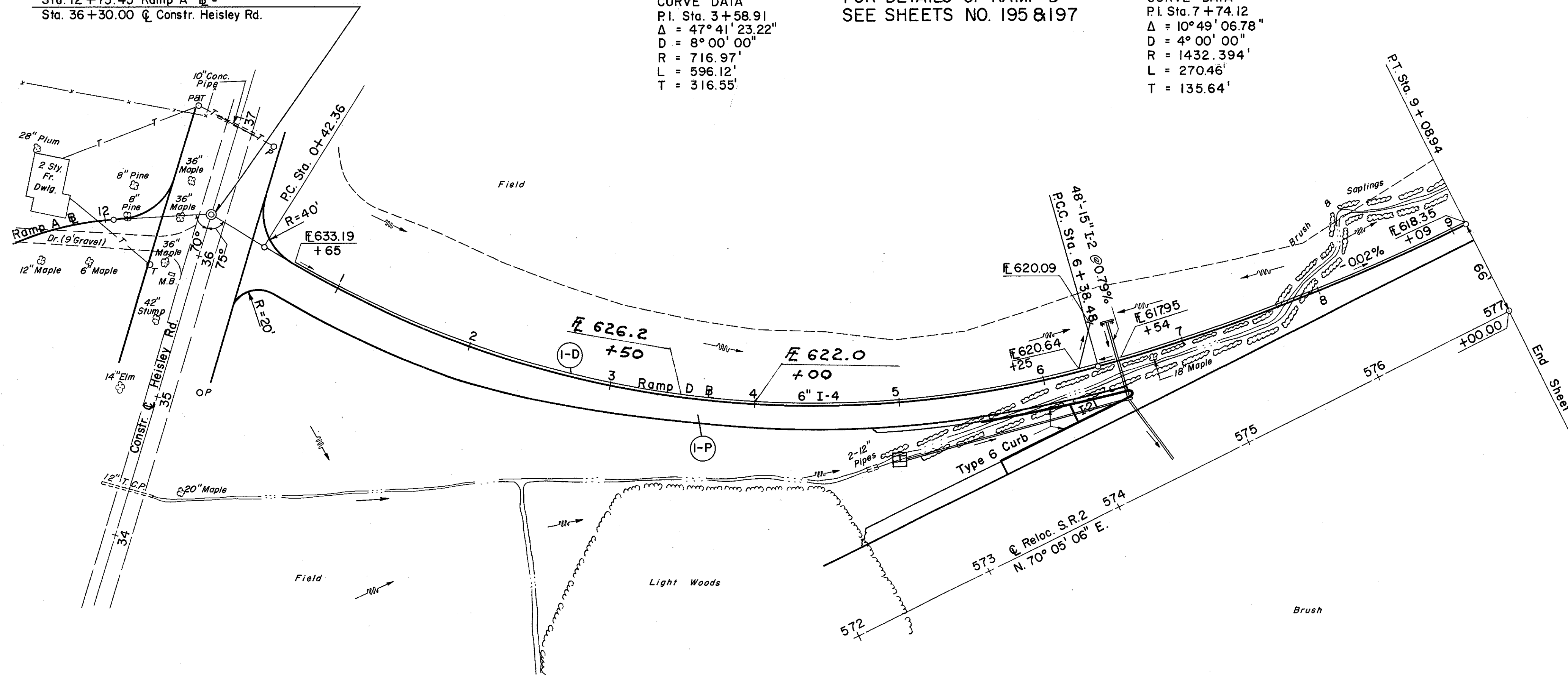

(D) DRAINAGE

REF. NO.	STATION	SIDE $\square$	I-4		I-5
			SHALLOW	DEEP	6" 60° WYE
I-D	HEISLEY RD 36+30.00	Rt	2.85	6.48	10

(P) PAVEMENT

REF. NO.	STATION	SIDE $\square$	T-71	B-219	I-22	I-12	I-21	T-31	I-18	E-1	
			10" REINF. PORT. CEM. CONC. PAVT.	3" WATER PROOFED AGGR. BASE COURSE	SUBBASE	PORT. CEM. CONC. CURB TYPE 6	PORT. CEM. CONC. MEDIAN PAVT. TYPE 1	BIT. SURFACE TREATMENT	# 6 MATL. AGGR.	CRUSHED AGGR. SHLDRS. & APPR.	COMP. SUBGRADE
FROM TO			S.Y.	C.Y.	C.Y.	L.F.	S.Y.	GAL	C.Y.	C.Y.	
I-P	0+00.00	Rt	2045.99	57.33	500.68	208	31.11	172.00	5.50	99.67	2733.99

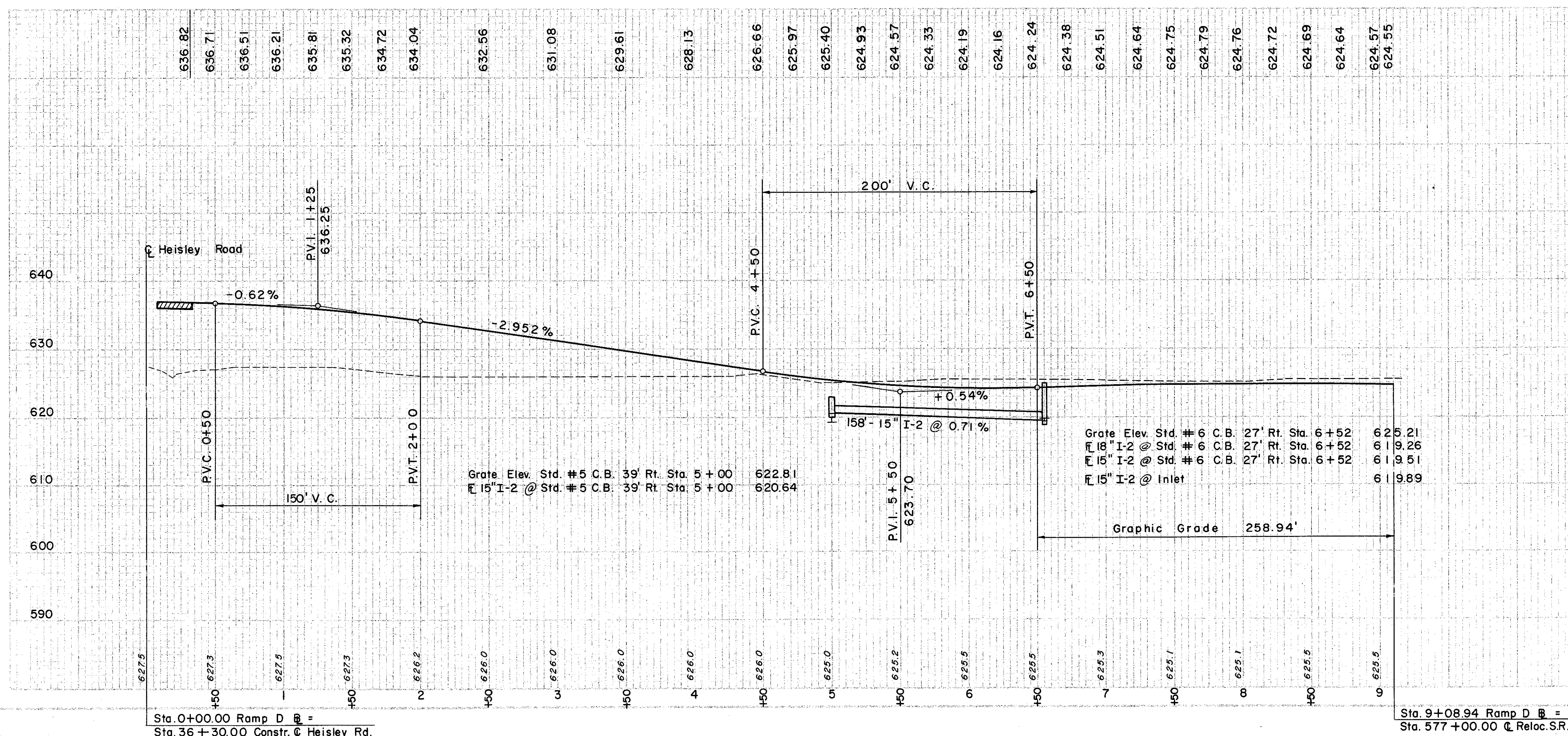

EXCAVATION	2,901 C.Y.
EMBANKMENT	4,356 C.Y.
EMBANKMENT @ 20'	5,227 C.Y.

Sta. 0+00.00 Ramp D  $\square$  =  
 Sta. 36+30.00 Constr. Heisley Rd.

Sta. 9+08.94 Ramp D  $\square$  =  
 Sta. 577+00.00  $\square$  Reloc. S.R.2 (66' Lt.)

RAMP D HEISLEY ROAD INTERCHANGE L-53  
 STA. 0+00.00 TO STA. 9+08.94