

LAKE COUNTY
LAK-2-10.35

D DRAINAGE

REF. NO.	STATION		PIPE FOR DRIVEWAYS		E-12 PIPE REMOVAL 15" & UNDER	E-3 CHANNEL EXC.	E-12 PIPE REMOVED OVER 15"	I-10 DUMPED ROCK CHANNEL PROTECT
			36"	12"				
1-D	37+64	38+00	RT.	36				
2-D	37+71				42			
3-D	38+53	39+12	LT.	44				17
4-D	35+00	39+25	LT.			684		
5-D	38+72	38+93	LT.				21	

P PAVEMENT

REF. NO.	STATION	SIDE	T-32	T-32	T-32	T-32	T-32	T-30	B-19	I-22	I-9	E-1
			#46 AGGR. FOR ROAD MIX	BIT. MATL. FOR ROAD MIX	#6 AGGR. FOR CHOKE	#6 AGGR. FOR SEAL	BIT. MATL. FOR SEAL	BIT. PRIME COAT	CRUSHED AGGR. BASE COURSE	SUB-BASE	STONE UNDER DRAIN	COMP. SUB-GRADE
	FROM	TO	C.Y.	GAL.	C.Y.	C.Y.	GAL.	GAL.	C.Y.	C.Y.	L.F.	S.Y.
1-P	35+00	39+25	42.31	680.00	3.02	6.04	188.89	302.22	111.44	94.44	204	850.00
2-P	37+82±		5.76	92.50	0.41	0.82	25.70	4.11	14.28			
3-P	38+79±		4.04	65.00	0.29	0.58	18.06	28.89	10.03			
4-P	38+75±		1.80	28.95	0.13	0.26	8.04	12.87	4.47			

R ROADWAY

REF. NO.	STATION	SIDE	I-15 GUARD RAIL/WIRE CABLE TYPE 3 CABLES	
			L.F.	
1-R	35+00	36+63	LT.	176
2-R	35+12	36+56	RT.	160
TOTAL				336

FOR FRONTAGE ROAD
SEE SHEETS NO. 142-146

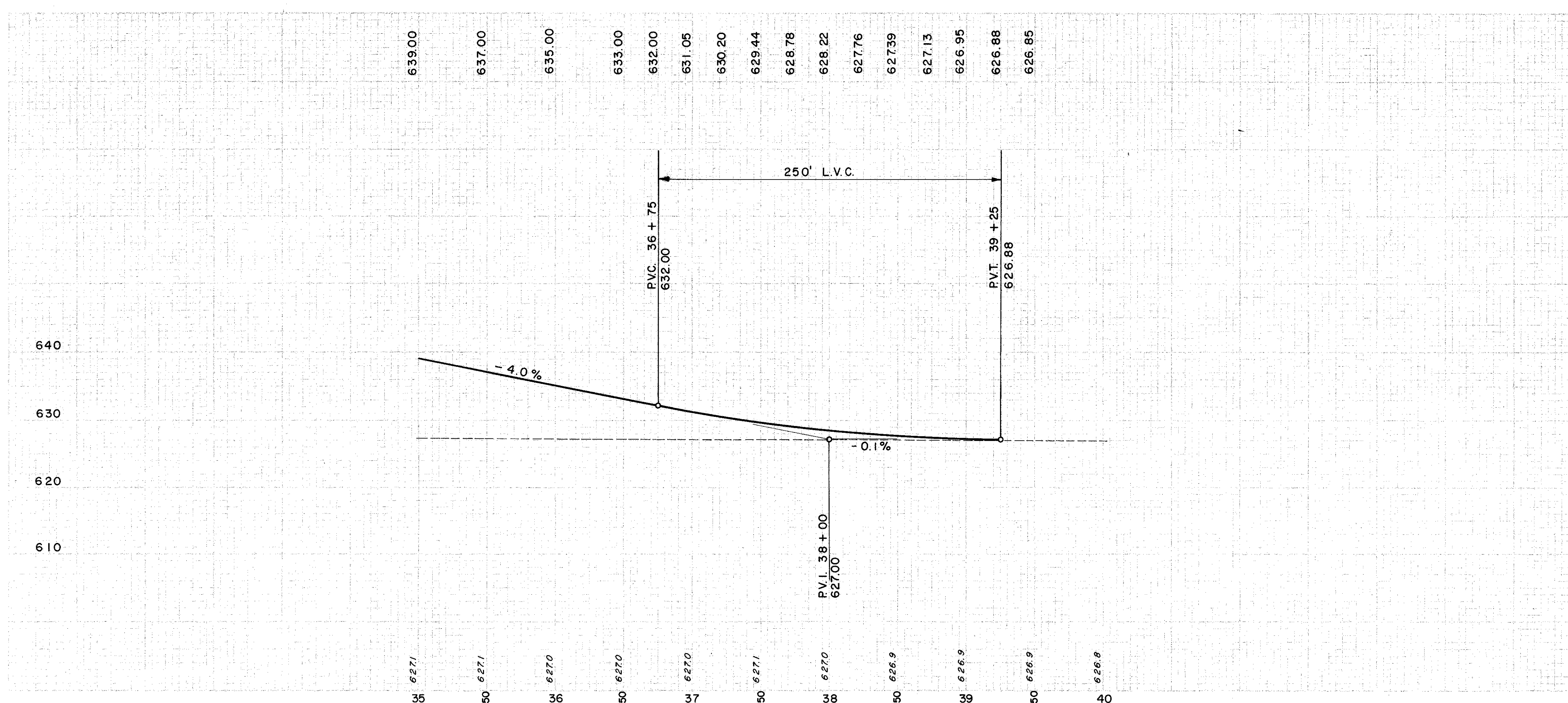
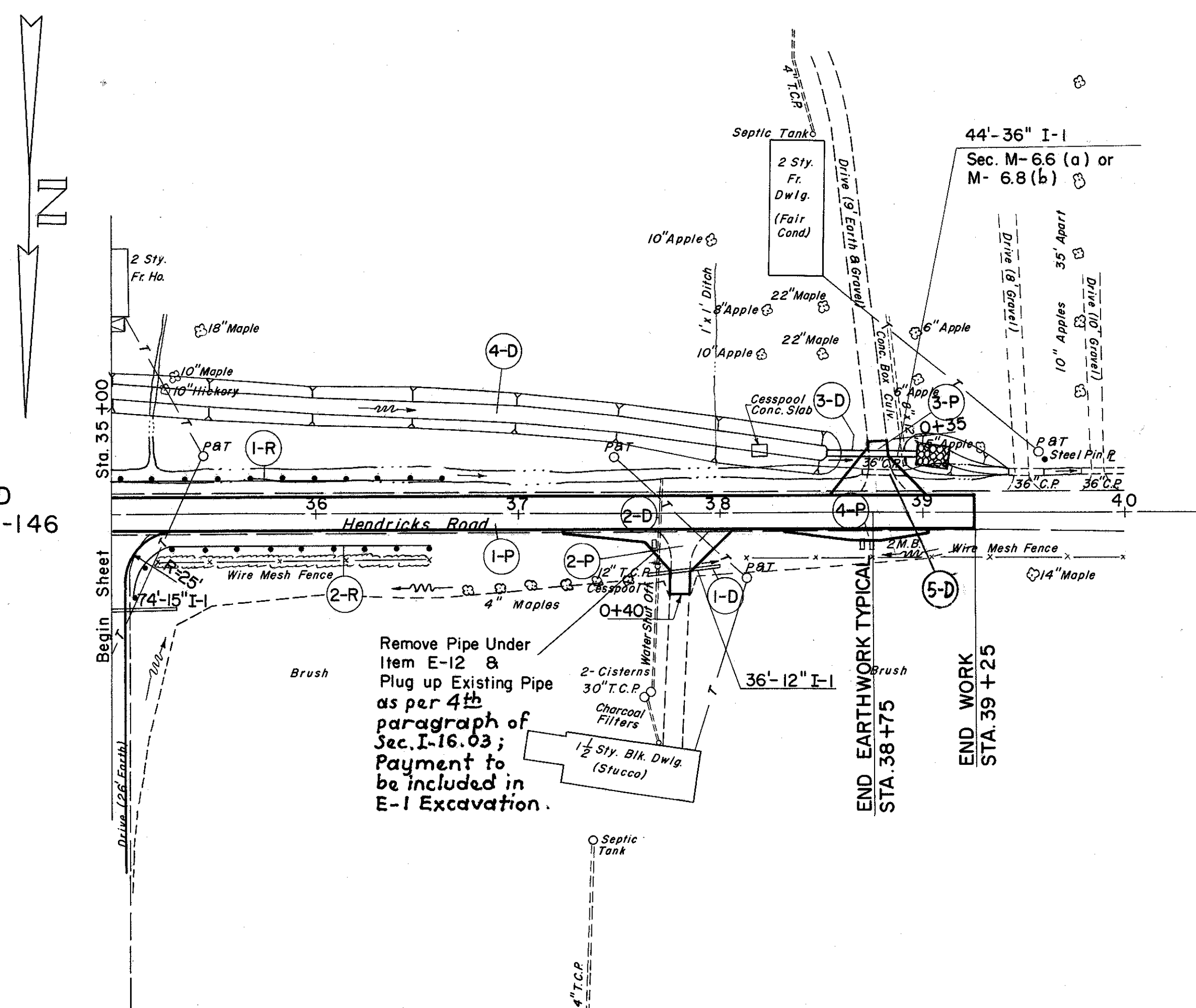

Excavation	103 C.Y.
Embarkment	3,902 C.Y.
Embarkment - 20"	4,682 C.Y.