

Seeding
End Area
Sq. Yds.

114
379

LAKE COUNTY
LAK-2-10.35

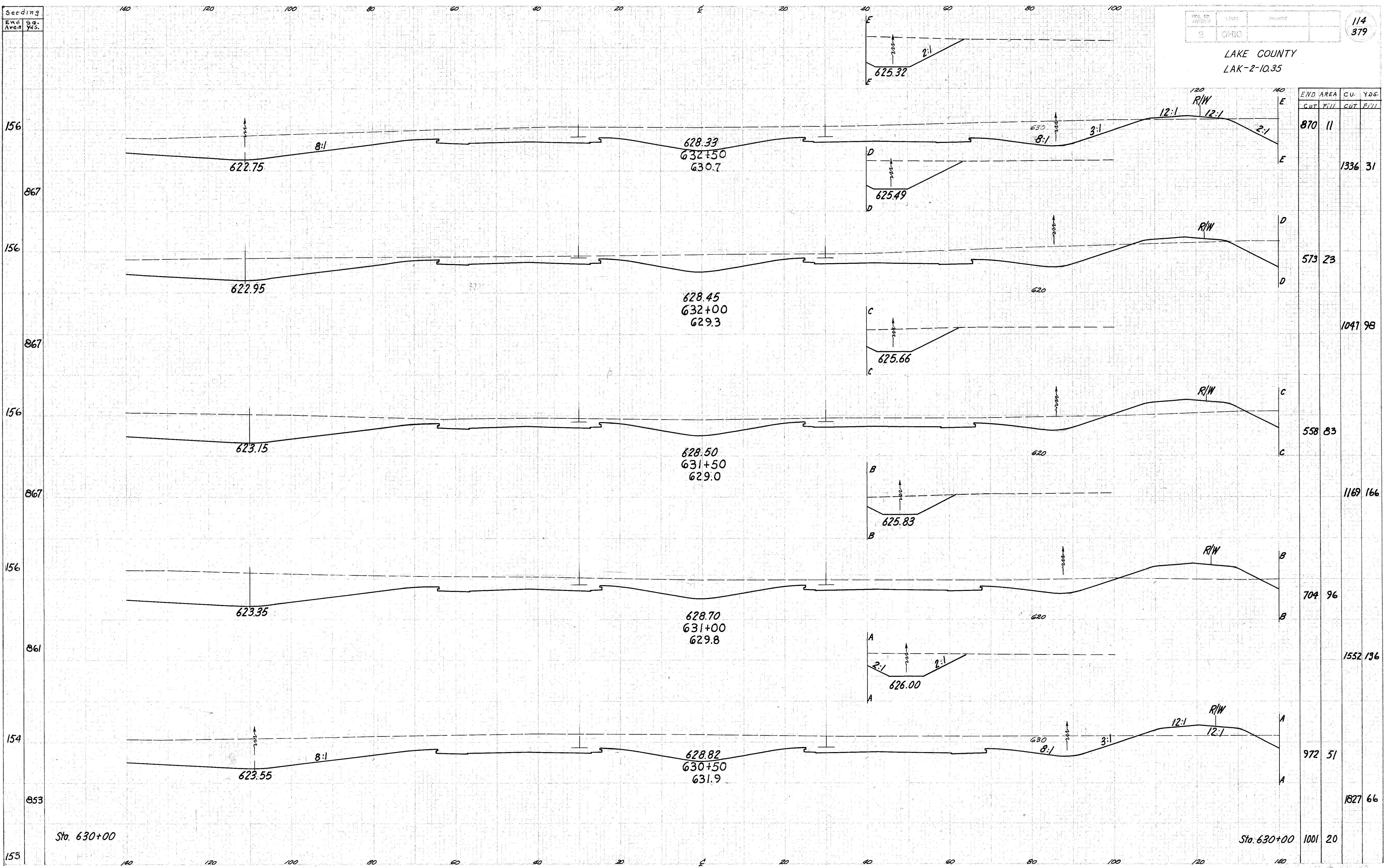

| END AREA | CU. YDS. | |
|----------|----------|------|
| | CUT | FILL |
| 870 | 11 | |
| | | 1336 |
| 573 | 23 | |
| | | 1041 |
| 558 | 83 | |
| | | 1169 |
| 704 | 96 | |
| | | 1552 |
| 972 | 51 | |
| | | 1827 |

Sta. 630+00

Sta. 630+00 1001 20

Relocation SR 2

Sta. 630+50 to 632+50