

Seeding
End Area
@
yds.

LAKE COUNTY
LAK-2-10.35

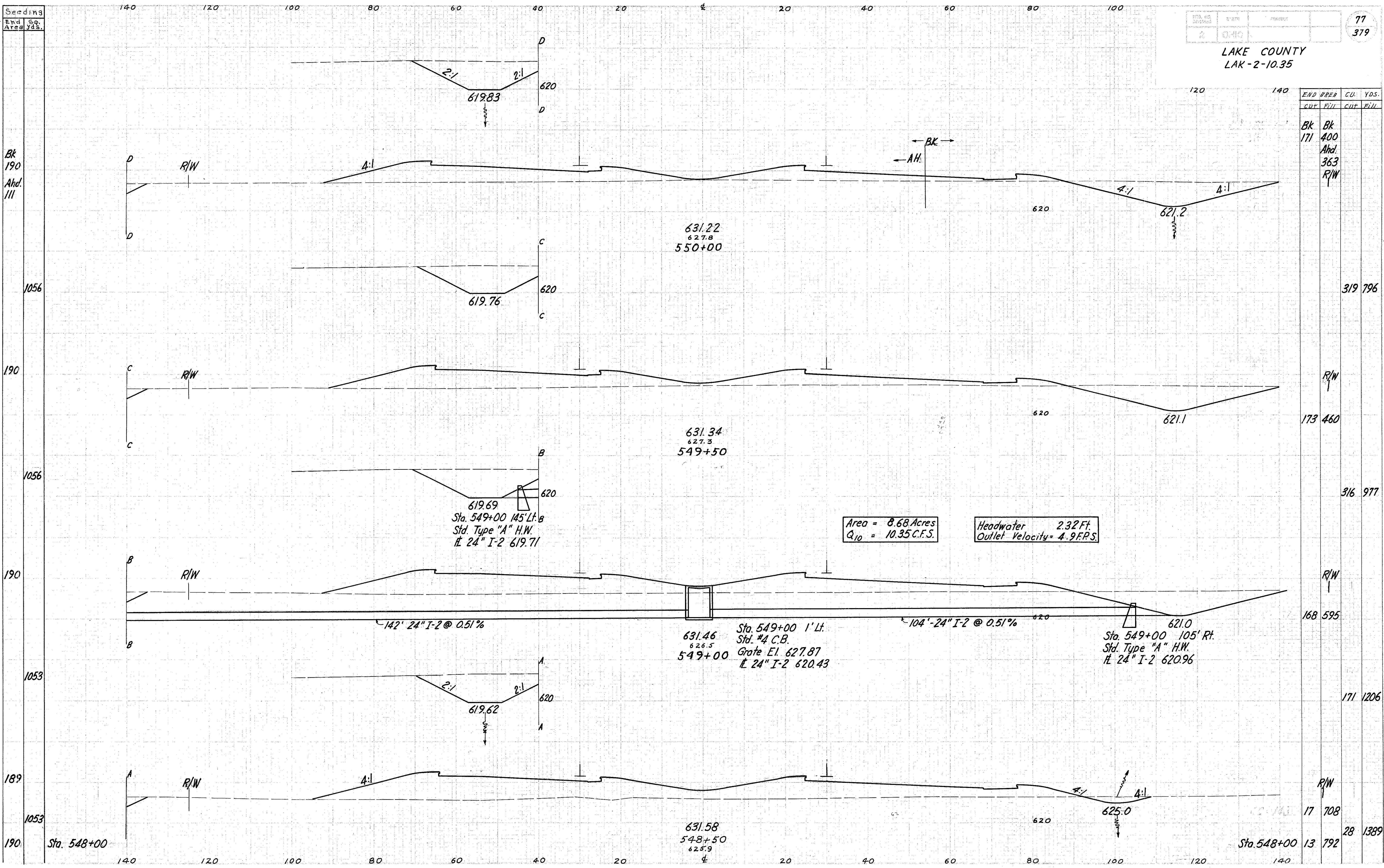

END AREA		CU. YDS.	
CUT	FILL	CUT	FILL
BK	BK		
171	400		
Ahd.	Ahd.		
	363		
R/W	R/W		
		319	796
		R/W	
		173	460
		316	977
		R/W	
		168	595
		171	1206
		17	708
		28	1389

Area = 8.68 Acres
Q₁₀ = 10.35 C.F.S.

Headwater 2.32 FT
Outlet Velocity = 4.9 F.P.S.

619.69
Sta. 549+00 145' Lt. B
Std. Type "A" H.W.
24" I-2 619.71

631.46
626.5
549+00
Sta. 549+00 1' Lt.
Std. #4 C.B.
Grate El. 627.87
24" I-2 620.43

621.0
Sta. 549+00 105' Rt.
Std. Type "A" H.W.
24" I-2 620.96

Relocation SR 2

Sta. 548+50 to 550+00