

Seeding
End Area
Sq. Yds.

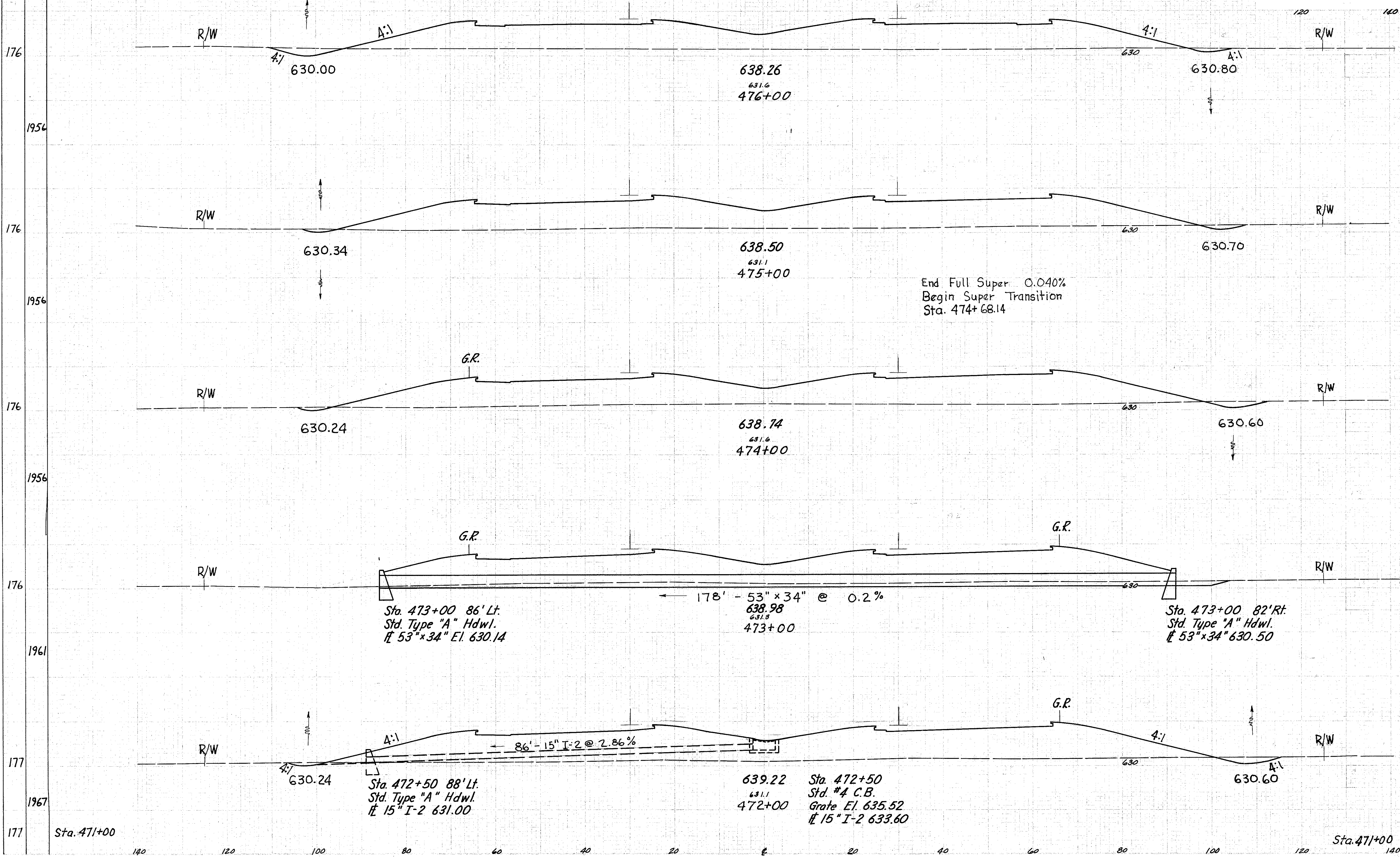

Elev.	E/ND AREA		C.U. YDS.	
	CUT	FILL	CUT	FILL
176	27	930		
1954			83	3652
176	18	1042		
1956			80	3891
176	25	1032		
1956			87	3874
176	22	1060		
1961			76	4096
177	19	1152		
1967			81	4289
177	25	1164		

End Full Super 0.040%
Begin Super Transition
Sta. 474+68.14

Sta. 473+00 86' Lt.
Std. Type "A" Hdwl.
53" x 34" El. 630.14

638.98
631.9
473+00

Sta. 473+00 82' Rt.
Std. Type "A" Hdwl.
53" x 34" 630.50

Sta. 472+50 88' Lt.
Std. Type "A" Hdwl.
15" I-2 631.00

639.22
631.1
472+00

Sta. 472+50
Std. #4 C.B.
Grate El. 635.52
15" I-2 633.60

Relocation SR 2

Sta. 472+00 to 476+00