

LAKE COUNTY  
 LAK-2-10.35

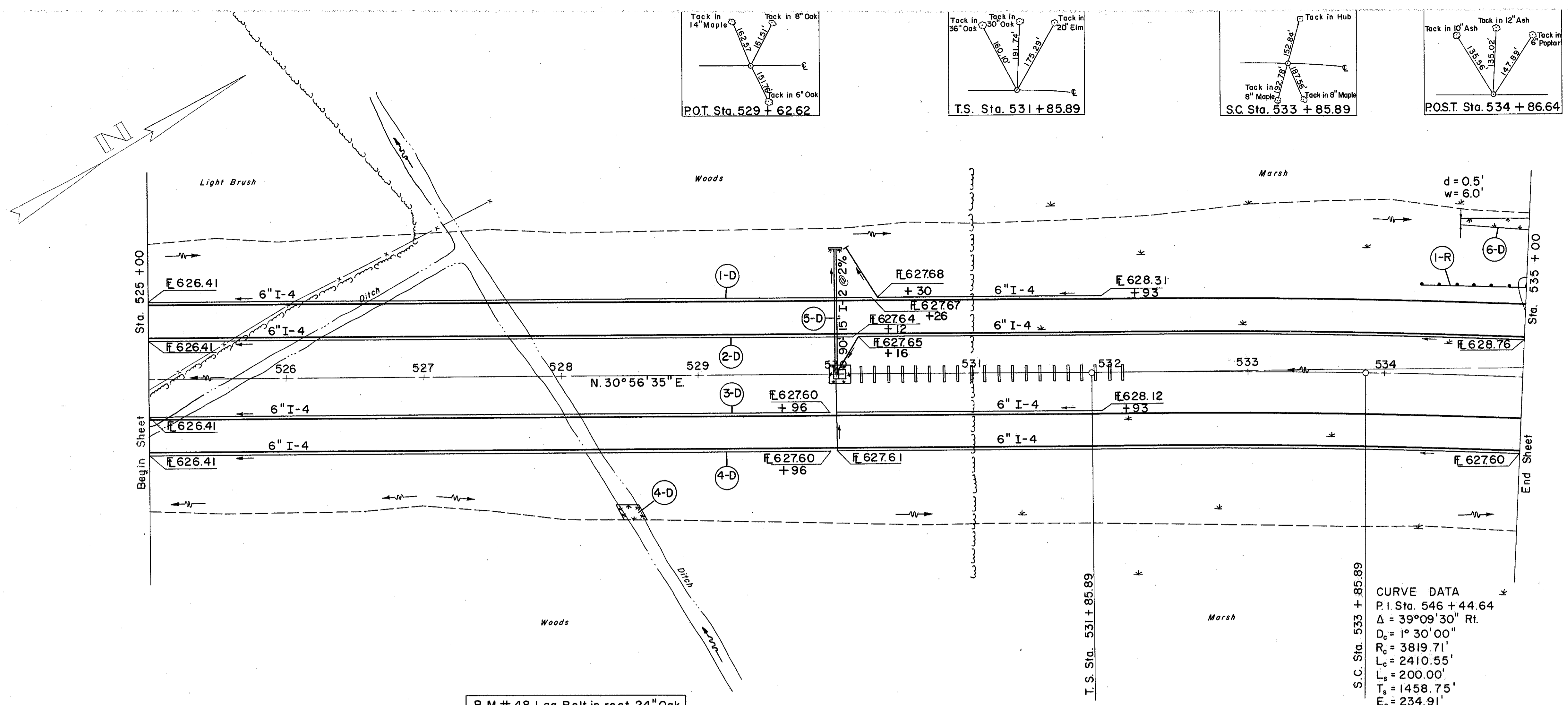

B.M. # 48 Lag Bolt in root 24" Oak  
 175' Rt. of Sta. 528+65  
 Elev. 625.545

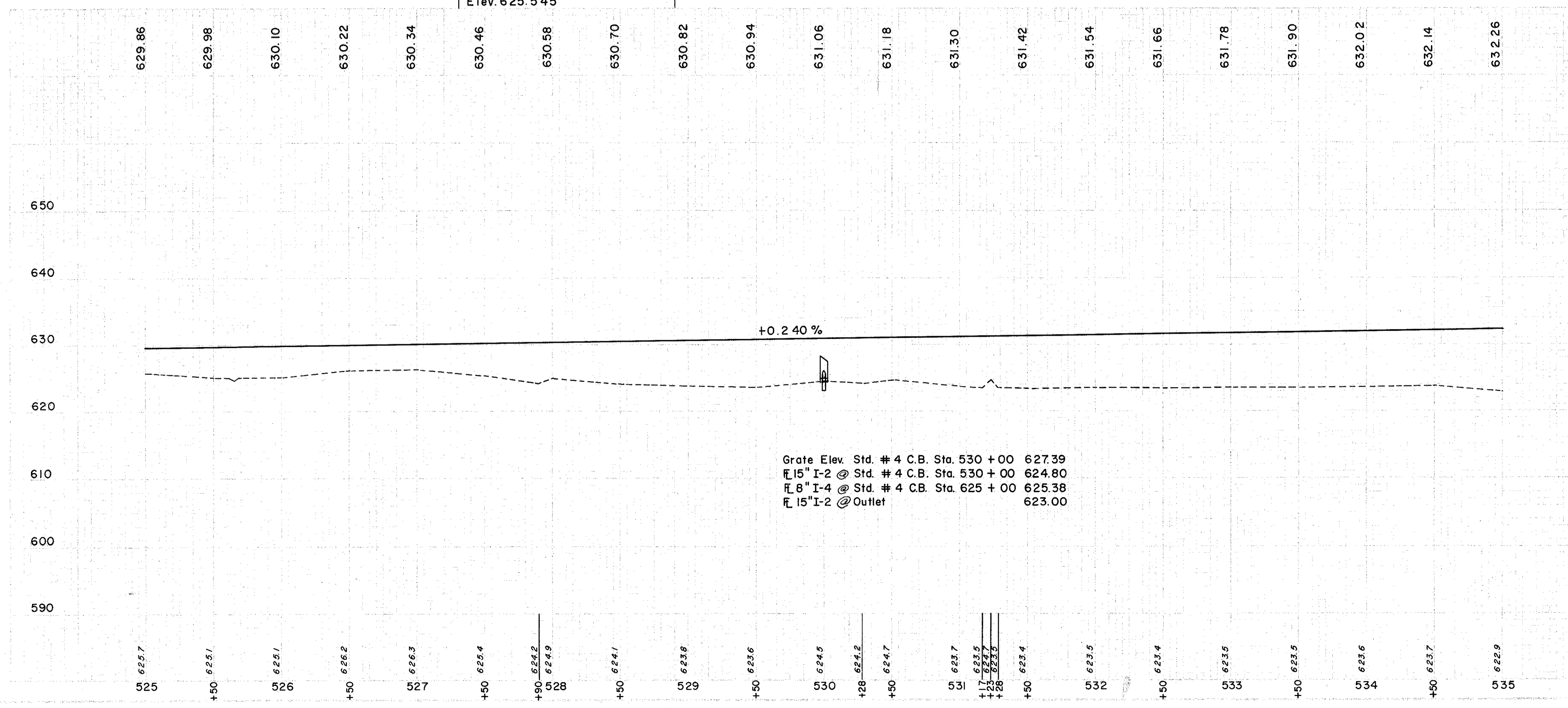

Grate Elev. Std. # 4 C.B. Sta. 530+00 627.39  
 15" I-2 @ Std. # 4 C.B. Sta. 530+00 624.80  
 8" I-4 @ Std. # 4 C.B. Sta. 625+00 625.38  
 15" I-2 @ Outlet 623.00

(D) DRAINAGE

REF. NO.	STATION	CLASS. STORM SWR UNDER PAVT SEC. M-68(b) OR M-6.5(b)	SIDEWALK	TO	FROM	8" OUTLET PIPE UNDER DRAIN		6" PIPE UNDER DRAIN		I-4	I-8	I-5	I-10
						SEC. M-64 (C) SHALLOW	SEC. M-64 (C)	SEC. M-64 (C) SHALLOW	SEC. M-64 (C)				
I-D	525+00	531+93	LT			724	10						
2-D	525+00	535+00	LT			1016	10						
3-D	525+00	531+93	RT			688							
4-D	525+00	535+00	RT		44	996							
5-D	530+00												
6-D	534+50	535+00	LT										

(R) ROADWAY

REF. NO.	STATION	TO	FROM	I-15 GUARD RAIL, STEEL SIDE BEAM, STD. TYPE (DEEP)	
				L.F.	L.T.
I-R	534+25	535+00	LT		75

EXCAVATION 1,225 C.Y.  
 EMBANKMENT 33,448 C.Y.  
 EMBANKMENT 20' 40,138 C.Y.