

LAKE COUNTY
LAK. - 2-1.80

QUANTITY CALCULATIONS
BY J. A.W. DATE 1/30/73
CHKD. K.N.M. DATE 1/31/73
F. A. THOMAS & ASSOC. INC.

* 706.D1CL.3, 706.02, 706.08 E.S. OR 707.13

UNDERDRAINS			
REF. N ^o	LOCATION	STATION	605
	L.B.E.	(50' INTERVALS)	90
TOTAL			90

ROADWAY			
REF. N ^o	LOCATION	STATION	604
IM	L.B.E.	2+03.39	1
TOTAL			1

STORM SEWER							
REF. N ^o	LOCATION	STATION		202	602	603	604
		FROM	TO	PIPE REMOVED 24" & UNDER	CONCRETE MASONRY	TYPE "C" CONDUIT 12"	STD. C.B. N ^o . 2-2B
1D	L.B. (E.)	1+40	3+00			160	1
2D	L.B. (E.)	3+00	4+20			120	1
3D	L.B. (E.)	4+20		0.20			
4D	L.B. (E.)	1+48	4+15	267			
TOTAL				267	0.20	280	2

WATER WORK		
	DESCRIPTION	QUANTITIES
IW	ADJUST WATER VALVE BOX TO GRADE	2
TOTAL		

NOTE:
FOR EXPANSION BOLT REFERENCE SEE
STANDARD DRAWING BP-3
PAYMENT UNDER ITEM 305

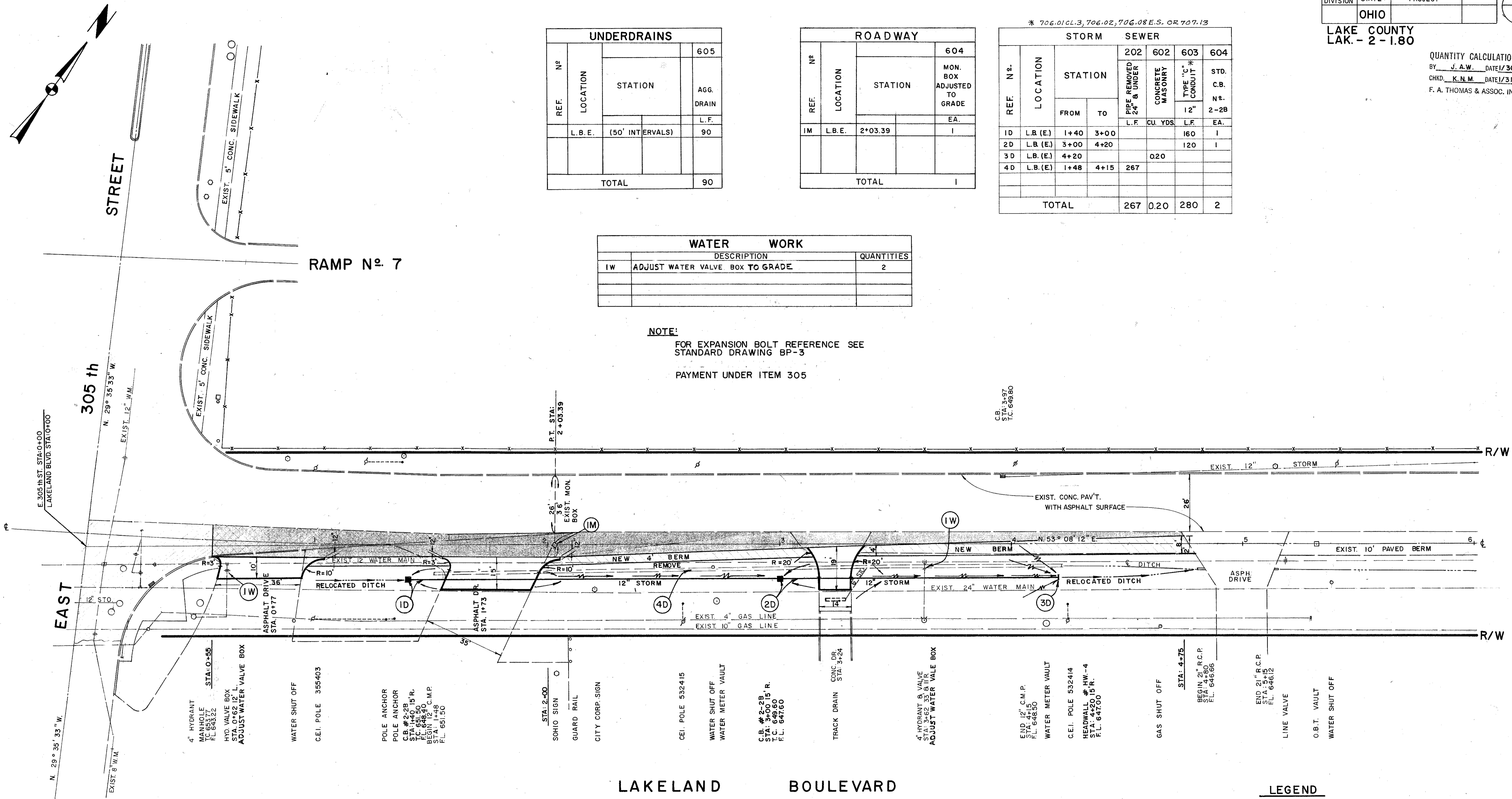

LEGEND

	NEW ASPH. CONC. PAVEMENT
	EXIST. CONC. PAVEMENT AND SIDEWALK TO BE REMOVED
	EXIST. CONC. PAVEMENT
	NEW PAVED BERM

LAKELAND BOULEVARD