

PHASING DIAGRAM

SIGNAL HEAD	phi 1				phi 2				FLASH	DWELL
	R/W	CLEAR	R/W	CLEAR	R/W	CLEAR	R/W	CLEAR		
A	G	G	Y	R	R	R	R	R	Y	G
B	G	G	Y	R	R	R	R	R	Y	G
C	R	R	R	R	G	G	Y	R	R	R
D	R	R	R	R	G	G	Y	R	R	R
E	G	G	Y	R	R	R	R	R	Y	G
F	G	G	Y	R	R	R	R	R	Y	G
G	R	R	R	R	G	G	Y	R	R	R
H	R	R	R	R	G	G	Y	R	R	R
X-X	W	FDW	DW	DW	DW	DW	DW	DW	OUT	DW
Y-Y	DW	DW	DW	DW	W	FDW	DW	DW	OUT	DW
Z-Z	W	FDW	DW	DW	DW	DW	DW	DW	OUT	DW

SIGNAL SEQUENCE CHART

FUNCTION	phi 1	phi 2
INITIAL GREEN	-	7.0
MINIMUM GREEN	30.0	-
VEHICLE EXTENSION	-	3.0
MAXIMUM GREEN	-	25.0
PEDESTRIAN WALK	7.0	7.0
PEDESTRIAN CLEARANCE	13.0	15.0
VEHICLE YELLOW CLEARANCE	3.0	3.0
VEHICLE ALL RED CLEARANCE	1.0	1.0
RE CALL	ON	OFF
MEMORY	NO	NO

SIGNAL TIMING CHART

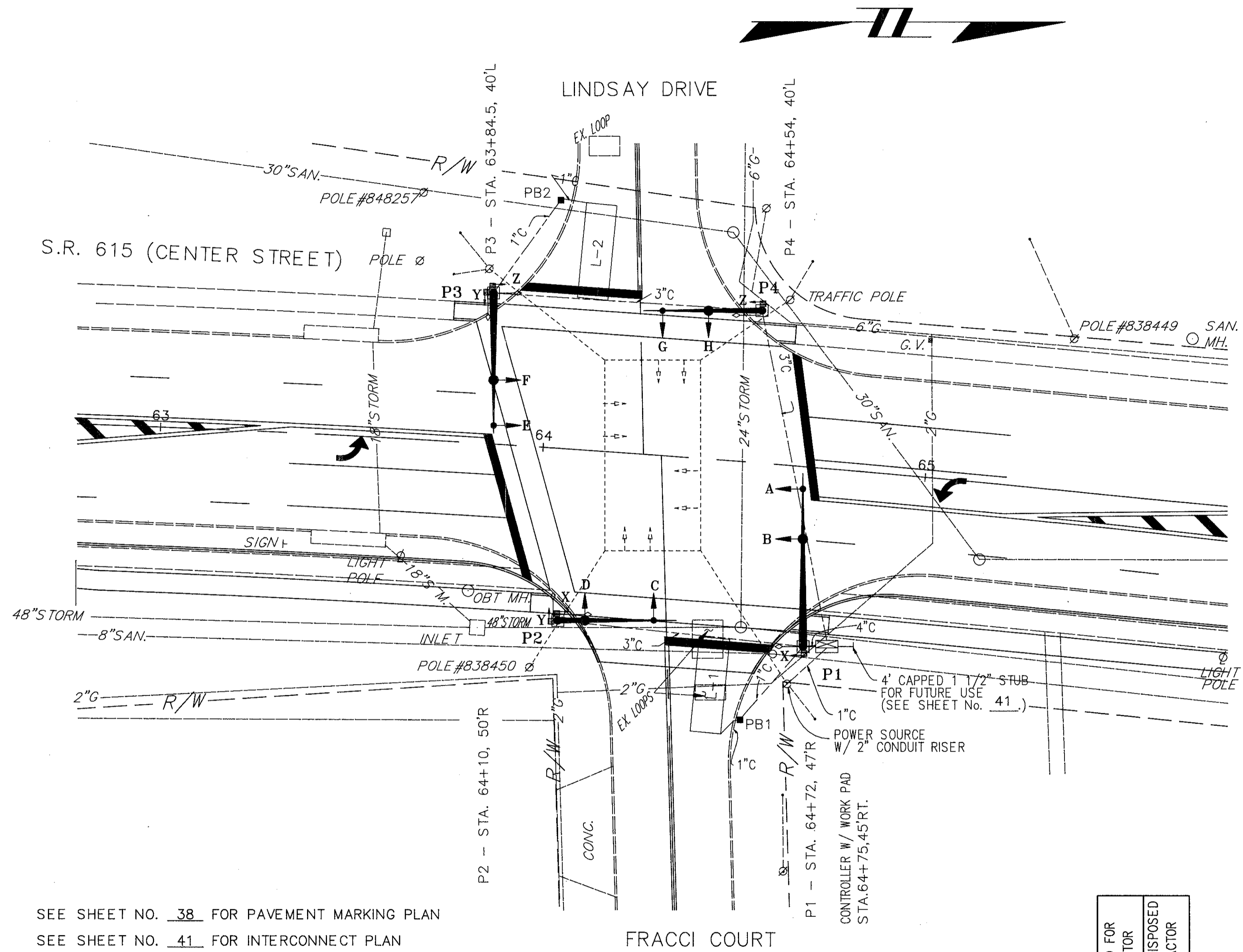

SEE SHEET NO. 38 FOR PAVEMENT MARKING PLAN
 SEE SHEET NO. 41 FOR INTERCONNECT PLAN
 SEE SHEET NO. 33 FOR TRAFFIC CONTROL GENERAL SUMMARY
 SEE SHEET NO. 24 FOR CURB RAMPS CALL OUT

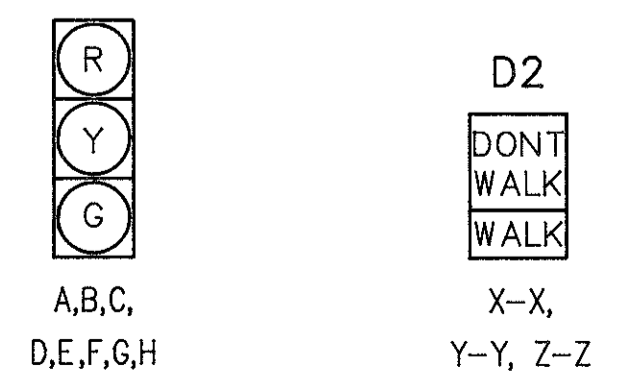

12" SIGNAL HEADS

LOOP	SIZE	TURNS	MODE	DELAY	PHASE	REMARK	INHIBITED DELAY	LOCATION 1st FRONT CORNER	LOCATION 2nd FRONT CORNER
L-1	8X25	2	PRESENCE	7.0	phi 2		phi 2	STA. 64+37, 46'R	STA. 64+45, 46'R
L-2	8X25	2	PRESENCE	7.0	phi 2		phi 2	STA. 64+06, 40'L	STA. 64+14, 40'L

LOOP DETECTOR CHART

	ITEMS STORED FOR CITY OF MENTOR	ITEMS TO BE DISPOSED OF BY CONTRACTOR
CONTROLLER	1	
VEHICULAR SIGNAL HEADS	8	
WOOD POLES		3

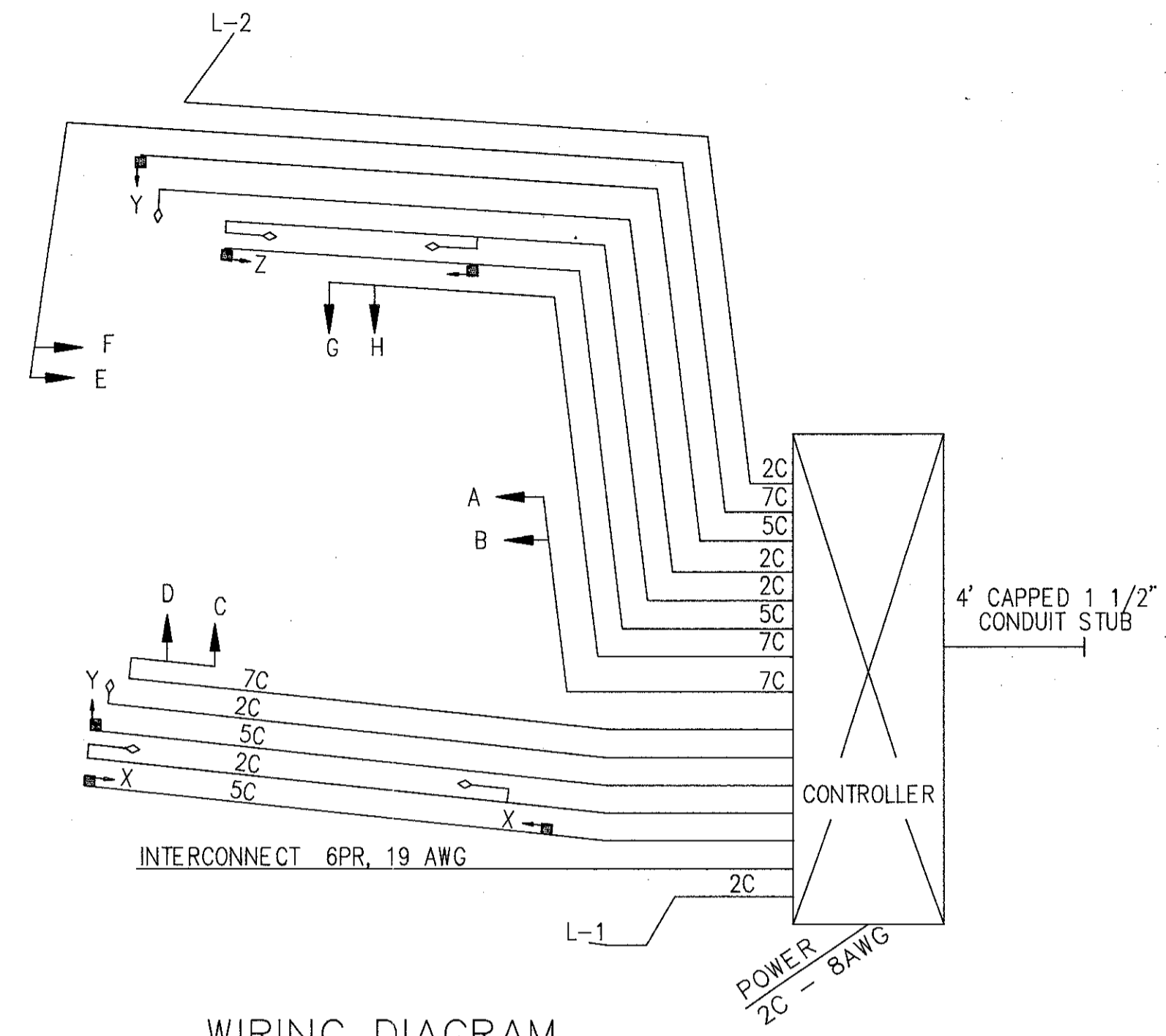

WIRING DIAGRAM

SUB SUMMARY				
ITEM	ITEM EXT.	DESCRIPTION	UNIT	QTY
625		GROUND ROD	EACH	5
625		PULL BOX, 713.08, 18"	EACH	2
625		TRENCH	LN FT	109
625		TRENCH IN PAVED AREAS, TYPE B	LN FT	182
625		CONDUIT, 1", 713.07, TYPE DB	LN FT	78
625		CONDUIT, 3", 713.07, TYPE EB	LN FT	205
625		CONDUIT, 4", 713.07, TYPE DB	LN FT	5
632		VEHICULAR SIGNAL HEADS, 3-SECTION, 12" LENS, 1-WAY, AS PER PLAN	EACH	8
632		PEDESTRIAN SIGNAL HEAD, TYPE D2, AS PER PLAN	EACH	6
632		PEDESTRIAN PUSHBUTTON	EACH	6
632		LOOP DETECTOR UNIT, DELAY+EXTEND, AS PER PLAN	EACH	2
632		LOOP DETECTOR PAVEMENT CUTTING	LN FT	138
632		CONCRETE FOR ANCHOR BASE FOUNDATION	CU YDS	7.29
632		SIGNAL SUPPORT, TYPE TC-81.20, DESIGN No. 1, W/ 25' ARM	EACH	1
632		SIGNAL SUPPORT, TYPE TC-81.20, DESIGN No. 2, W/ 27' ARM	EACH	1
632		SIGNAL SUPPORT, TYPE TC-81.20, DESIGN No. 3, W/ 36' ARM	EACH	1
632		SIGNAL SUPPORT, TYPE TC-81.20, DESIGN No. 11, W/ 41' ARM	EACH	1
632		CONDUIT RISER, 2" DIA.	EACH	1
632		CABLE SUPPORT ASSEMBLY	EACH	4
632		SIGNAL CABLE, 2-CONDUCTOR, 14 AWG	LN FT	523
632		SIGNAL CABLE, 5-CONDUCTOR, 14 AWG	LN FT	281
632		SIGNAL CABLE, 7-CONDUCTOR, 14 AWG	LN FT	1088
632		LOOP DETECTOR WIRE, TYPE E	LN FT	286
632		LOOP DETECTOR LEAD-IN CABLE	LN FT	217
632		POWER CABLE, 2-CONDUCTOR, 8 AWG	LN FT	60
632		POWER SERVICE	EACH	1
632		COVERING OF SIGNAL HEADS	EACH	8
632		REMOVAL OF TRAFFIC INSTALLATION	EACH	1
633		CONTROLLER, 4 PHASE, SOLID STATE, DIGITAL, MICROPROCESSOR, AS PER PLAN	EACH	1
633		COORDINATOR, MULTI-DIAL, SOLID STATE, DIGITAL MICROPROCESSOR, SECONDARY	EACH	1
633		CONCRETE FOR CABINET FOUNDATION	CU YDS	1
633		CONTROLLER WORK PAD	SQ FT	8.3