

LAKE COUNTY
LAK. - 2-0.01

COMPUTED BY: W.J.B.
CHECKED BY: G.M.B.

CLAKELAND CURVE DATA
 $\Delta = 1^{\circ}54'05.95''$
 $D = 0^{\circ}20'$
 $L = 570.496'$
 $R = 17,188.734'$
 $T = 285.273'$
 $C = 570.470'$
 $E = 2.365'$

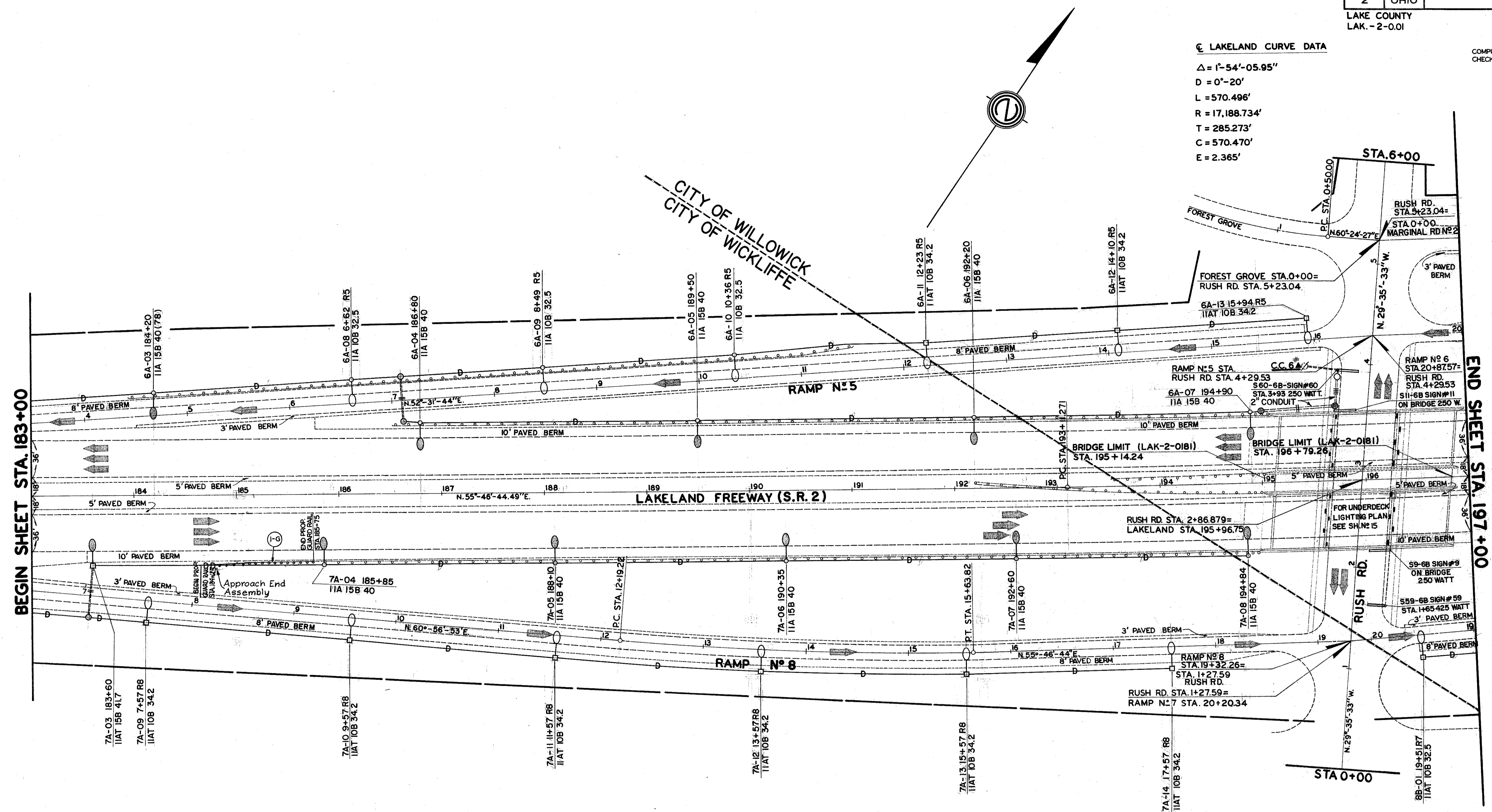

REF. NO.		STATION		SIDE	GUARD RAIL			
FROM	TO	606	202		606	625	TRENCH	
					GUARD RAIL TYPE 5	GUARD RAIL REMOVED & DISCARDED	Approach End Assembly	4'-8" DEEP
					LIN. FT.	LIN. FT.	EACH	LIN. FT.
I-G	185+00	184+425	RT.	112.5	25	1		
	183+60	185+85						225
		TOTALS			112.5	25	1	225