

FED. RD. DIVISION	STATE	PROJECT	FISCAL YEAR
2	OHIO		

120
394

LAKE COUNTY
LAK-2 - 0.00
LIMITED ACCESS

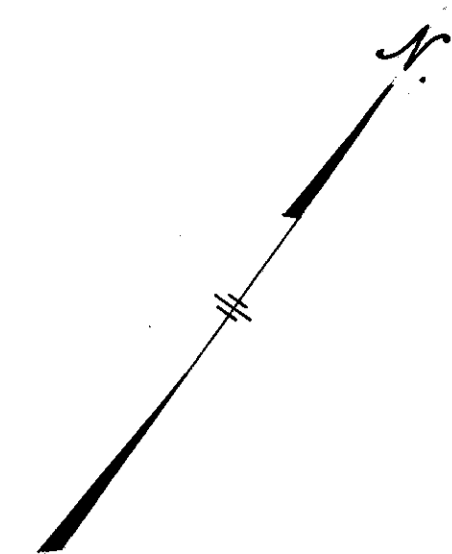

LAKELAND - WORDEN Subdivision N^o 2
Rec. Vol. J - Page 110.

TRUMAN AVE. 50'

Accepted by WICKLIFFE CITY Resolution N^o 1956-11

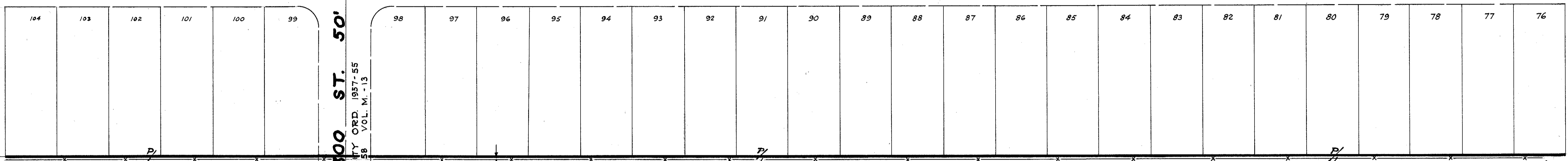

EAST 300 ST. 50'
VACATED CITY ORD. 1957-55
1-15-58 VOL. M. 13

P.T. STA. 161+71.221

P.C. STA. 176+53.787

3319 LA
305 CORPORATION
27.65 AC. (TOTAL)

LAKELAND FREEWAY

3319 LA
305 CORPORATION

EXISTING LAKELAND BLVD. 80'

2965 LIN. FT. SS-18 FENCE TYPE "C"

Scale: 1" = 50'

RIGHT-OF-WAY PLANS STA. 161+71.221 TO 176+53.787