

LAK-2-0.00

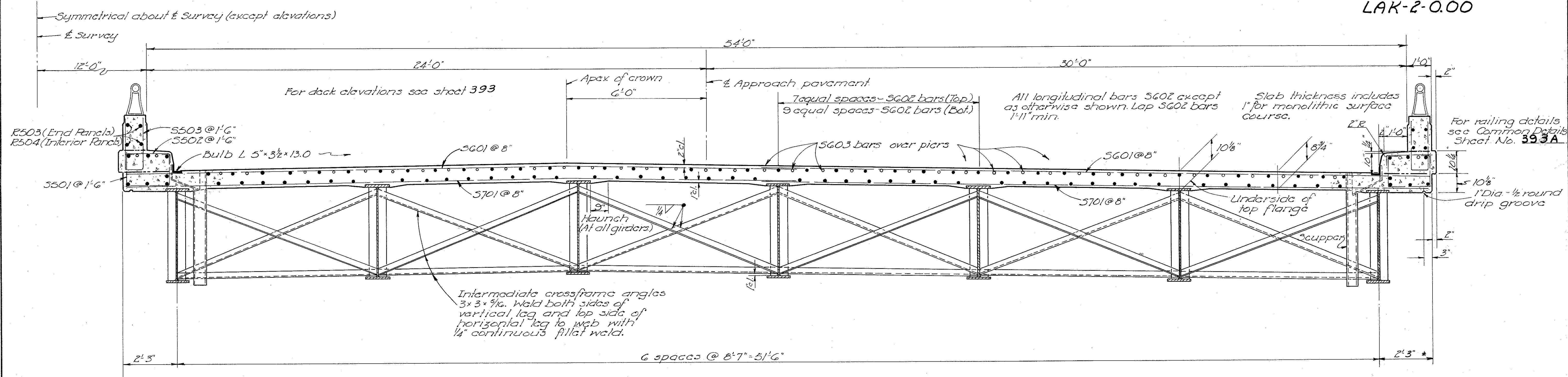

HALF TRANSVERSE SECTION AT STA. 312+75.00
(East-bound lane shown)

*Varies rearward of P.T. on Westbound lanes only.

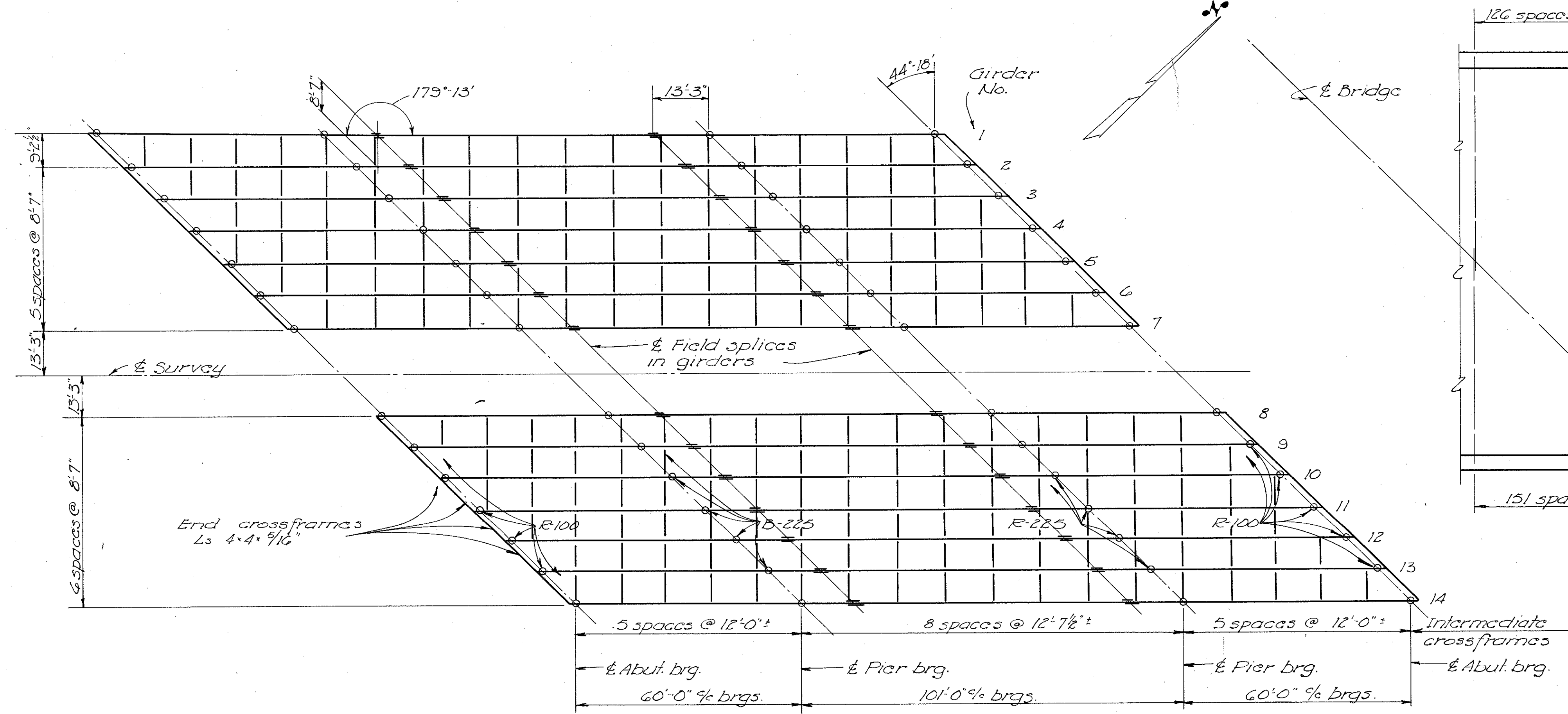

STEEL FRAMING PLAN

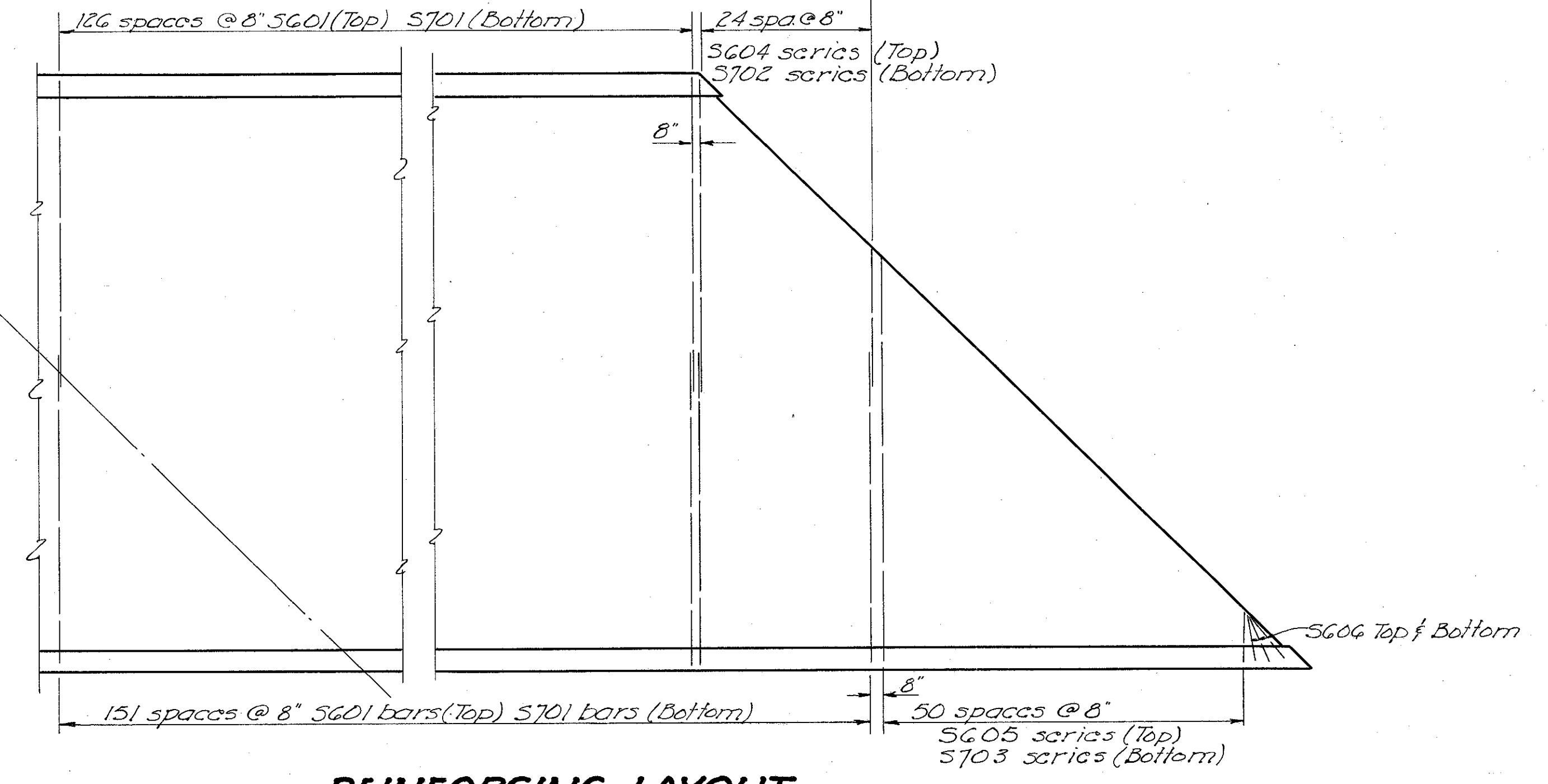

REINFORCING LAYOUT

STATE OF OHIO
DEPARTMENT OF HIGHWAYS
DIVISION OF DESIGN AND CONSTRUCTION
BUREAU OF BRIDGES

SUPERSTRUCTURE DETAILS
BRIDGE NO. LAK-2-0401/EP
OVER VINE STREET

LAKE COUNTY STA. 310+54.21
STA. 312+82.13

DESIGNED	DRAWN	TRACED	CHECKED	REVIEWED	DATE	REVISED
RHN	RHN	Ricc	Ray	BFG	12-31-58	