

LAK-2-0.00

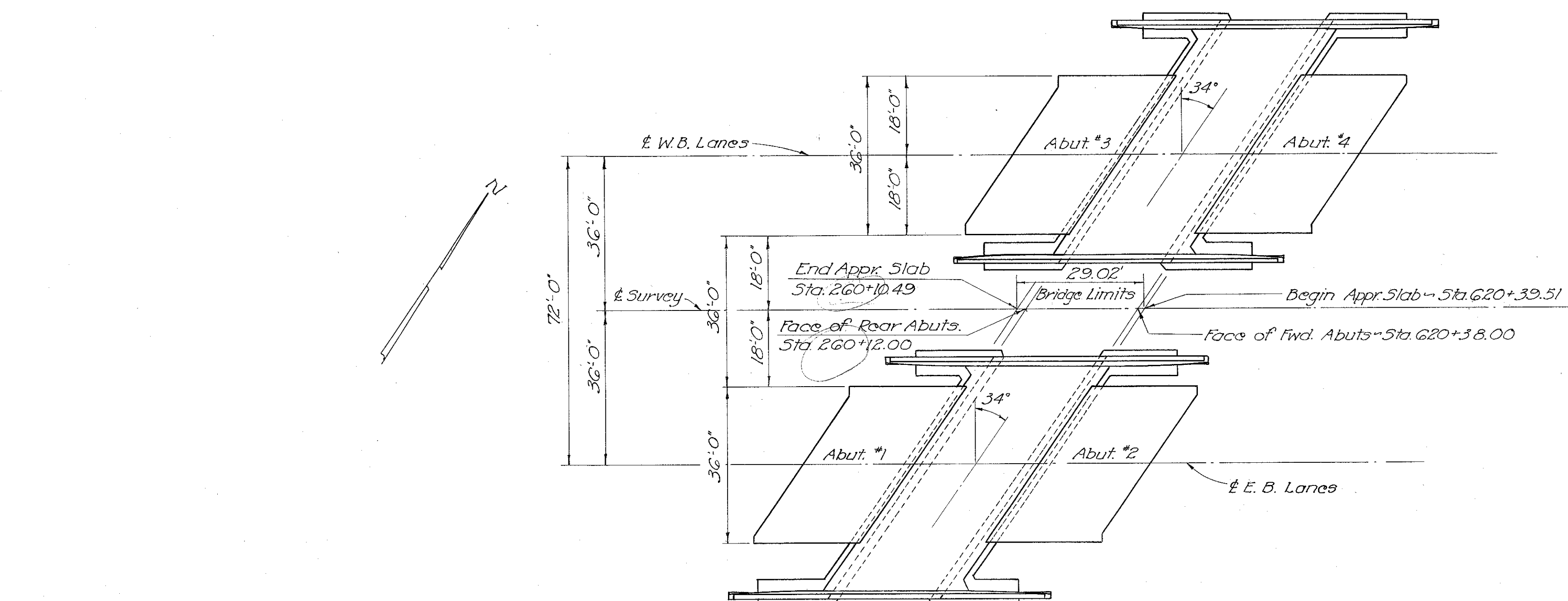

SCHEMATIC DIAGRAM

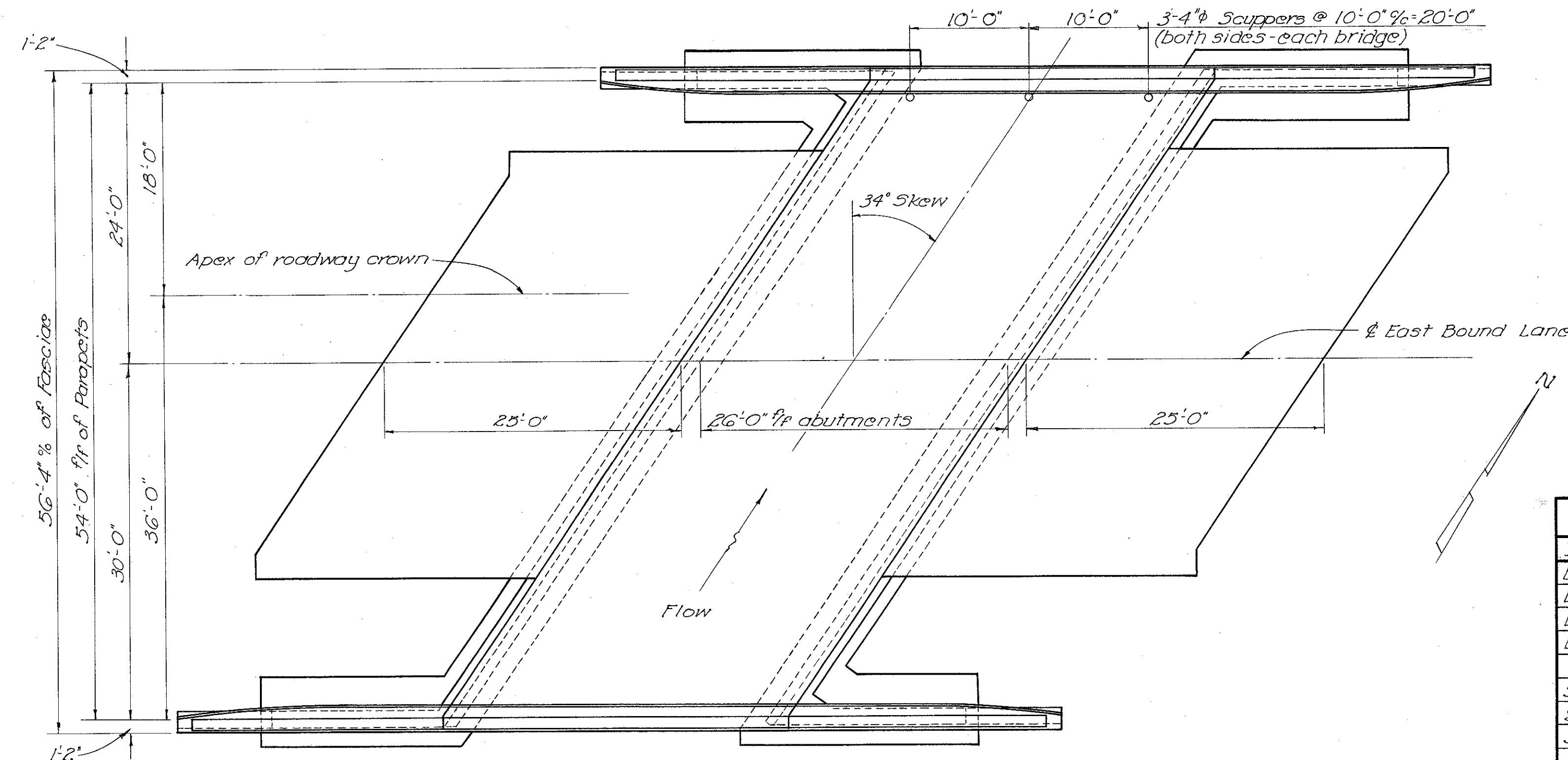

GENERAL PLAN (EAST BOUND BRIDGE SHOWN)

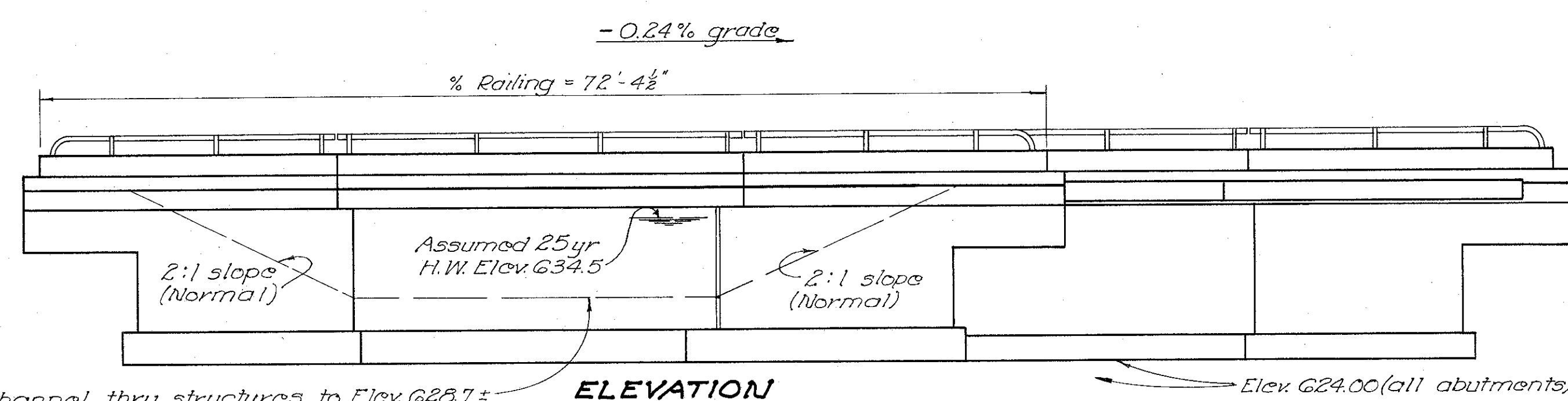

ELEVATION

GENERAL NOTES

**DESIGN SPECIFICATIONS:** This structure conforms to the requirements of "Design Specifications for Highway Structures" of the State of Ohio, Department of Highways, dated 9-1-57.

**FOUNDATION BEARING PRESSURE:** Abutment footings are designed for a maximum bearing pressure of 2.75 tons per sq. ft.

**CAMBER** of  $\frac{1}{8}$ " at  $\frac{1}{4}$ " of the span shall be provided to allow for dead load deflection. This is the amount of camber required before falsework is released. To obtain this, proper allowance shall be made for the deflection of the falsework members.

**CURBS** shall be placed after the shoring under the slab has been released sufficiently to permit the span to attain full dead load deflection.

**FOOTINGS** shall extend a minimum of 3' into solid shale or to the elevation shown, whichever is lower.

Revised As-Built

ESTIMATED QUANTITIES

Item	Total	Unit	Description	Superstr.	Abuts.	Gen'l.	As Built
E-2	Lump	Sum	Cofferdams, cribs and sheeting			Lump	
E-2	670	CuYd.	Unclassified excavation		670		
E-2	48	CuYd.	Shale excavation		48		60-1 +121 169
E-3	700	CuYd.	Channel excavation			700	60-1 -138 262
S-1	196	CuYd.	Class "C" concrete, superstructure	196			
S-1	281	CuYd.	Class "E" concrete, abutment walls		281		
S-1	175	CuYd.	Class "E" concrete, abutment footings		175		
S-4	63,506	Lb.	Reinforcing steel	43,589	19,917		
S-14	289.50	Lin.Ft.	Railing (aluminum rail and supports and concrete parapet)	289.50			
S-29	180	CuYd.	Porous backfill		180		
S-29	12	Each	Scuppers (4" cast iron or wrought iron pipe)	12			
S-3	73	Lin.Ft.	Waterproofing, premolded sealing strip		73		

STATE OF OHIO  
DEPARTMENT OF HIGHWAYS  
DIVISION OF DESIGN AND CONSTRUCTION  
BUREAU OF BRIDGES

GENERAL PLAN & ELEVATION, NOTES  
& ESTIMATED QUANTITIES  
BRIDGE No. LAK-2-0304 L & R  
LAKE COUNTY  
LAKE COUNTY

STA. 260+10.49  
STA. 260+39.51

DESIGNED	DRAWN	TRACED	CHECKED	REVIEWED	DATE	REVISED
OPM	ECE	R.H.D.	MPB	BFG	9/27/57	2-27-59

Revised As-Built VLA-6-11-63