

MICROFILMED
SEP 18 1986

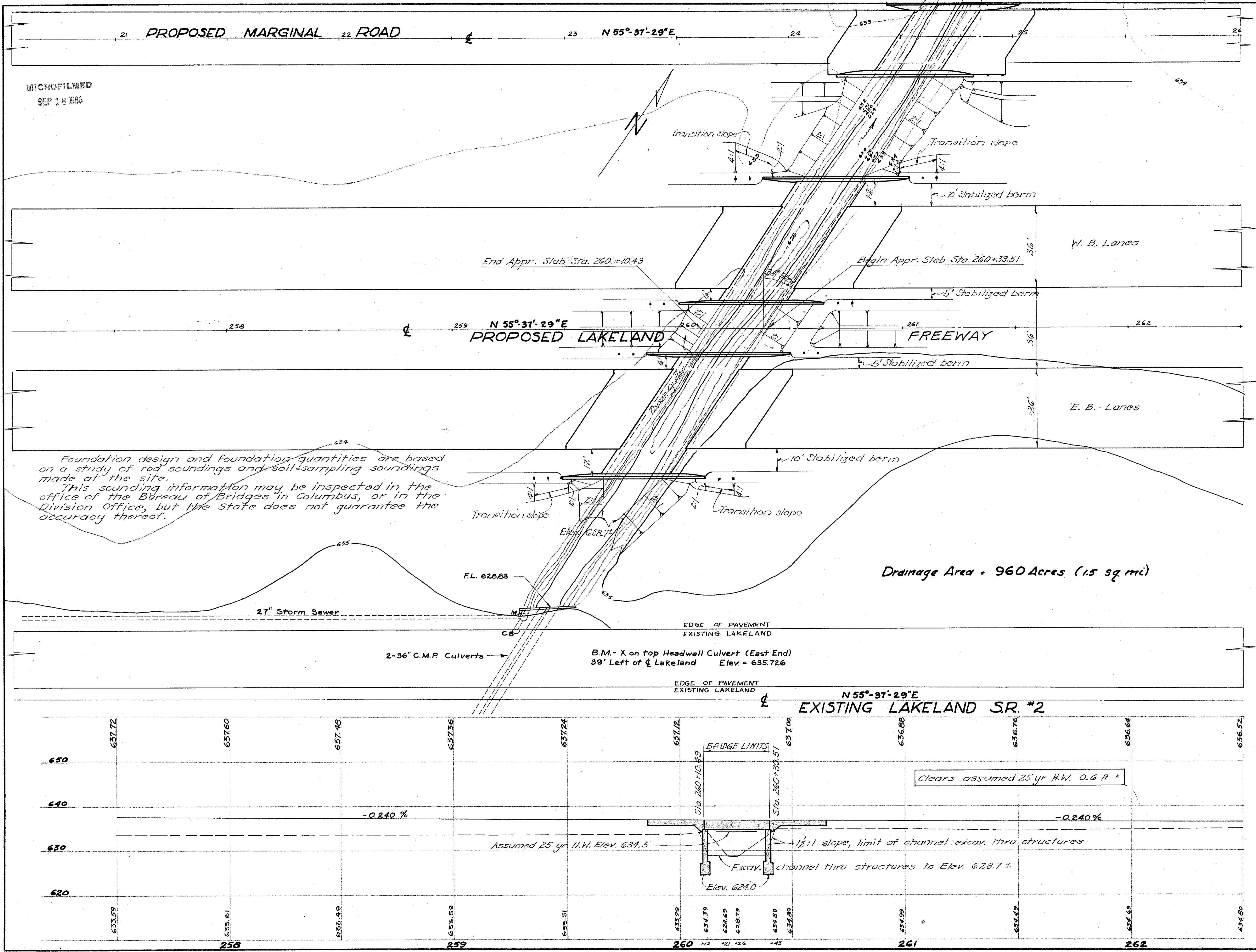

Foundation design and foundation quantities are based on a study of rod soundings and soil-sampling soundings made at the site. This sounding information may be inspected in the office of the Bureau of Bridges in Columbus, or in the Division Office, but the State does not guarantee the accuracy thereof.

Drainage Area - 960 Acres (1.5 sq mi)

PROPOSED STRUCTURE
 Type: Single span reinf. concrete slab with reinf. concrete substructure
 Span: 26 ft. face to face of abutments
 Roadway: Two - 36 ft. face to face of parapet rails.
 Load Frequency: CF=2000 (57) (Adequate for A.A.S.H.O. alternate loading)
 Skew: 34° L.F.
 Wearing Surface: 1" Monolithic concrete
 Approach Slabs: AS-1-54 (25' long)
 Alignment: Tangent

STATE OF OHIO DEPARTMENT OF HIGHWAYS BUREAU OF BRIDGES				
SITE PLAN				
Bridge No		LAK-2-0304 L&R		
SECTION		LAKELAND FREEWAY		
		Sta. 260+10.49	Sta. 260+39.51	
		Lake County		
Scale: 1" = 20'				
TOPOGRAPHY	DESIGN	DR. BY	CHKD	REVIEWED
	J.R.P.	J.R.P.	B.D.H.	P.E.S.
SURVEY	DR. BY	DATE		
		2-27-59		