

B.M. "X" on S.E. corner headwall culvert. Sta. 125+28 - 40' South of ϕ Lakeland.
B.M. "X" on N.E. corner, top headwall culvert. Sta. 142+80 - 40' North of ϕ Lakeland.

MICROFILMED
SEP 18 1986

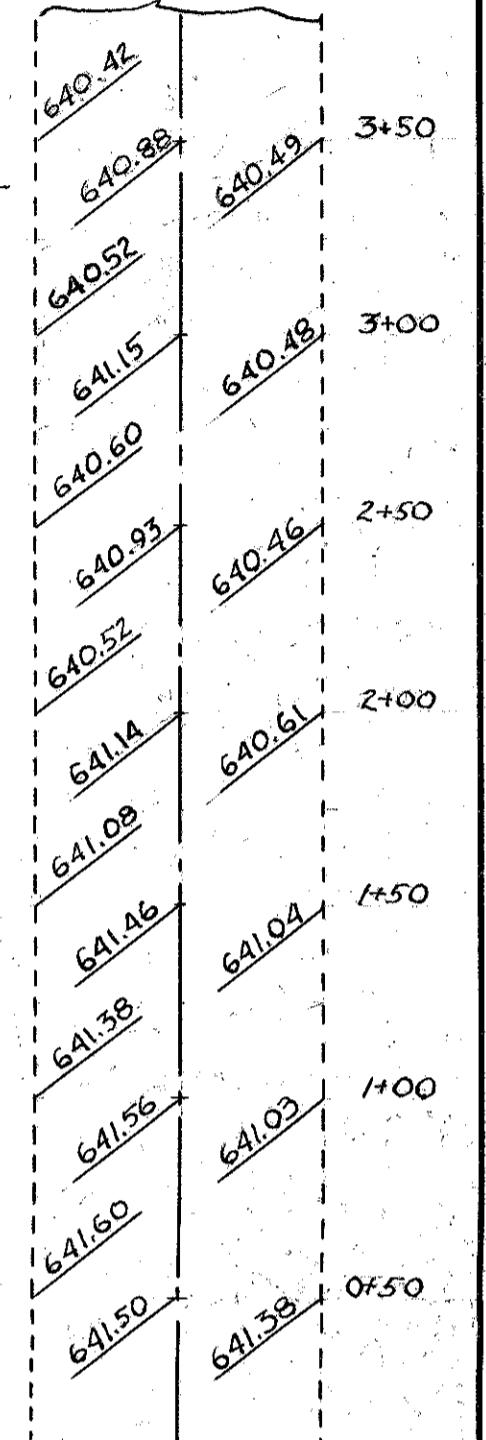
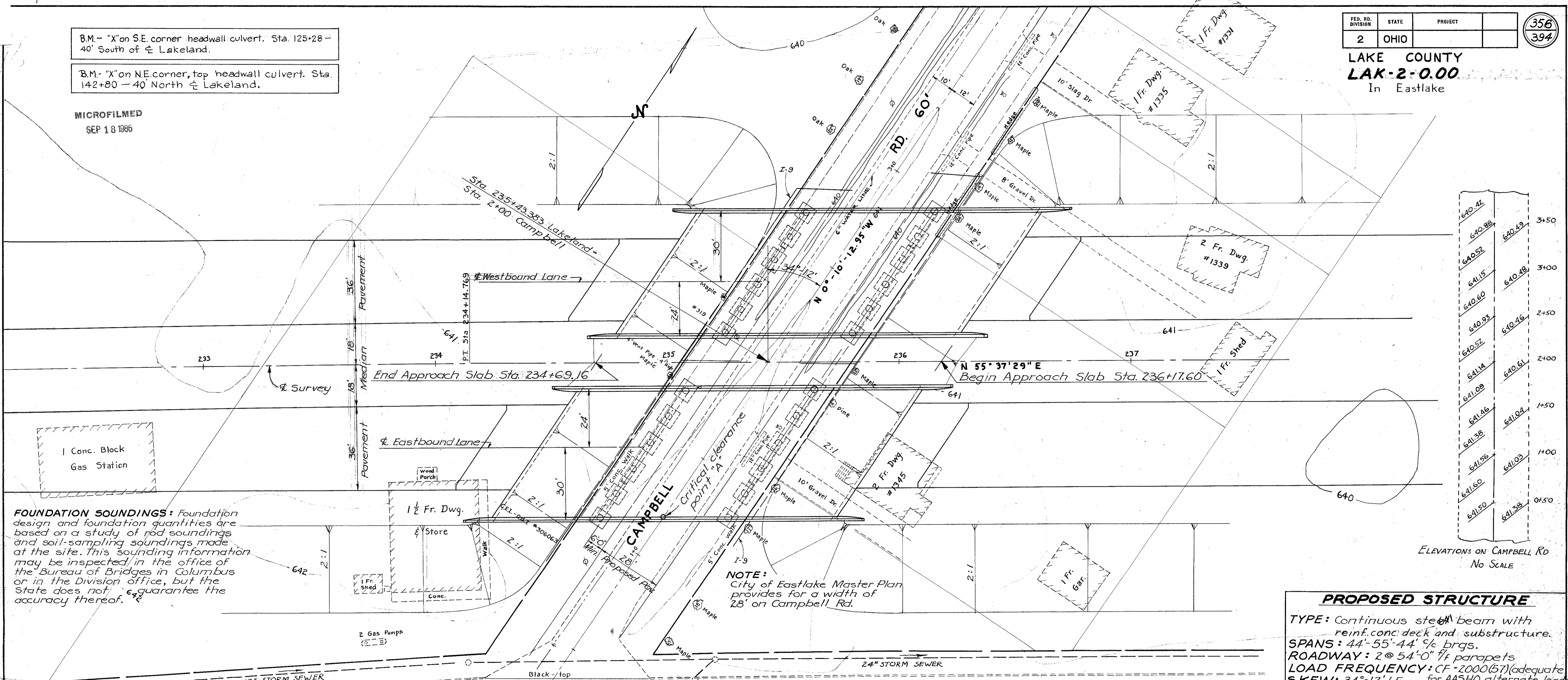

ELEVATIONS ON CAMPBELL RD
No SCALE

FOUNDATION SOUNDINGS: Foundation design and foundation quantities are based on a study of rod soundings and soil-sampling soundings made at the site. This sounding information may be inspected in the office of the Bureau of Bridges in Columbus or in the Division office, but the State does not guarantee the accuracy thereof.

NOTE: City of Eastlake Master Plan provides for a width of 28' on Campbell Rd.

PROPOSED STRUCTURE
TYPE: Continuous steel beam with reinf. conc. deck and substructure.
SPANS: 44'-55'-44' % brgs.
ROADWAY: 2 @ 54'-0" ff parapets
LOAD FREQUENCY: CF-2000(57) (adequate)
SKEW: 34'-12' LF for AASHO alternate loading
WEARING SURF: 1" monolithic concrete
APPROACH SLABS: AS-1-54 (25' long)
ALIGNMENT: Tangent

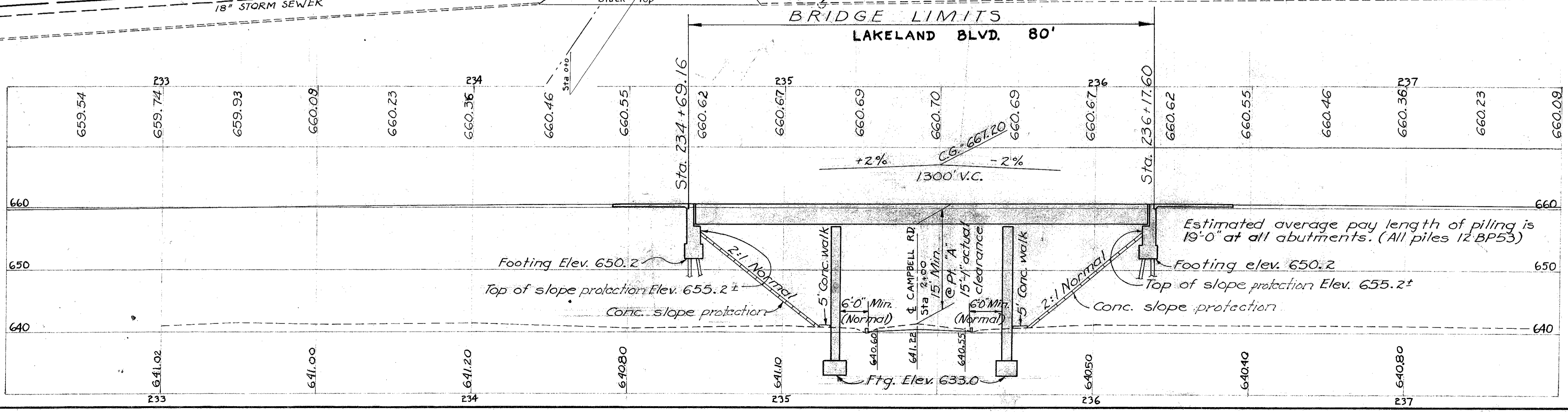

Revised 12-9-58

STATE OF OHIO
DEPARTMENT OF HIGHWAYS
BUREAU OF BRIDGES

SITE PLAN
 Bridge No LAK-2-0255 L & R
 OVER CAMPBELL ROAD
 LAKELAND - CAMPBELL RD. BRIDGE
 Sta. 234+69.16
 Sta. 236+17.60
 Scale 1"=20'

TOPOGRAPHY	DESIGN	PROPOSED WORK
SURVEY DR. BY	DR. BY	DR. BY
	RHN	RHN B.D.H. P.E. J.