

MICROFILMED  
SEP 17 1986

FED. RD. DIVISION	STATE	PROJECT
2	OHIO	

338  
394

LAKE COUNTY  
LAK-2-0.00  
In Wickliffe

BM. - D.H. in 'X', S.W. corner entrance 1st step into Cities Service Station #29906 Lakeland @ S.E. corner Worden-Lakeland.

DESIGN SPEED: 60 MPH  
SUPER ELEVATION = .024 FT./FT.

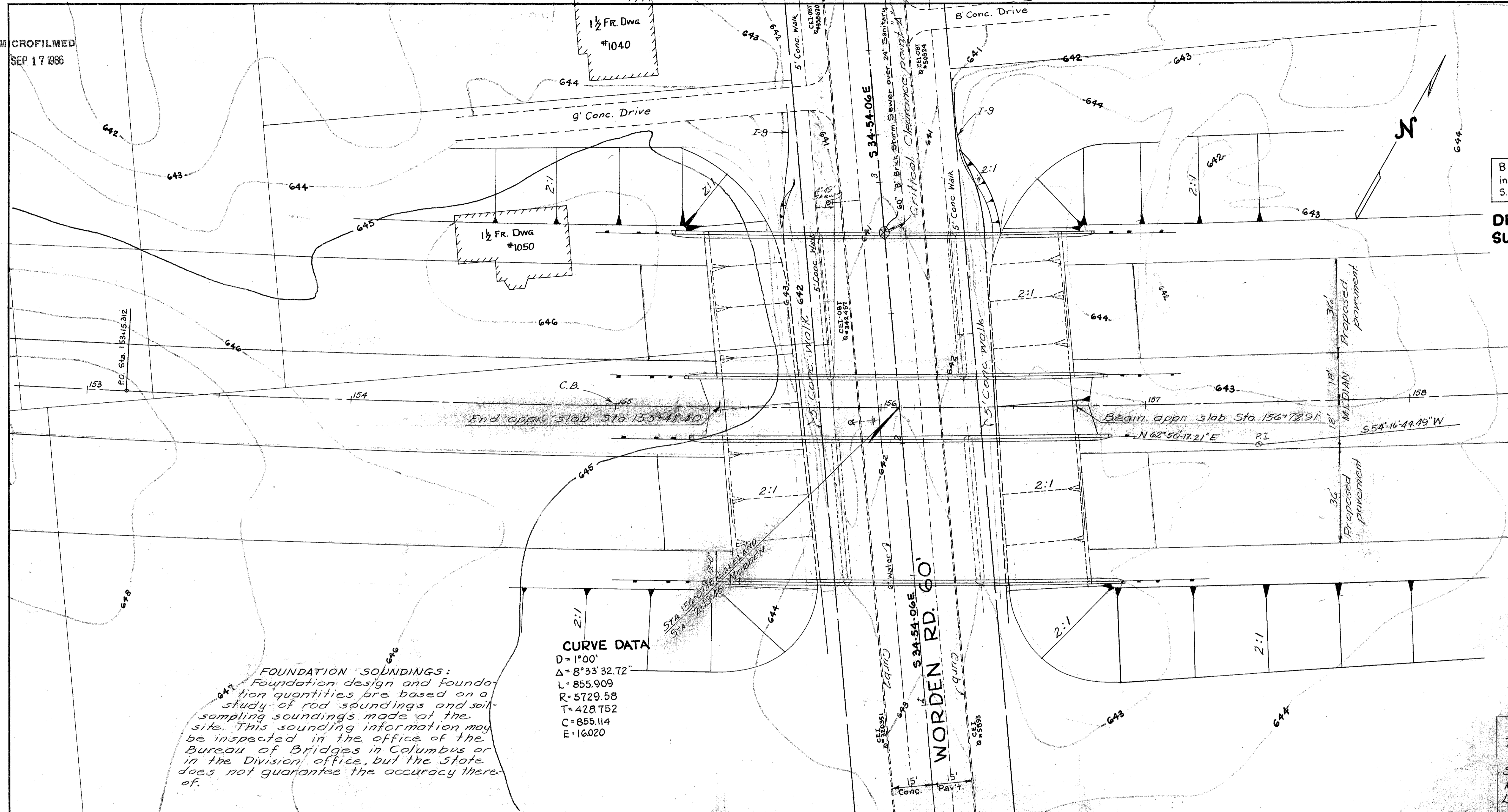

**FOUNDATION SOUNDINGS:**  
Foundation design and Foundation quantities are based on a study of rod soundings and soil sampling soundings made at the site. This sounding information may be inspected in the office of the Bureau of Bridges in Columbus or in the Division office, but the State does not guarantee the accuracy thereof.

**CURVE DATA**  
D = 1°00'  
Δ = 8°33'32.72"  
L = 855.909  
R = 5729.58  
T = 428.752  
C = 855.114  
E = 16.020

639.63	639.99
639.98	639.99
640.06	639.99
640.41	639.99
640.59	640.54
640.91	640.54
641.14	641.14
641.51	641.14
641.69	641.14
642.15	641.70
642.30	642.19
642.72	642.70
642.85	642.70
643.09	642.70
643.29	643.37
643.57	643.37

EXISTING WORDEN ROAD

**PROPOSED STRUCTURE**  
TYPE: Continuous reinf. conc. slab with reinf. conc. substructure  
SPANS: 40'-50'-40' brgs.  
ROADWAY: Two @ 54'-0" ft. of parapet.  
LOAD FREQUENCY: C.F. 2000 (57)  
(Adequate for AASHO Alternate Ldg.)  
SKEW: 4-19 Right forward.  
WEARING SURFACE: 1" Monolithic conc.  
APPROACH SLABS: 45'-1.54' (25' long)  
ALIGNMENT: 1°00' curve left  
SUPER ELEVATION: 0.024 ft. per ft.

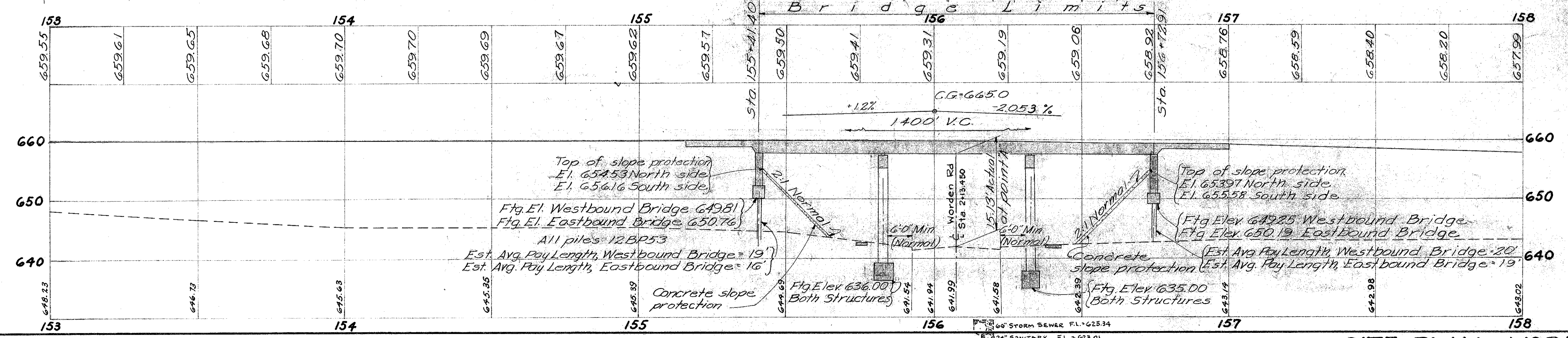

STATE OF OHIO DEPARTMENT OF HIGHWAYS BUREAU OF BRIDGES	
<b>SITE PLAN</b>	
Bridge No. LAK-2-0105 L&R	
SECTION LAK-OVER WORDEN RD	
WORDEN RD. - LAKELAND BRIDGE	
SCALE 1"=20'	
TOPOGRAPHY	PROPOSED WORK
SURVEY DR. BY	DR. BY
	J.H.B. J.C.P. G.E.S.
	DATE
	11-26-58

SITE PLAN - WORDEN RD. - LAKELAND BRIDGE