

LAKE COUNTY  
LAK. -2 - 0.00

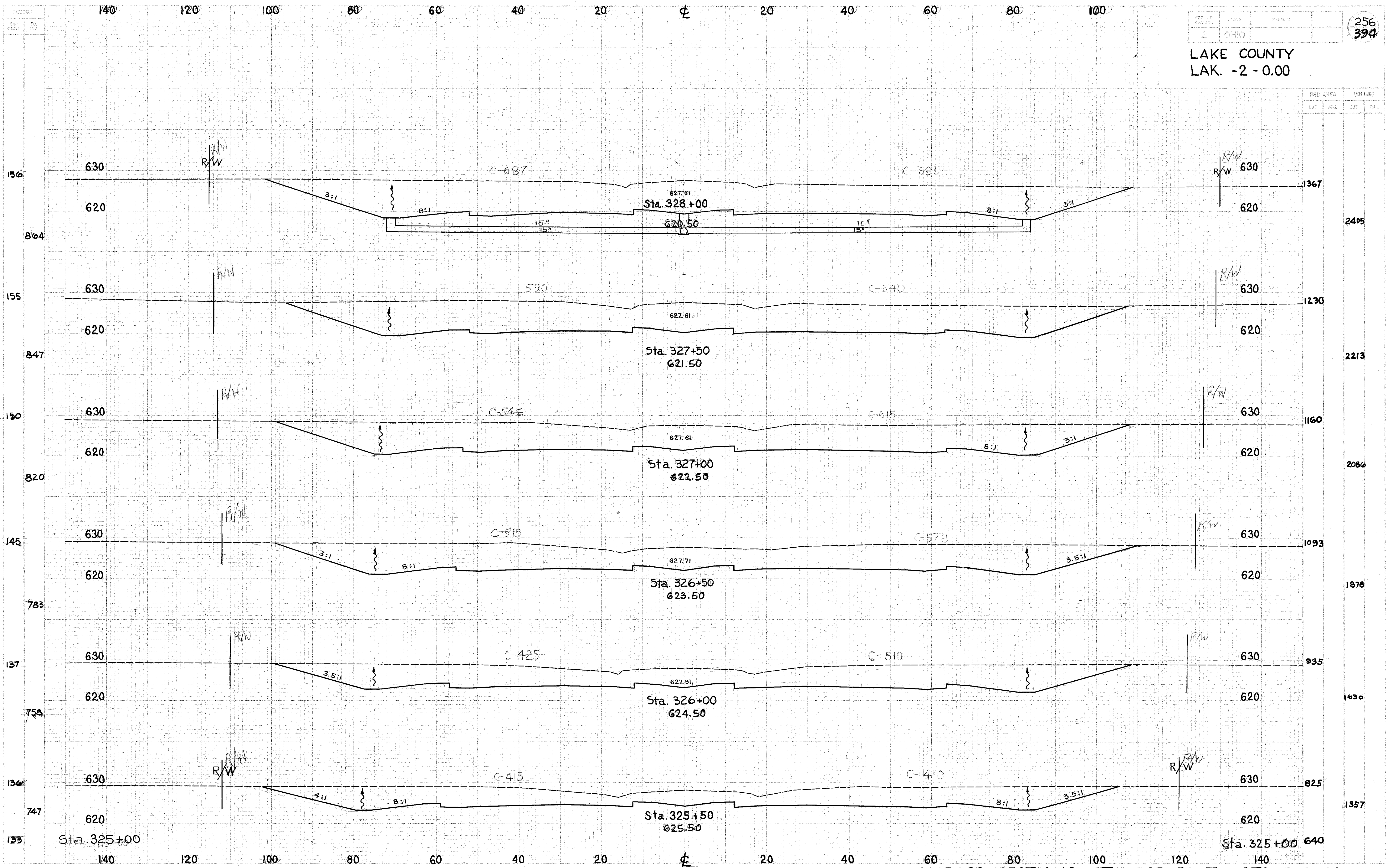

END AREA		VOLUME	
CUY	FRS	CUY	FRS

1367	2405	1230	2213	1160	2086	1093	1878	935	1430	825	1357
------	------	------	------	------	------	------	------	-----	------	-----	------

CROSS SECTIONS STA. 325+50 TO STA. 328+00