

LAKE COUNTY
LAK.-2- 0.00

242
394

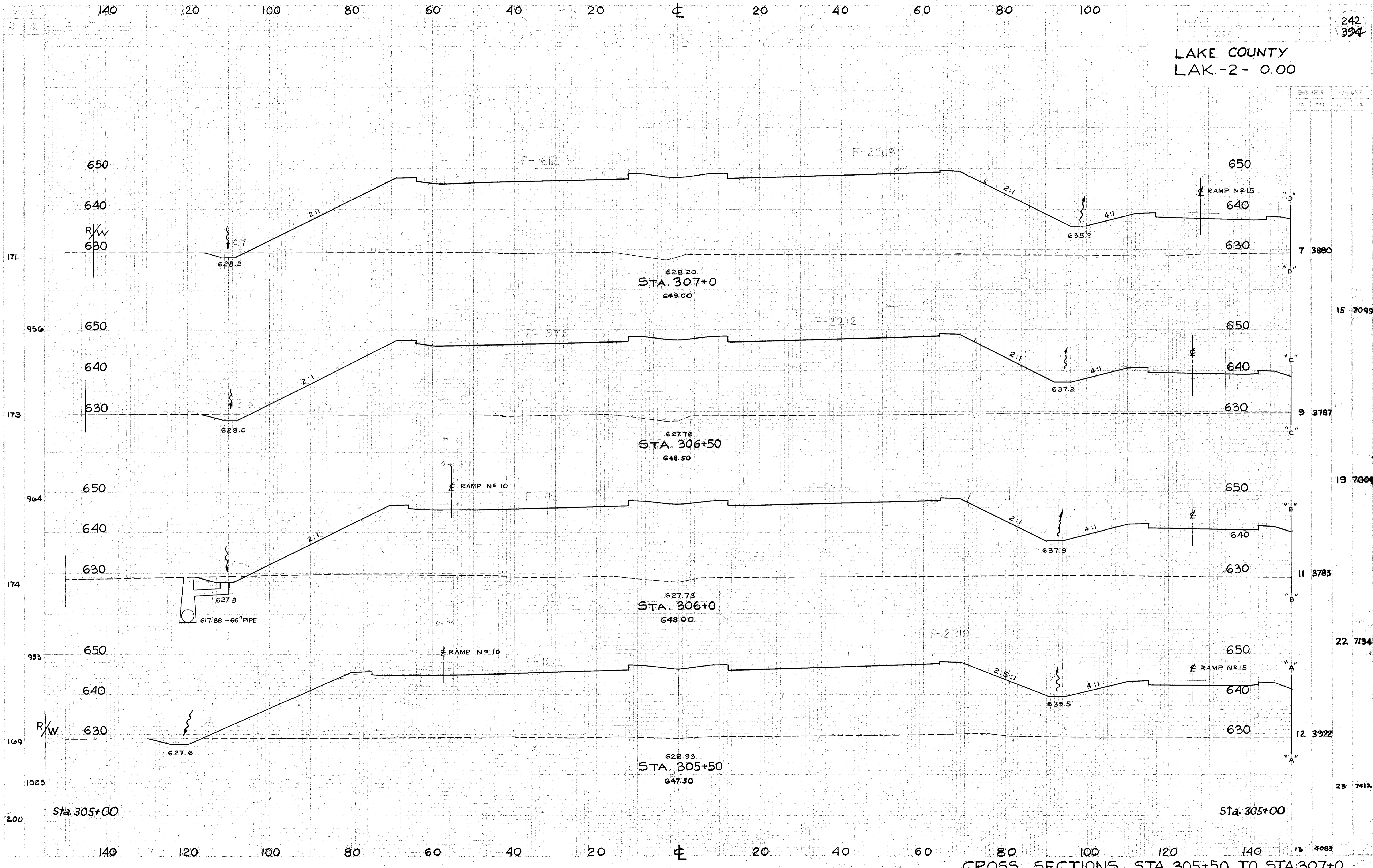

Elev. Above		Values	
Grp.	Rel.	Grp.	Rel.

7 3880
"D"

15 7099
"C"

9 3187
"C"

19 7809
"B"

11 3783
"B"

22 7134
"A"

12 3922
"A"

23 7412
"A"

13 4083

CROSS SECTIONS STA. 305+50 TO STA. 307+0