

LAKE COUNTY  
LAK-2- 0.00

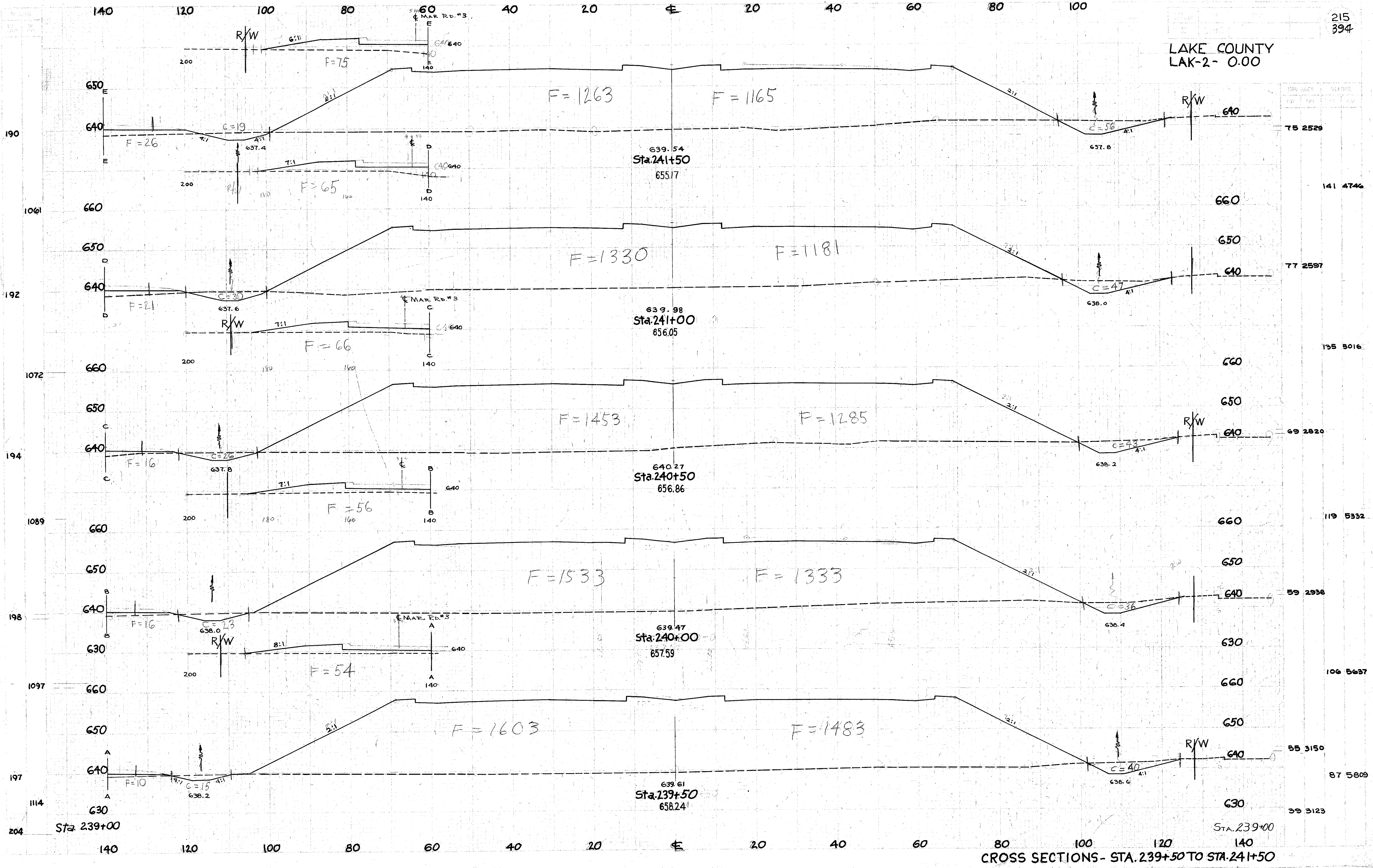

Station	Point	Elevation
75	2529	640
141	4746	660
77	2597	640
135	5016	660
69	2820	640
119	5332	660
59	2938	640
106	5697	660
55	3150	640
87	5809	630
39	3123	630

CROSS SECTIONS- STA. 239+50 TO STA. 241+50