

260 240 220 200 180 160 140 140 160 180 200 220 240

LAKE-COUNTY
LAK-2-0.00

CROSS AREA		VOLUME	
CUY	FWL	CUY	FWL
185	160		
204	151		
230	83		
516	100		
327	25		
688	36		
416	14		

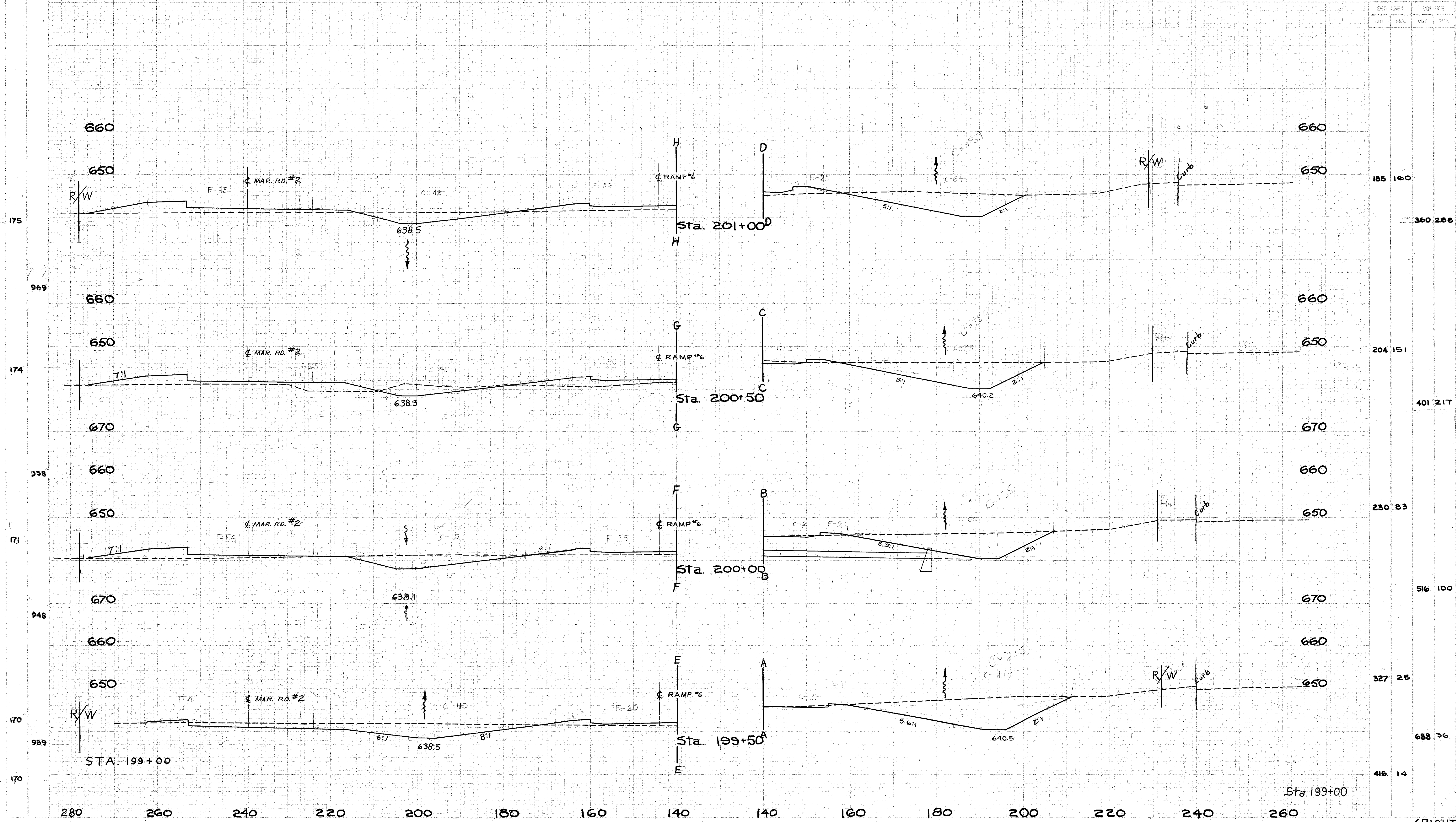

CROSS SECTION EXTENSIONS STA. 199+50 TO STA. 201+00 (RIGHT & LEFT)