

LAKE COUNTY  
LAK-2-0.00

# EXTRA AREA DETAIL - RUSH ROAD (E. 305)

SCALE 1"=20'

LOCATION	T-71 9" REINF. PORT. CEMENT CONC. PAV'T. SQ. YDS.	I-22 SUBBASE CU. YDS.	I-12 TYPE 2-A CONC. CURB LIN. FT.	I-21 4" CONC. MEDIAN TYPE 1 SQ. YDS.	E-6 REM. DISP. OF EXIST. PAV'T. SQ. YDS.	E-6 REM. DISP. OF EXIST. CURB LIN. FT.
EXISTING LAKELAND 9+33.15 TO 10+82.01					33	
0+38 TO 0+87.88	89	16	72.7			
0+33 TO 0+73.14	55	11	61.3			
0+35 TO 5+50	3248	582	895.0	45		
4+78 TO 5+80					545	707
4+69.86 TO 5+80	380	67	160.6			
5+80 TO 8+10	320	62	462.0			
<b>TOTAL</b>	<b>4092</b>	<b>738</b>	<b>1651.6</b>	<b>45</b>	<b>578</b>	<b>707</b>

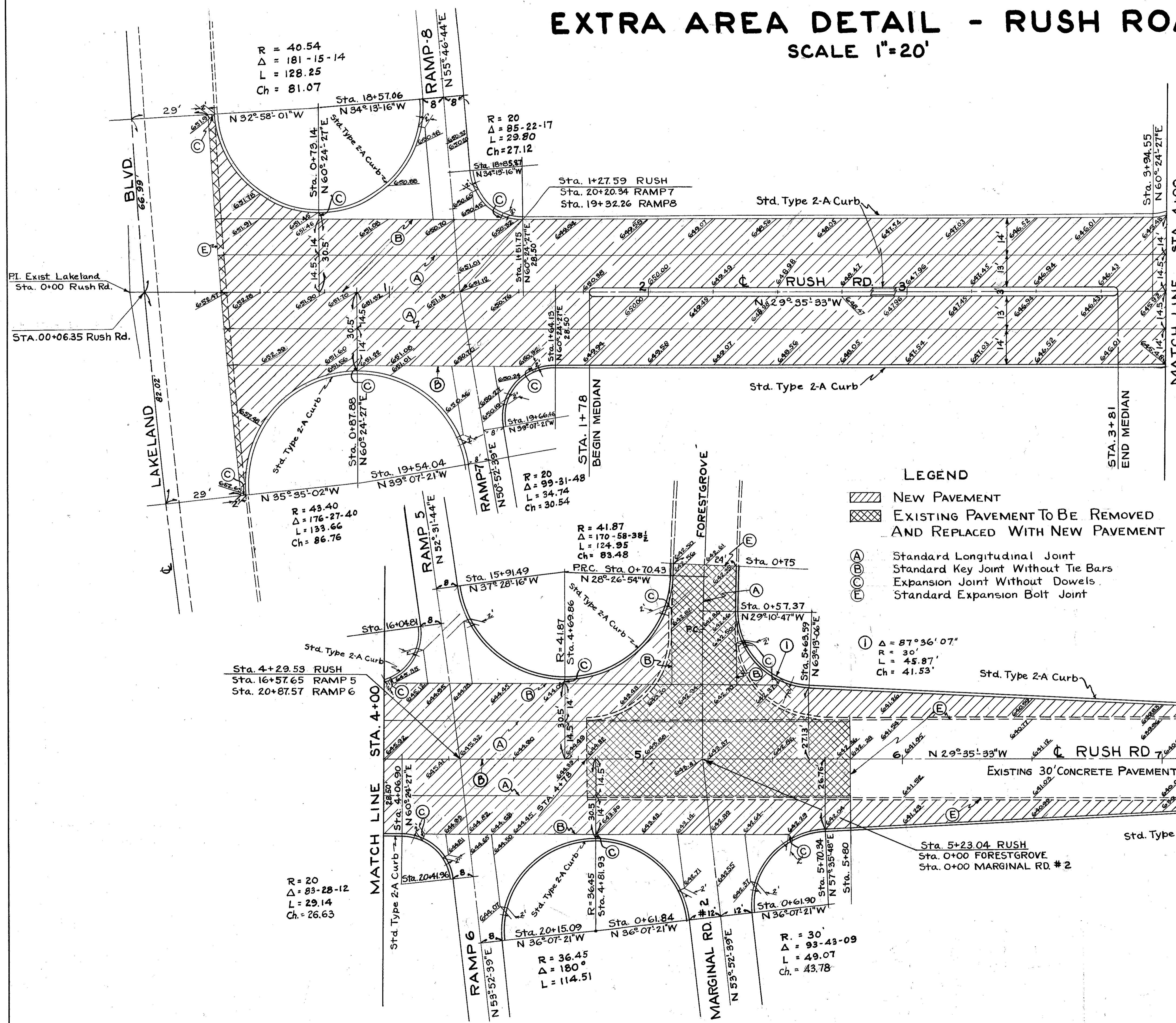

- LEGEND**
- NEW PAVEMENT
  - EXISTING PAVEMENT TO BE REMOVED AND REPLACED WITH NEW PAVEMENT
  - Standard Longitudinal Joint
  - Standard Key Joint Without Tie Bars
  - Expansion Joint Without Dowels
  - Standard Expansion Bolt Joint

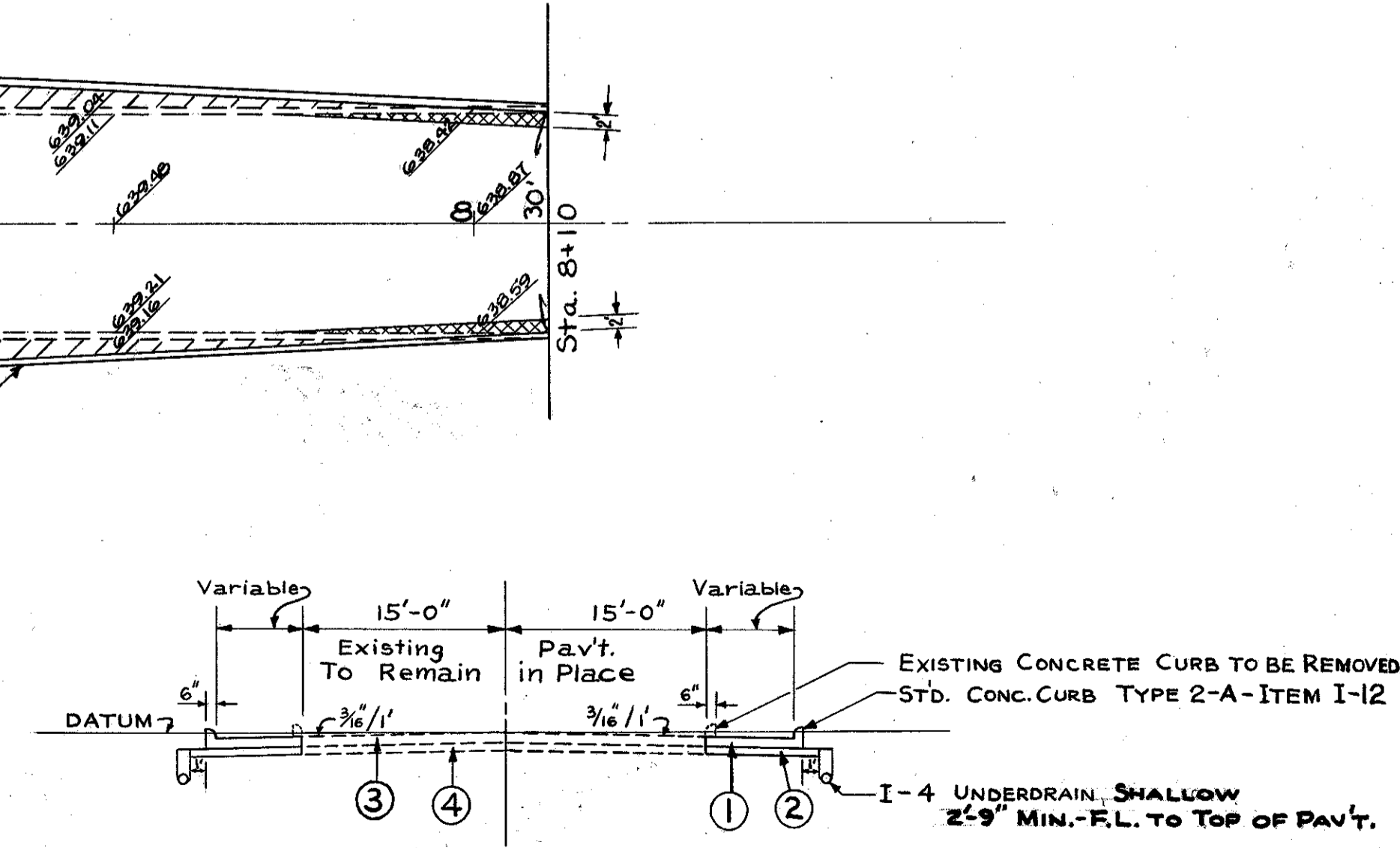
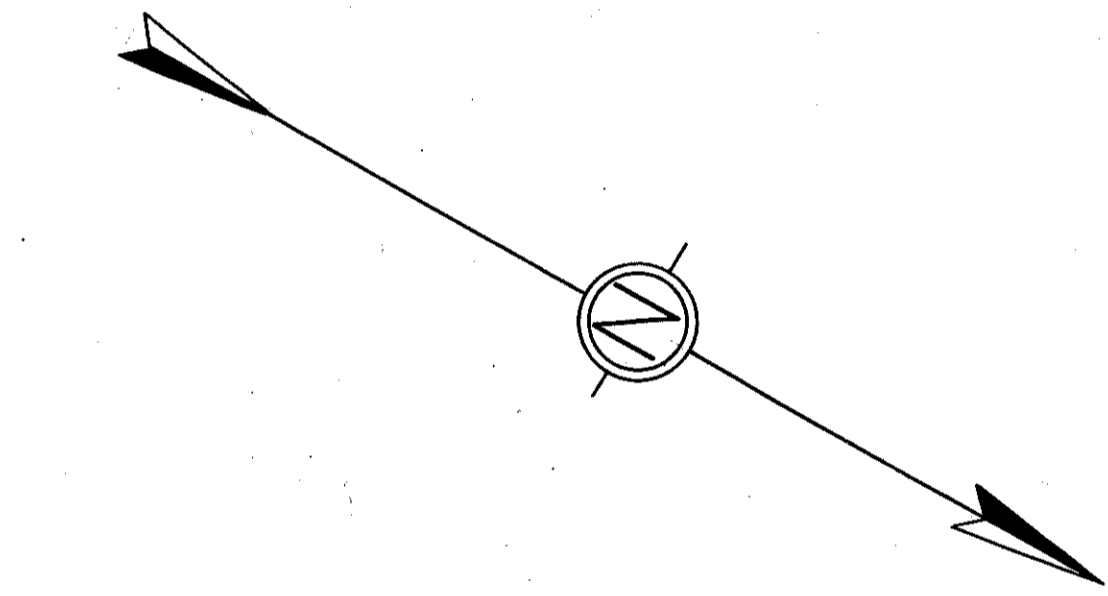

- ① 9" T-71 REINFORCED PORT. CEMENT CONC. PAV'T.
- ② 6" I-22 SUBBASE
- ③ EXISTING CONCRETE PAV'T.
- ④ EXISTING SUBBASE

# EXTRA AREA DETAIL - RUSH ROAD (E. 305)