

# EXTRA AREA DETAIL-RAMP N<sup>o</sup> 10

SCALE 1"=20'

FED. RD. DIVISION	STATE	PROJECT	FISCAL YEAR
2	OHIO		100 394

LAKE COUNTY  
LAK-2-0.00

### CURVE DATA

①	②	
$\Delta = 50^{\circ}00'00''$	$\Delta = 50^{\circ}00'00''$	
$R = 230.00'$	$R = 238.00'$	
$T = 107.25'$	$T = 110.98'$	
$L = 200.71'$	$L = 207.69'$	
$Ch = 19.440'$	$Ch = 201.17'$	
③	④	⑤
$\Delta = 20^{\circ}25'50''$	$\Delta = 149^{\circ}48'48''$	$\Delta = 81^{\circ}16'09''$
$R = 277.65'$	$R = 2.00'$	$R = 125.00'$
$T = 49.76'$	$L = 5.23'$	$T = 107.27'$
$L = 99.00'$		$L = 177.30'$
$Ch = 98.48'$		$Ch = 162.81'$
⑥	⑦	⑧
$\Delta = 81^{\circ}16'09''$	$\Delta = 81^{\circ}16'09''$	$\Delta = 90^{\circ}00'00''$
$R = 133.00'$	$R = 141.00'$	$R = 50.00'$
$T = 114.13'$	$T = 121.00'$	$T = 50.00'$
$L = 188.65'$	$L = 200.00'$	$L = 78.54'$
$Ch = 173.23'$	$Ch = 183.65'$	$Ch = 70.71'$
⑨	⑩	⑪
$\Delta = 90^{\circ}00'00''$	$\Delta = 37^{\circ}16'28''$	$\Delta = 127^{\circ}16'28''$
$R = 58.00'$	$R = 66.00'$	$R = 5.00'$
$T = 58.00'$	$L = 42.94'$	$L = 11.11'$
$L = 91.11'$	$Ch = 42.18'$	
$Ch = 82.02'$		

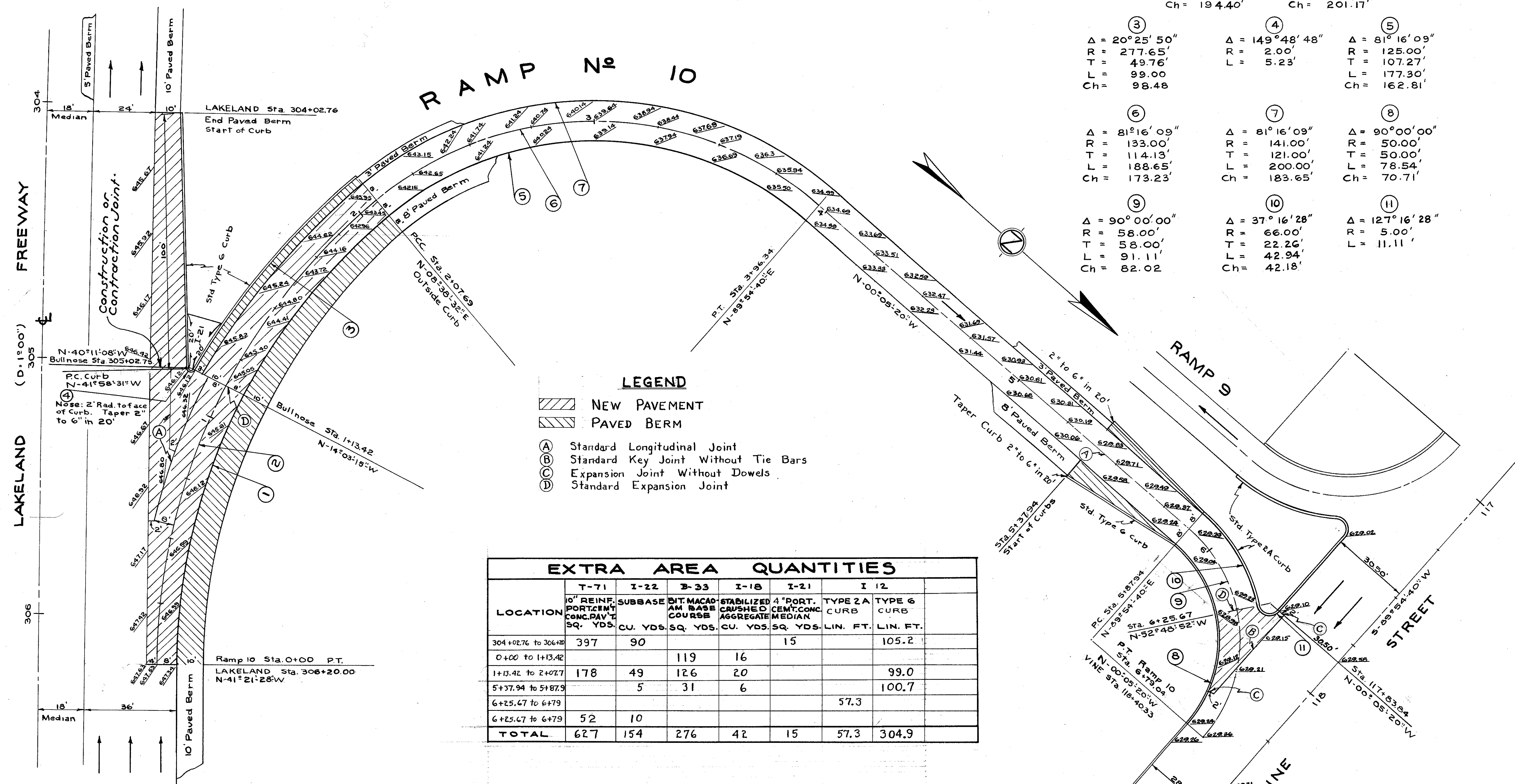

### LEGEND

- NEW PAVEMENT
- PAVED BERM
- (A) Standard Longitudinal Joint
- (B) Standard Key Joint Without Tie Bars
- (C) Expansion Joint Without Dowels
- (D) Standard Expansion Joint

### EXTRA AREA QUANTITIES

LOCATION	T-71	I-22	B-33	I-18	I-21	I-12
	0" REINF. PORTLAND CONC. PAV'T SQ. YDS.	SUBBASE CU. YDS.	BITUMACIO AM. BASE COURSE SQ. YDS.	STABILIZED CRUSHED AGGREGATE CU. YDS.	4" PORT. CONC. CURB LIN. FT.	TYPE 6 CURB LIN. FT.
304+02.76 to 306+00	397	90			15	105.2
0+00 to 1+13.42			119	16		
1+13.42 to 2+07.7	178	49	126	20		99.0
5+37.94 to 5+87.9		5	31	6		100.7
6+25.47 to 6+79					57.3	
6+25.47 to 6+79	52	10				
<b>TOTAL</b>	<b>627</b>	<b>154</b>	<b>276</b>	<b>42</b>	<b>15</b>	<b>304.9</b>