

EXTRA AREA DETAIL-RAMP N:3

SCALE 1"=20'

FED. RD. DIVISION	STATE	PROJECT	FISCAL YEAR
2	OHIO		

LAKE COUNTY
LAK-2-0.00

91
394

LOCATION	T-71	I-22	B-33	I-18	I-12	
	10" REINF. PORT. CEMENT CONC. PAVT SQ. YDS.	SUBBASE CU. YDS.	BIT. MACAD. AM. BASE COURSE SQ. YDS.	STABILIZED CRUSHED AGGREGATE CU. YDS.	SPECIAL CURB LIN. FT.	TYPE 6 CURB LIN. FT.
0+00 to 1+08.28	183	47	106	15		
139+03 to 140+04.76		25	151	30		
1+08.28 to 1+95.07	178	30				
1+08.28 to 3+00					191.7	
1+95.07 to 3+00		5	29	6		
10+28.59 to 11+45.42	218	36				188.1
TOTAL	579	143	286	51	191.7	188.1

LEGEND

- NEW PAVEMENT
- PAVED BERM

- (A) Standard Longitudinal Joint
- (B) Standard Key Joint Without Tie Bars
- (C) Expansion Joint Without Dowels
- (D) Standard Expansion Joint

RAMP N:3

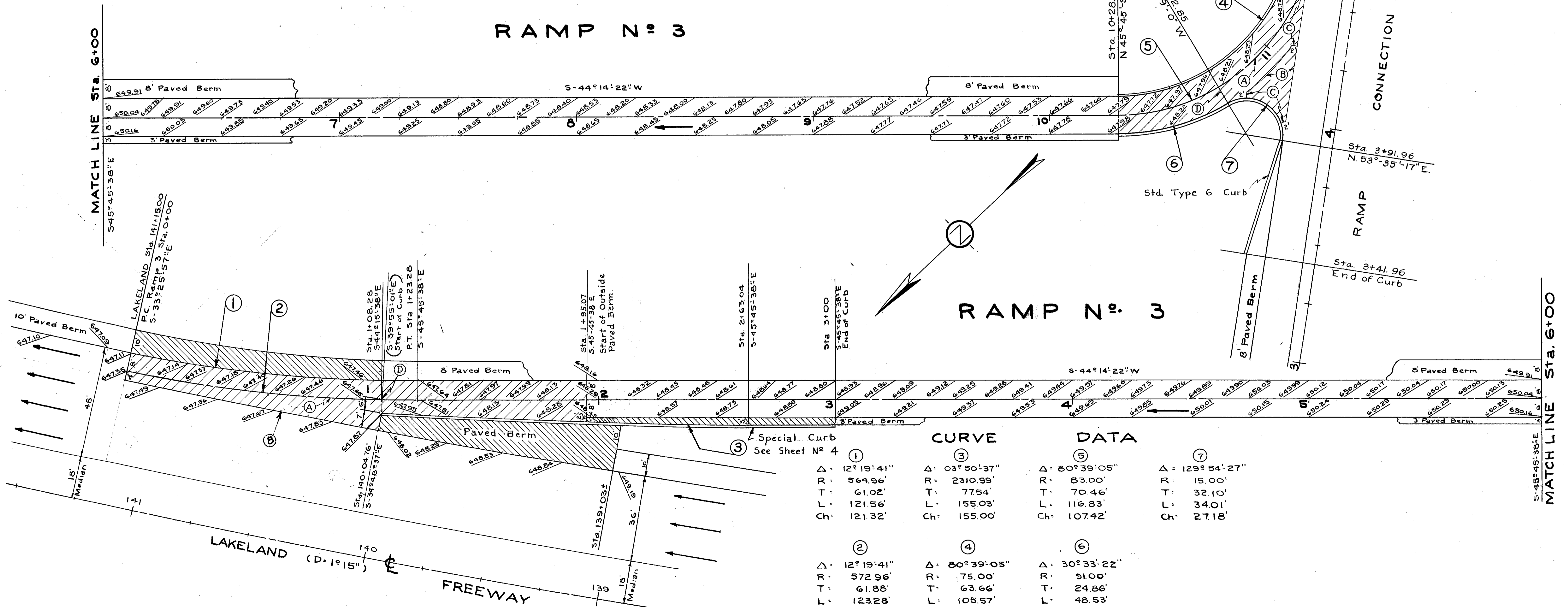

CURVE DATA

Curve No.	Angle (Δ)	Radius (R)	Tangent (T)	Length (L)	Chord (Ch)
1	12° 19' 41"	564.96'	61.02'	121.56'	121.32'
2	12° 19' 41"	572.96'	61.88'	123.28'	123.04'
3	03° 50' 37"	2310.99'	77.54'	155.03'	155.00'
4	80° 39' 05"	75.00'	63.66'	105.57'	97.07'
5	80° 39' 05"	83.00'	70.46'	116.83'	107.42'
6	30° 33' 22"	91.00'	24.86'	48.53'	47.96'
7	129° 54' 27"	15.00'	32.10'	34.01'	27.18'

EXTRA AREA DETAIL-RAMP N:3