

LAKE COUNTY
LAK. - 2-0.00

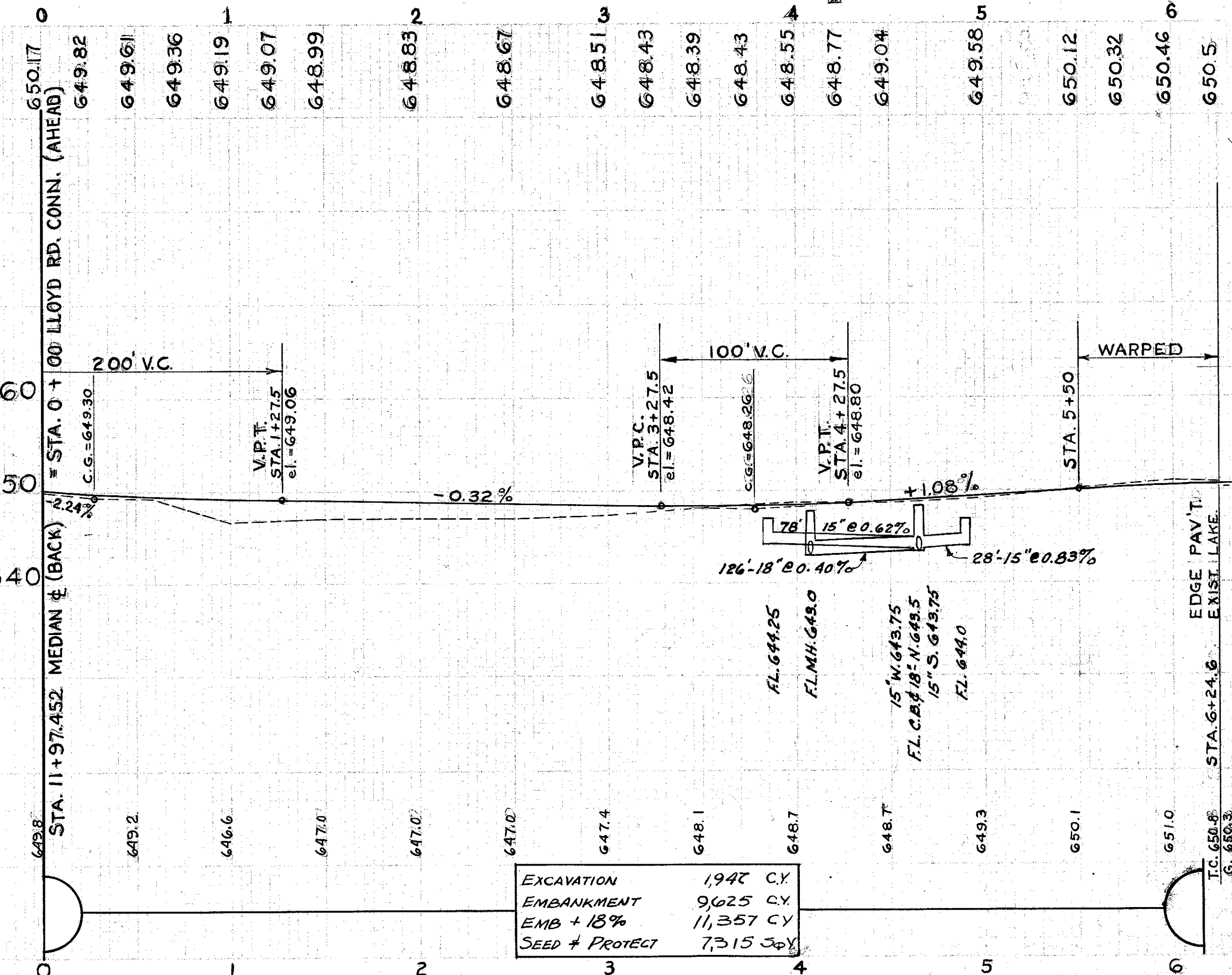
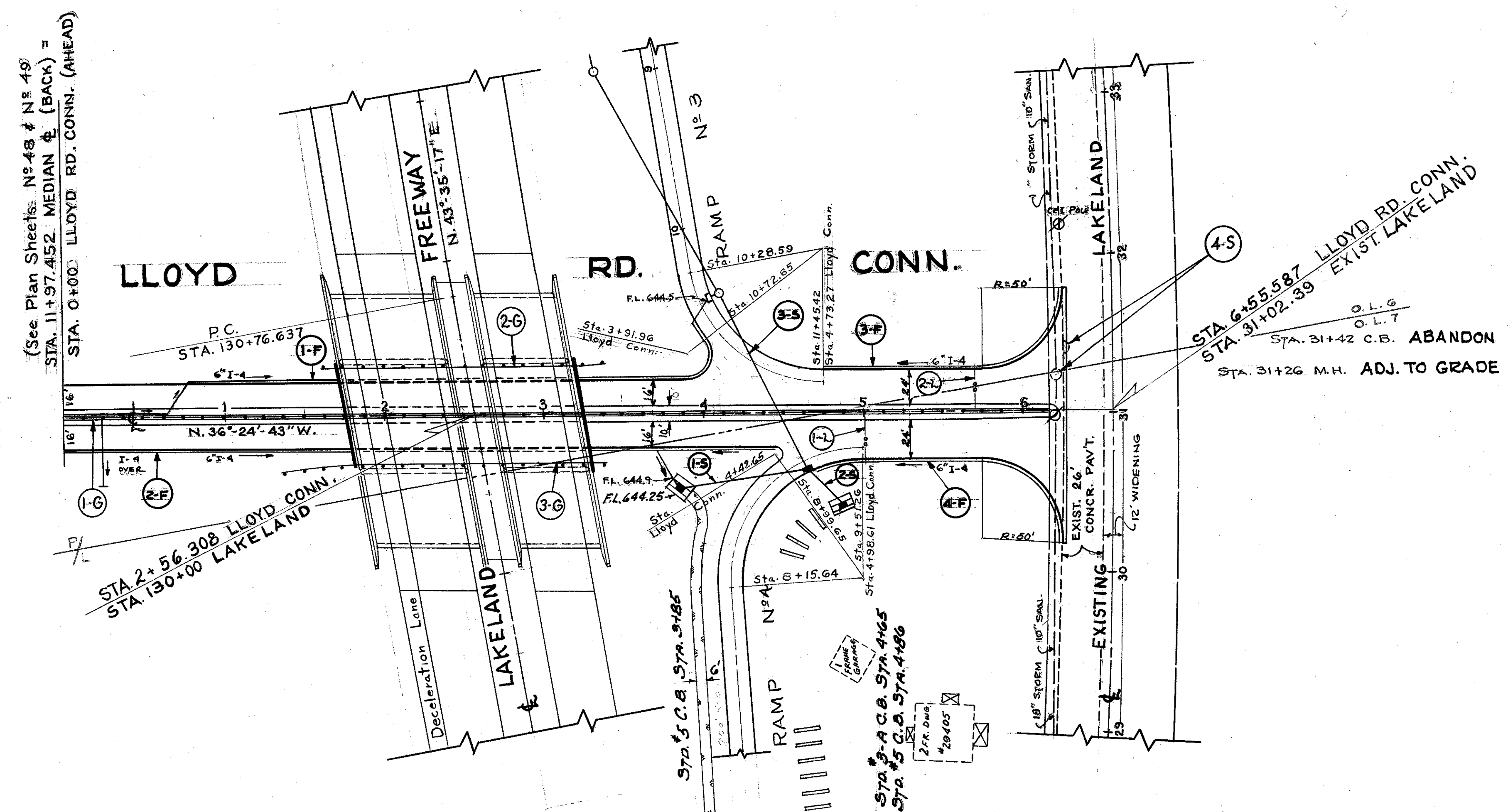
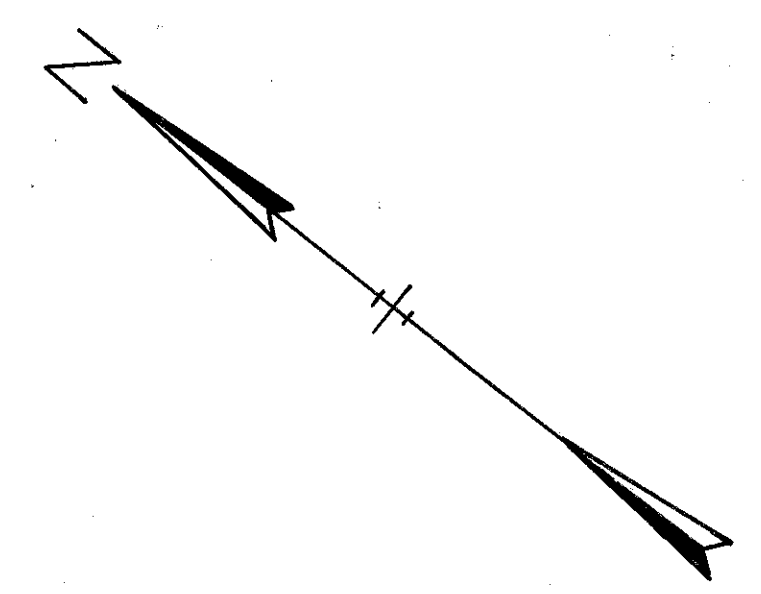

I-15 GUARD RAIL					
REF. NO.	STATIONS		SIDE	No 2-B	
	FROM	TO		STANDARD	BARRIER
1-G	0+00	6+13	C	612.5	
2-G	1+60	3+35	L	175.0	
3-G	1+40	3+40	R	200.0	
TOTALS				375.0	612.5

S-25 ELECTRICAL DUCT				
REF. NO.	LOCATION	SIDE	SIZE	LENGTH
				LIN. FT.
1-L	STA. 5+00	R	2-4"	32
2-L	STA. 3+70	L	2-4"	32
TOTALS				64

STORM SEWERS											
REF. NO.	STATION	SIDE	I-2 CL. A' (15")	I-2 LIN. FT.	I-5 STD. #5 C.B.	I-5 STD. #3-A C.B.	L-10 SOD. SQ. YD.	I-8 M.H. ADJUST.	I-16 C.B. ABANDON.	I-16	
											FROM
1-S	3+85	4+65	R	78	1		133				
2-S	4+65	4+90	R	28	1		54				
3-S	4+10	4+65	L/R			1					
4-S	3+26	3+42	L					1	1		
TOTALS				78	28	126	2	1	187	1	1

6" UNDERDRAIN										
REF. NO.	STATION	SIDE	I-4 ROLL SHALLOW PIPE	I-4 LIN. FT.	I-5 6" 60° BEND	I-5 6" 60° WYE	I-2 6" 60° INCR.	I-2 L.F.	I-2	I-2
1-F	0+00	4+00	L	440	3		1			
2-F	0+90	4+44	R	462	8		1			
3-F	4+99	EXIST. LAK.	L	178						
4-F	4+99	EXIST. LAK.	R	152						
TOTALS				1232	8	3	1	1	1	18

EXCAVATION	1,947 C.Y.
EMBANKMENT	9,625 C.Y.
EMB + 18%	11,357 C.Y.
SEED + PROTECT	7,315 Sq.Y.

PLAN & PROFILE - LLOYD RD. CONN. - STA. 0+00 TO STA. 6+55.59