

LAKE COUNTY
LAK-2-0.00

Curve Data
 $\Delta = 8^{\circ}07'10''$
 $D = 0^{\circ}28'$
 $T = 12,277.66'$
 $L = 871.39'$
 $L = 1739.88'$

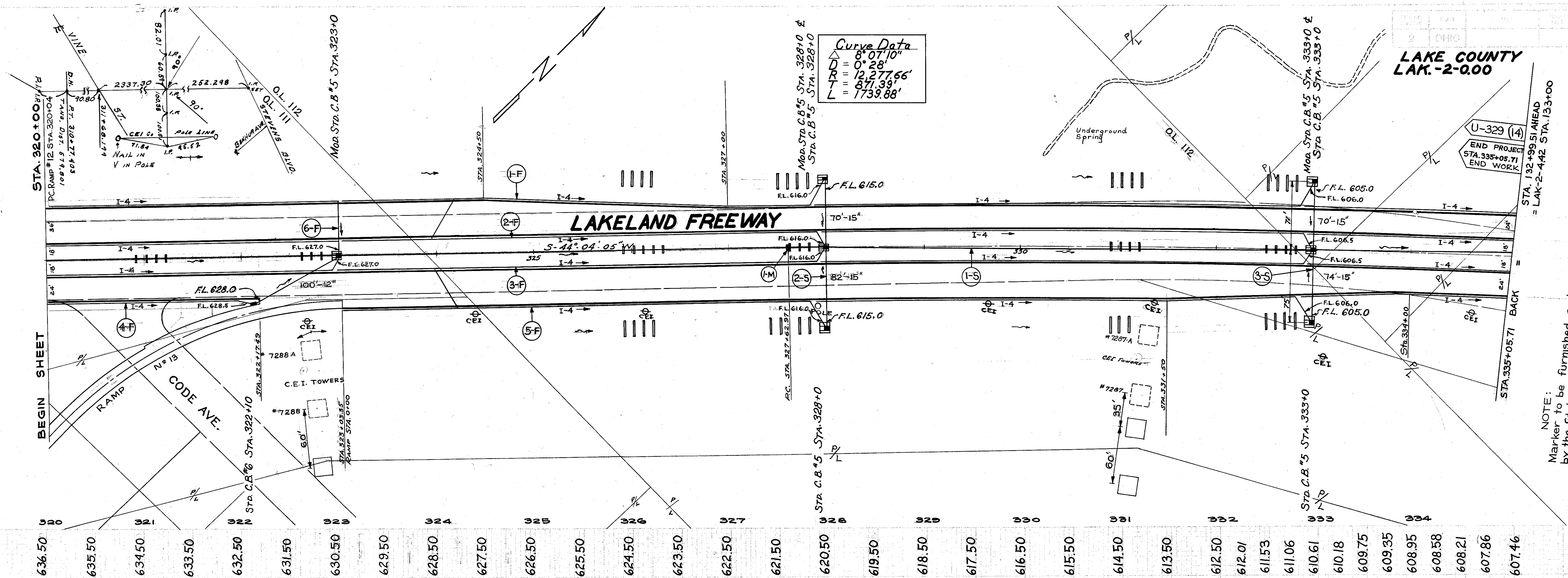

REF. No	STATION	SIDE R. OR L.	I-2 CLASS "B"				I-8	EACH	L-10	
			UNDER PAVT.	UNDER PAVT.	12"	15"				18"
1-S	320+00	R	15	12	15	18	24	3	1	
2-S	328+00	BOTH	152	795	497	197				
3-S	333+00	BOTH	144							
	320+00	BOTH							297	
TOTALS			296	100	795	497	197	4	3	1

REF. No	STATION	SIDE R. OR L.	I-2		I-4		I-5		EACH	
			8" UNDER PAVT. M-6.5b or M-6.8b	M-6.4C	SHALLOW	8" OUTLET PIPE	6" 60° BEND	6" 90° BEND	6" x 8" INCREASER	8" x 8" TEE
1-F	320+00	R			1530	16				
2-F	320+00	L			1506	16				
3-F	320+00	R			1498	24				
4-F	320+00	R			206					
5-F	323+03	R			1226	16				
6-F	323+00	L	48	6						
TOTALS			48	6	5966	72	9	1	1	1

MONUMENT BOXES		
ITEM No	STATION	MONUMENT BOX ASSEMBLY TYPE A TYPE B
1-M	PC 327+62.97	1

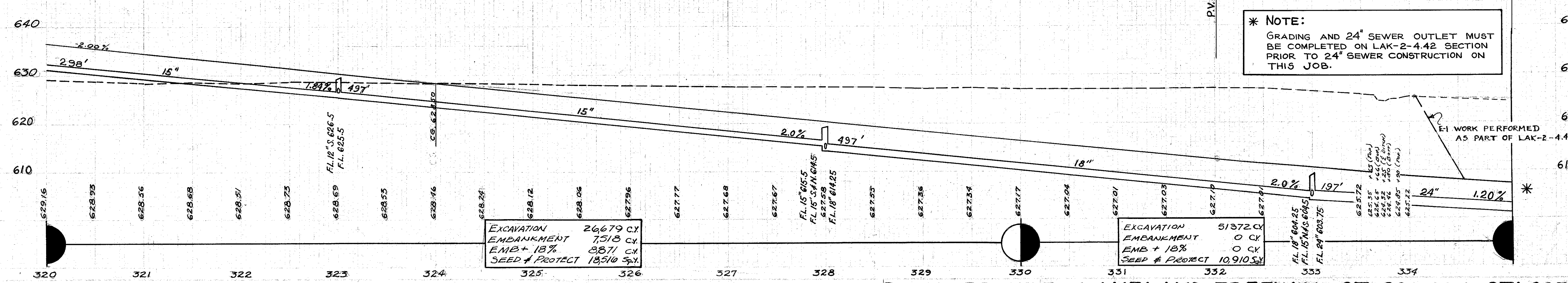

*** NOTE:**
 GRADING AND 24" SEWER OUTLET MUST BE COMPLETED ON LAK-2-4.42 SECTION PRIOR TO 24" SEWER CONSTRUCTION ON THIS JOB.

EXCAVATION 24679 C.Y.
 EMBANKMENT 7518 C.Y.
 EMB + 18% 2371 C.Y.
 SEED & PROTECT 18510 S.F.

EXCAVATION 51372 C.Y.
 EMBANKMENT 0 C.Y.
 EMB + 18% 0 C.Y.
 SEED & PROTECT 10910 S.F.

NOTE:
 Marker to be furnished and erected on the left by the State of Ohio before acceptance of this project.

PLAN & PROFILE LAKELAND FREEWAY STA. 320+00 to STA. 335+05.71