

FED. RD. DIVISION	STATE	PROJECT	
2	OHIO		

9  
394

LAKE COUNTY  
LAK. - 2-0.00

# TYPICAL SECTION VINE ST. TYPE T-71 REINFORCED CONCRETE PAVEMENT SCALE 1/4" = 1'-0"

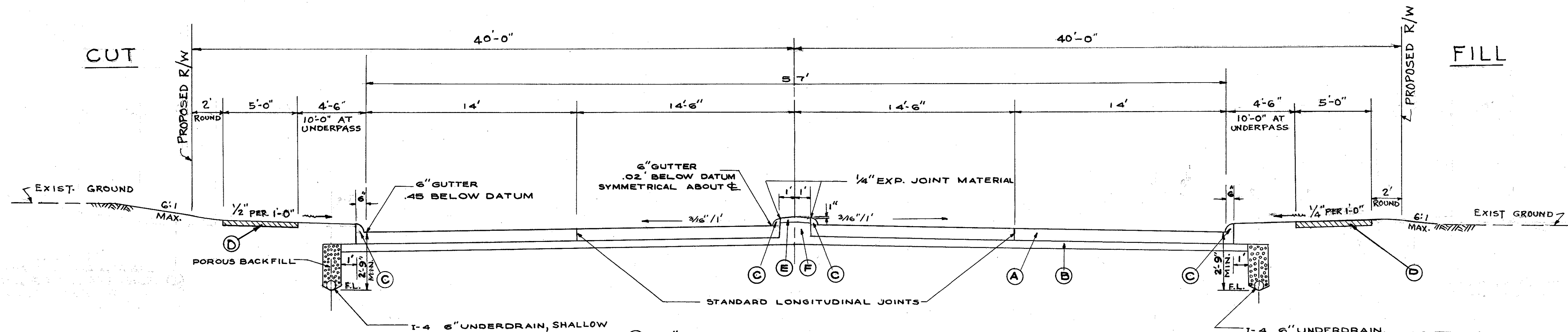

- (A) 9" T-71 REINFORCED PORTLAND CEMENT CONCRETE PAVEMENT.
- (B) 6" I-22 SUBBASE GRADING A OR B.
- (C) I-12 STANDARD CONCRETE CURB TYPE 2-A.
- (D) 4" I-13 CONCRETE SIDEWALK.
- (E) 4" I-21 CONCRETE MEDIAN STANDARD TYPE 1 (SEE LIMITS BELOW)
- (F) I-22 SUBBASE MATERIAL GRADING A OR B, AS PER PLAN

**NOTE:** CROSS-SECTIONS SHALL GOVERN OVER TYPICAL SECTION WHERE VARIABLE CONDITIONS ARE ENCOUNTERED IN SLOPES.

STA. 116+00 TO STA. 126+50  
 MEDIAN AS SHOWN APPLIES ONLY WITHIN THE FOLLOWING LIMITS:  
 STA. 117+20 TO STA. 118+50  
 STA. 121+80 TO STA. 126+50

# TYPICAL SECTION EXISTING LAKELAND BLVD. TYPE T-35 ASPHALTIC CONC. PAVT. Scale 1/4" = 1'-0"

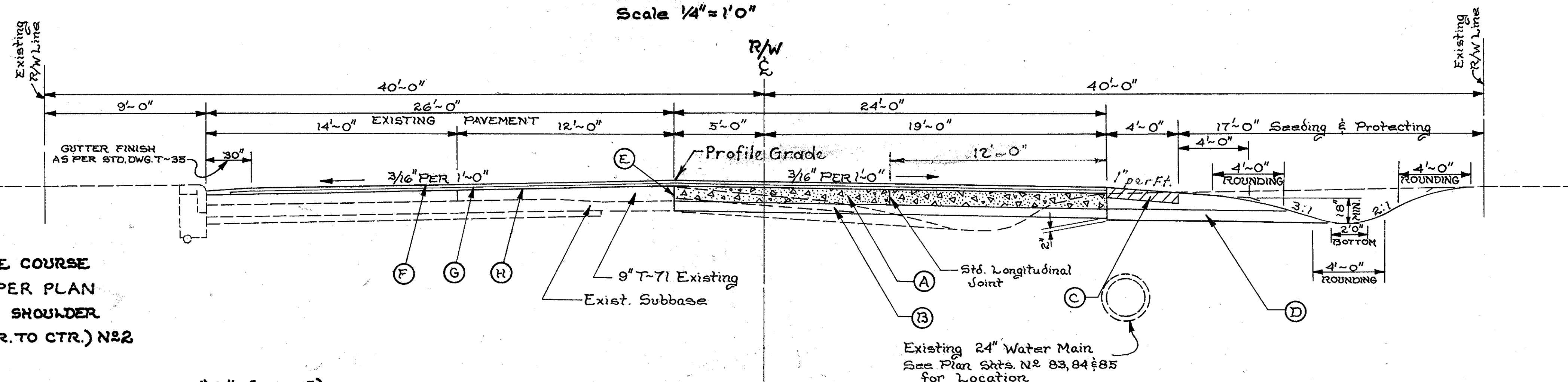

- (A) 9" T-71 PORTLAND CEMENT CONCRETE BASE COURSE
- (B) 6" I-22 SUBBASE, GRADING "A" OR "B", AS PER PLAN
- (C) 6" I-18 STABILIZED CRUSHED AGGREGATE SHOULDER
- (D) I-9 STONE UNDERDRAIN (SPACED 50' CTR. TO CTR.) N#2
- (E) STANDARD EXPANSION BOLT JOINT
- (F) 1/4" T-35 ASPHALTIC CONCRETE SURFACE COURSE TYPE "C" (70-85)
- (G) 1/4" MIN. T-35 ASPHALTIC CONCRETE LEVELING COURSE (70-85)
- (H) T-30 BITUMINOUS TACK COAT @ 0.10 GAL./SQ.YD.  
 SEC. M-5.5, MS-2 OR RS-1  
 OR SEC. M-5.2, RC-1 OR RC-2 OR RC-3 AS PER SEC. T-30.02

STA. 21+00 TO STA. 33+72.86  
 STA. 33+72.86 TO STA. 37+00 VARIABLE WIDTH WIDENING

TYPICAL SECTION VINE STREET & EXISTING LAKELAND BLVD.