

Power Service VS 127+50 It, Vine St
Circuit A4
 34 Lights @ 400Watts each = 13,600
 1 Sign @ 175 " " = 175
 Total Ballast Loss = 2,765
 Total Circuit Watts = 16,460

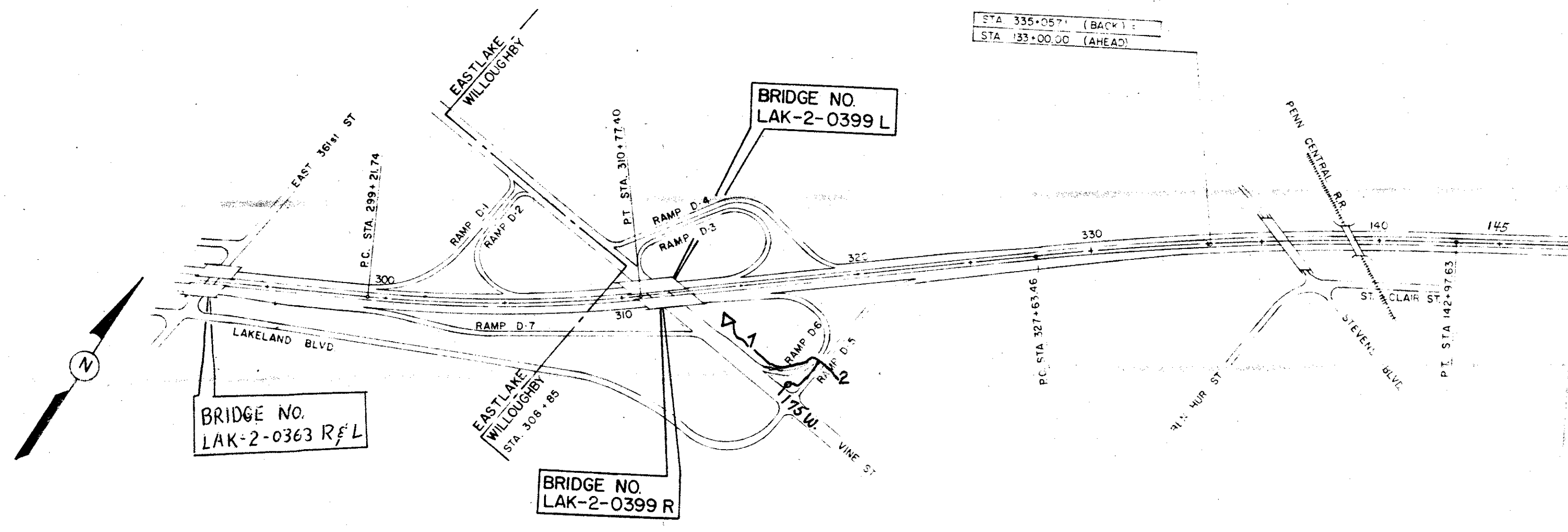

Power Service VS 127+50 It, Vine St.
Circuit B4
 8 Lights @ 400Watts each = 3,200
 1 Sign @ 175 " " = 175
 Total Ballast Loss = 640
 Total Circuit Watts = 4,015

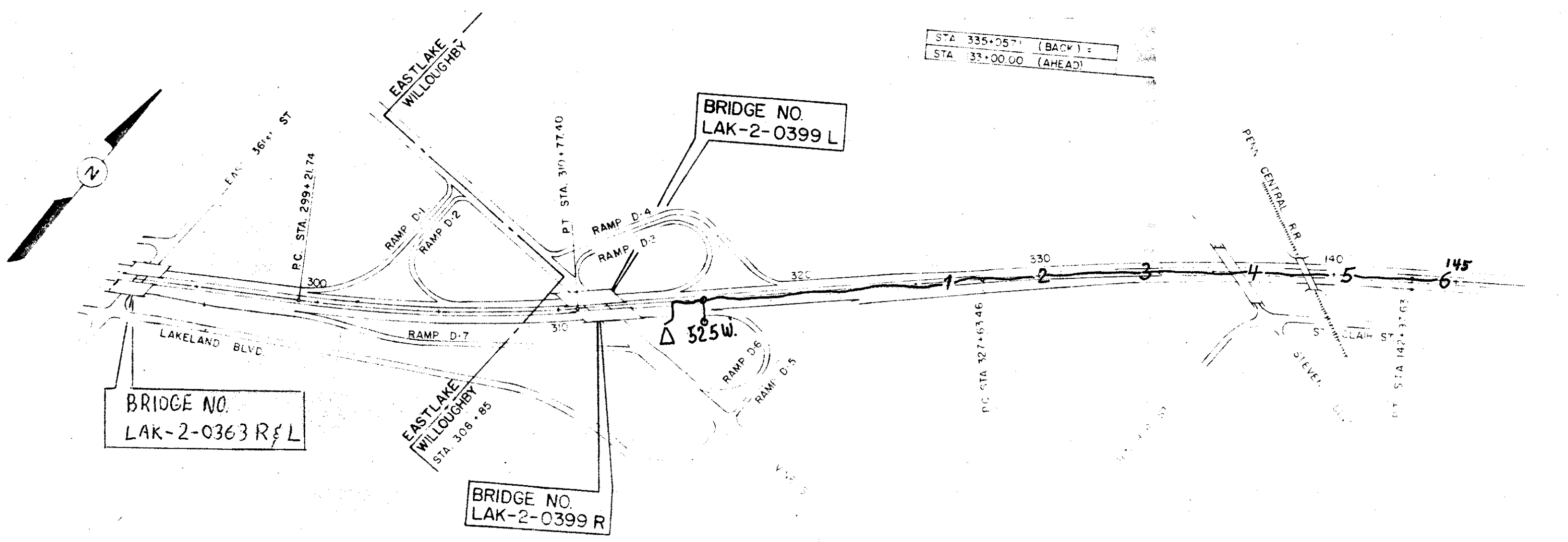

Power Service VS 127+50 It, Vine St.
Circuit C3
 18 Lights @ 400Watts each = 7,200
 1 Sign @ 525 " " = 525
 Total Ballast Loss = 1,520
 Total Circuit Watts = 9,245

