

FOR GUARDRAIL QUANTITIES SEE SHEET 52
 FOR DRAINAGE QUANTITIES SEE SHEET 21

FHWA REGION	STATE	PROJECT
5	OHIO	

38
171

LAKE COUNTY
 LAK-2-0.00

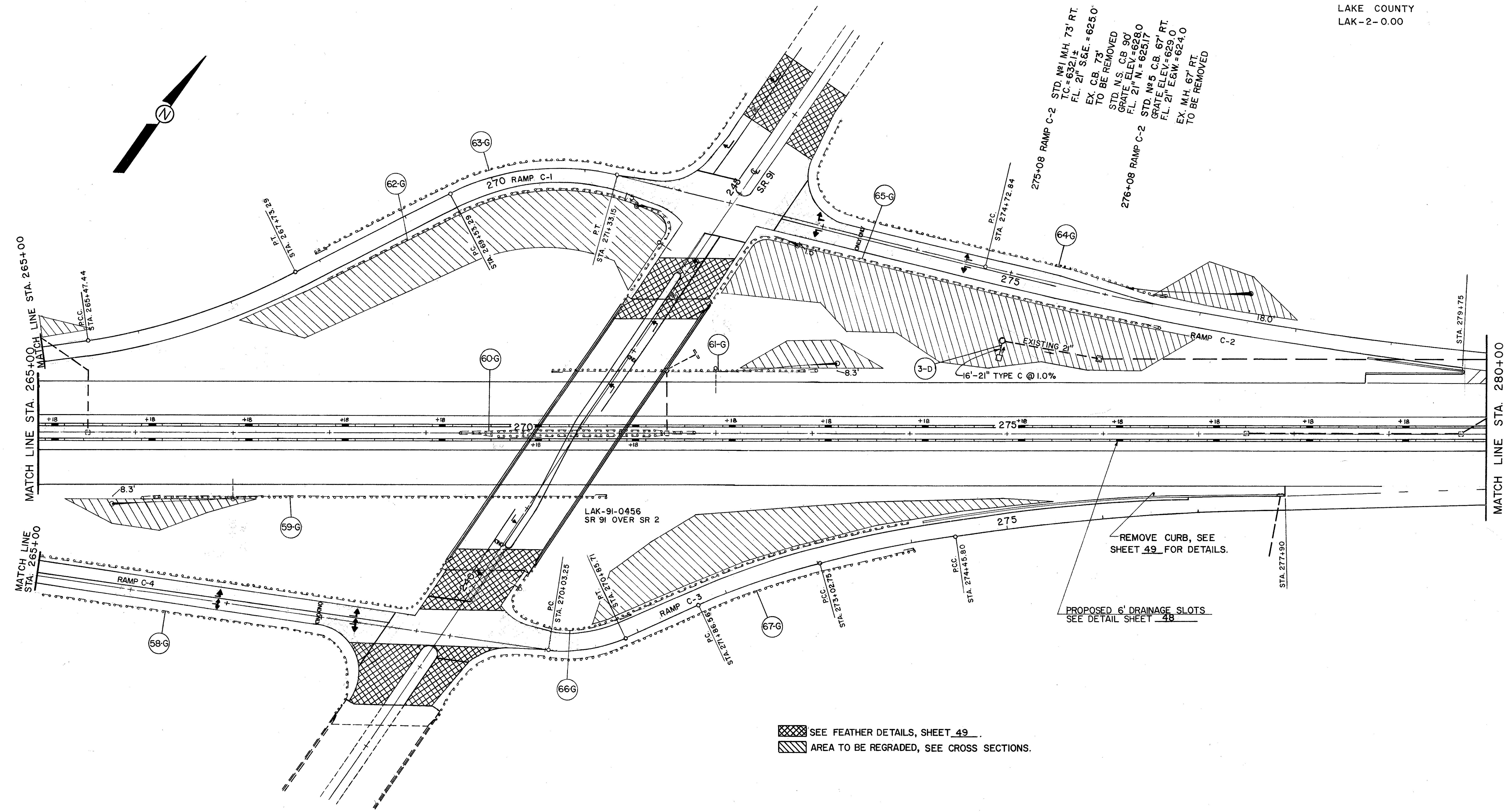
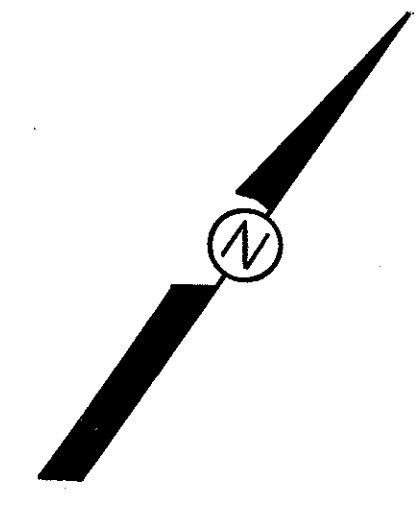

STD. NO. 1 M.H. 73' RT.
 T.C. = 632.13
 F.L. 21" S&E. = 625.0
 EX. CB. 73'
 TO BE REMOVED

STD. N.S. CB. 90'
 GRATE ELEV. = 628.0
 F.L. 21" N. = 625.17

STD. NO. 5 C.B. 67' RT.
 GRATE ELEV. = 629.0
 F.L. 21" E&W. = 624.0
 EX. M.H. 67' RT.
 TO BE REMOVED

SEE FEATHER DETAILS, SHEET 49
 AREA TO BE REGRADED, SEE CROSS SECTIONS.