

GENERAL NOTES

FHWA REGION	STATE	PROJECT	
5	OHIO		

13
171

LAKE COUNTY
LAK-2-0.00

SEQUENCE OF CLOSURES

- PART A- E.B. STA. 100+00 TO 270+00
- PART B- W.B. STA. 100+00 TO 270+00
- PART C- E.B. STA. 270+00 TO 222+16
- PART D- W.B. STA. 270+00 TO 222+16

NOTE: CONTRACTOR MAY WORK ON ANY TWO(2) PARTS AT ONE TIME WITH THE FOLLOWING RESTRICTION: WHEN BOTH PARTS ARE IN THE EASTBOUND (OR WEST-BOUND) DIRECTION CONTRACTOR MUST WORK ON SAME PHASE AS LISTED UNDER SEQUENCE OF OPERATIONS BEGINNING WITH PHASE I SO AS TO PREVENT WEAVING OF TRAFFIC FROM ONE PART TO THE NEXT.

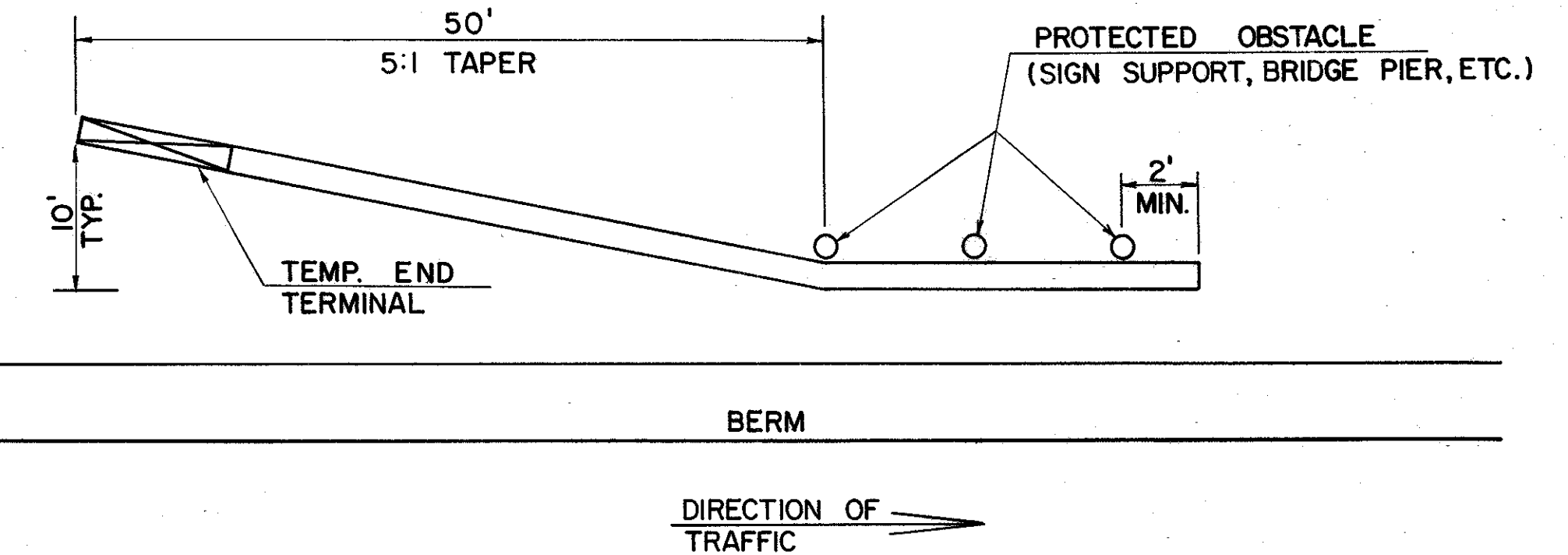

TEMPORARY PROTECTION OF OBSTACLES

SEQUENCE OF OPERATIONS (PARTS A-D)

STA. 100+00 TO STA. 315+00

PHASE I
CLOSE OUTSIDE LANE 1) REPAIR OUTSIDE LANE PAVEMENT 2) PLACE AGGREGATE DRAINS 3) REBUILD 10 FT. OUTSIDE BERM WITH 6 IN.-301 4) PLACE PORTION OF ANY REQUIRED ELECTRICAL CONDUIT 5) PLACE ITEM 848 - ASPHALT INTERMEDIATE COURSE

PHASE II
CLOSE MIDDLE AND LEFT LANES 1) REPAIR BOTH LANES' PAVEMENT 2) PLACE AGGREGATE DRAINS 3) BEGIN BARRIER CONSTRUCTION 4) PLACE REMAINDER OF ANY REQUIRED ELECTRICAL CONDUIT 5) PLACE ITEM 848 - ASPHALT INTERMEDIATE COURSE

PHASE III
CLOSE LEFT LANE 1) COMPLETE BARRIER AND INSIDE BERM CONSTRUCTION

STA. 315+00 TO STA. 222+25

CLOSE OUTSIDE LANE 1) REPAIR OUTSIDE LANE PAVEMENT 2) PLACE AGGREGATE DRAINS 3) REBUILD 10 FT. OUTSIDE BERM WITH 3 IN.-301 4) PLACE PORTION OF ANY REQUIRED ELECTRICAL CONDUIT 5) PLACE ITEM 848 - ASPHALT INTERMEDIATE COURSE

CLOSE INSIDE LANE 1) REPAIR INSIDE LANE PAVEMENT 2) PLACE AGGREGATE DRAINS 3) REBUILD 10 FT. INSIDE BERM WITH 3 IN.-301 4) PLACE REMAINDER OF ANY REQUIRED ELECTRICAL CONDUIT 5) PLACE ITEM 848 - ASPHALT INTERMEDIATE COURSE

RAMPS
SEE DETAIL SHEETS FOR PHASE I, IA AND IB. COMPLETE ALL WORK INCLUDING ITEM 848 - ASPHALT INTERMEDIATE COURSE

ADVANCE WARNING SIGNS FOR ANY CONDITION WHICH RESTRICTS OR REDIRECTS TRAFFIC SHALL BE ERECTED BEFORE ANY SUCH RESTRICTION IS PUT INTO EFFECT. ALL SUCH SIGNS SHALL BE COVERED OR REMOVED FROM THE VIEW OF TRAFFIC WHENEVER THEY ARE NOT APPLICABLE. THE SIGNS SHALL BE REQUIRED ON BOTH SIDES OF THE ROADWAY & MOUNTED AT THE HEIGHT INDICATED ON PLATE C-1 OF THE "OMUTCD". THE SIGN LEGENDS AND LOCATIONS SHALL BE AS INDICATED IN THE FOLLOWING TABLE. DISTANCES ARE MEASURED BACK FROM THE POINT OF RESTRICTION. SIGN SUPPORT POSTS SHALL BE MAXIMUM 4 LB STEEL POSTS OR 4" x 4" NOMINAL WOOD POSTS.

SCHEDULE OF THRU LANES TO BE MAINTAINED

APPROXIMATE C.L. STATION LIMITS	BASIC ROADWAY TYPICAL SECTION	NUMBER OF THRU LANES MAINTAINED
1. STA. 100+00 TO STA. 315+00	3 LANES EACH DIRECTION	2 ADJACENT LANES EACH DIRECTION
2. STA. 315+00 TO STA. 222+25	2 LANES EACH DIRECTION	1 LANE EACH DIRECTION
3. RAMPS B-1 AND B-4	1 LANE MINIMUM	1-12 FT. LANE USING SHOULDERS REBUILT WITH ITEM 301
4. ALL OTHER RAMPS	1 LANE	1-11 FT. LANE USING SHOULDERS REBUILT WITH ITEM 301

PERMISSIBLE 1-LANE ADDITIONAL LANE CLOSURE

8:00 PM TO 6:00 AM *
10:00 AM TO 2:00 PM #
* DURING ASPHALT WORK ONLY
DURING JOINT CLEANING AND PARTIAL DEPTH PAVEMENT REPAIR ONLY

ADVANCE WARNING SIGNS				
	DISTANCE	SIGN	SIZE	DESCRIPTION
LEFT LANE CLOSED	500'	OW-123 MOD	48" x 48"	LEFT LANE CLOSED 500 FT.
		OW-143	30" x 30"	35 MPH
	1000'	OW-123 MOD	48" x 48"	LEFT LANE CLOSED 1000 FT.
	2000'	OW-123 MOD	48" x 48"	LEFT LANE CLOSED 2000 FT.
LEFT 2 LANES CLOSED	500'	OW-123 MOD	48" x 48"	LEFT 2 LANES CLOSED 500 FT.
		OW-143	30" x 30"	35 MPH
	1000'	OW-123 MOD	48" x 48"	LEFT 2 LANES CLOSED 1000 FT.
	2000'	OW-123 MOD	48" x 48"	LEFT 2 LANES CLOSED 2000 FT.
RIGHT LANE CLOSED	500'	OW-122 MOD	48" x 48"	RIGHT LANE CLOSED 500 FT.
		OW-143	30" x 30"	35 MPH
	1000'	OW-122 MOD	48" x 48"	RIGHT LANE CLOSED 1000 FT.
	2000'	OW-122 MOD	48" x 48"	RIGHT LANE CLOSED 2000 FT.
RIGHT 2 LANES CLOSED	500'	OW-122 MOD	48" x 48"	RIGHT 2 LANES CLOSED 500 FT.
		OW-143	30" x 30"	35 MPH
	1000'	OW-122 MOD	48" x 48"	RIGHT 2 LANES CLOSED 1000 FT.
	2000'	OW-122 MOD	48" x 48"	RIGHT 2 LANES CLOSED 2000 FT.
LANE SHIFT	1000'	OW-134 MOD	48" x 48"	ROAD WORK 1000 FT.
	2000'	OW-134	48" x 48"	ROAD WORK AHEAD