

REMOVE PORTION OF EXISTING MASONRY Item N° 1-X Station 179+50 36 Ft. to R. of & Remove existing concrete headwall 1.0 Cu. Yd. masonry removed

CATCH BASINS Standard I&C.B. N° 7

Item N°	Station	Ft. R. or L.	Remarks
1-B	183+52	20.8' R.	Connect with M.H. 1-M Exist' Culk.
2-B	188+50	17' R.	
3-B	188+50	17' L.	
TOTAL = 3			

MANHOLES - Standard I&B M.H. N° 1

Item N°	Station	Ft. to R.	Remarks
1-M	183+52	26	include 2' 15" pipe in M.H. Const.
2-M	185+60	22	
3-M	188+50	22	include 2' 12" pipe in M.H. Const.
4-M	192+20	22	
5-M	195+50	22	
TOTAL = 5			

STORM SEWERS

Item N°	Station From	Station To	Dist. on R. of #	Pipe for Storm Sewers Lin. Ft.
1-S	179+48	183+50	36' 26"	402
2-S	183+54	185+58	26' 22"	204
3-S	185+62	188+48	22'	286
4-S	188+52	192+18	22'	366
5-S	192+22	195+48	22'	326
6-S	195+52	201+22	22' 46"	570
TOTALS				728 1426

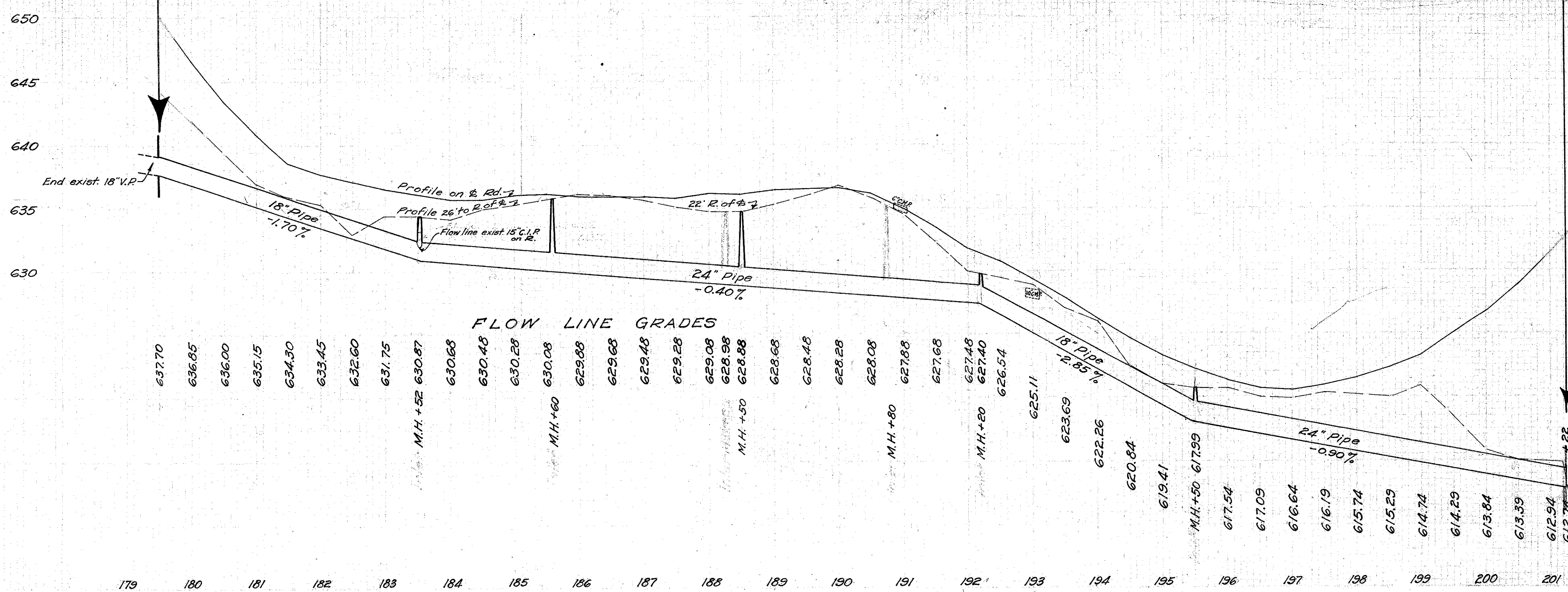

ESTIMATED QUANTITIES

CULVERT DATA
Type: Pipe
Size: 12" x 32'
Work Required: Build Std. 12" x 32' Pipe Culvert.

ESTIMATED QUANTITIES
Excavation 16 Cu. Yds.
12" Pipe for Culv. 32 Lin. Ft.

STRUCTURE 1-C
STATION 188+50

PLAN
12" PIPE CULVERT
16' x 16'

SECTION
12" PIPE CULVERT
Road surface
Elevations: 631.00, 630.50, 630, 635