

CALC. BY J.P.R.  
DATE 3/92  
CHKD. BY J.C.A.  
DATE 3/92

LAK - 174 - 2.90  
LAKE COUNTY

OHIO  
FHWA 5  
REGION

19  
26

PLAN NO. 12D10046

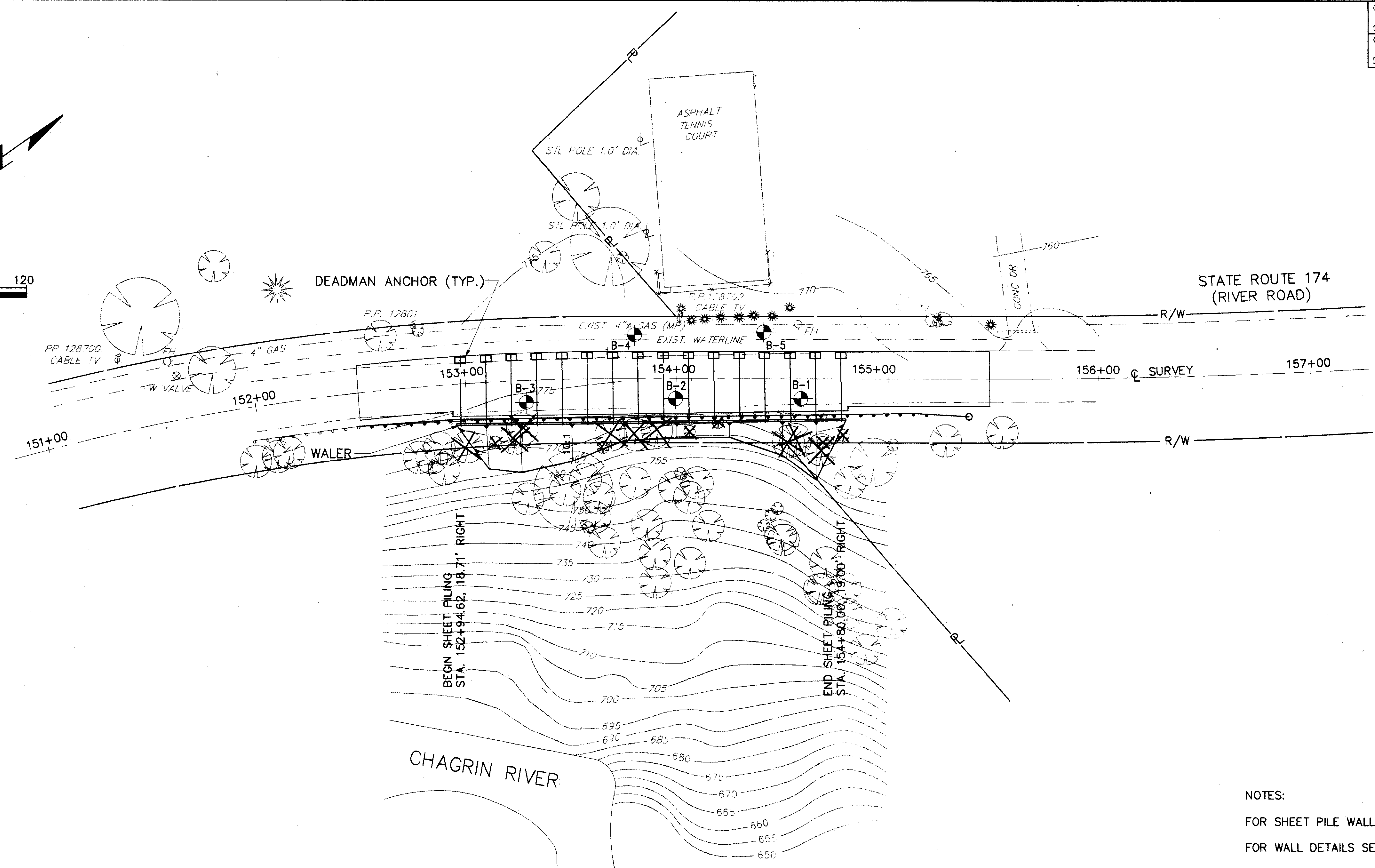
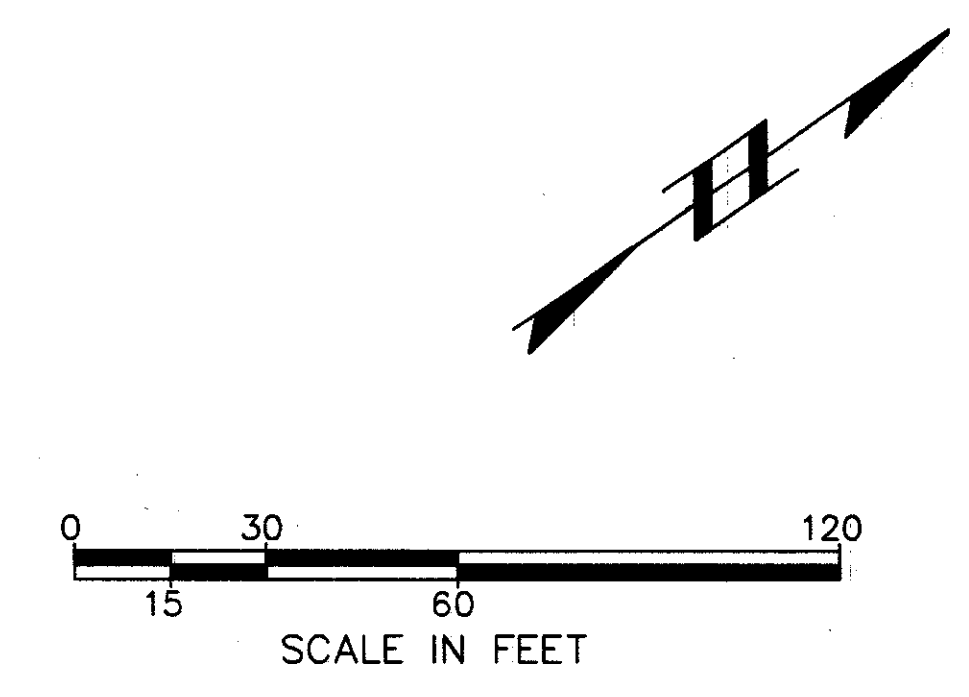

NOTES:  
FOR SHEET PILE WALL TYPICAL SECTION SEE SHEET NO. 2  
FOR WALL DETAILS SEE SHEETS NO. 20 AND 21  
FOR ELEVATION OF WALL SEE SHEET NO. 21  
FOR SOIL BORING LOGS SEE SHEETS NO. 25 & 26

GENERAL QUANTITIES FOR SHEET PILE WALL			
ITEM	QUANTITY	UNITS	DESCRIPTION
503	233	CU. YD.	UNCLASSIFIED EXCAVATION
504	6,440	SQ. FT.	STEEL SHEET PILING LEFT IN PLACE, AS PER PLAN
505	LUMP	LUMP	PILE DRIVING EQUIPMENT MOBILIZATION
507	1,136	LIN. FT.	STEEL PILES HP10X42
507	48	EACH	STEEL POINT
509	3574	POUND	REINFORCING STEEL, GRADE 60
511	32	CU. YD.	CLASS C CONCRETE, MISC.: DEADMEN ANCHOR
513	12,512	POUND	STRUCTURAL STEEL, AISC CATEGORY I, AS PER PLAN
518	126	CU. YD.	POROUS BACKFILL WITH FILTER FABRIC

THESE QUANTITIES CARRIED TO GENERAL SUMMARY SHEET NO. 9