

PLAT OF SURVEY
FOR
**CAPRA HOMES
LLC**

35181 ROBERTS ROAD
SITUATED IN THE CITY OF
EASTLAKE, COUNTY OF
LAKE AND STATE OF OHIO
KNOWN AS BEING A PART
OF LOT 1, CARD TRACT
BASIS OF BEARINGS
ARE TO ASSUMED MERIDIAN ALONG
CENTERLINE OF **ROBERTS ROAD**
N89°16'00"E.

IPS=ALL IRON PINS SET 5/8"X30"
REBAR WITH
CAP "P.J.K. 7249"
DH SET = DRILL HOLE SET

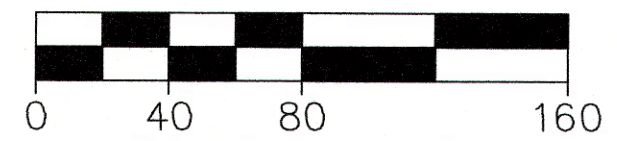

SCALE 1" = 40'

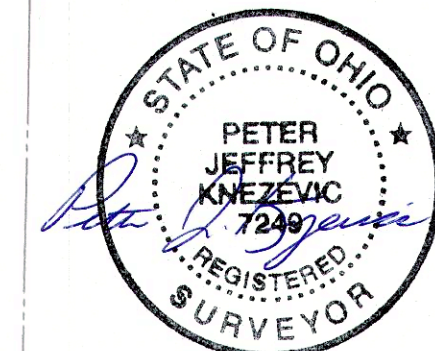

8-24-2017

SURVEYOR'S CERTIFICATION

I HEREBY CERTIFY THAT THIS PLAT WAS
PREPARED FROM FIELD SURVEY MADE UNDER MY
DIRECT SUPERVISION. MONUMENTS WERE FOUND
OR SET AS INDICATED. DIMENSIONS ARE
EXPRESSED IN FEET AND DECIMAL PARTS
THEREOF. BEARINGS REFER TO ASSUMED MERIDIAN
ALONG THE CENTERLINE OF ROBERTS ROAD. ALL
OF WHICH ARE CORRECT TO THE BEST OF MY
KNOWLEDGE AND BELIEF. THIS PLAT WAS
PREPARED IN ACCORDANCE WITH THE PROVISIONS
OF CHAPTER 4733-37 OF THE OHIO
ADMINISTRATIVE CODE, AUG 2017.

BY:
PETER J. KNEZEVIC
REGISTERED SURVEYOR #7249
8990 RIVERWOOD WAY
KIRTLAND, OH 44094
(440) 479-6834

