

OVERALL PARCEL
353,630 sq. ft.
8.1182 acres

LAWRENCE & TERRI ANDREWS
PP#31-A-009-I-00-003-0
DOC#970045955

CLEVELAND AUDUBON SOCIETY
PP#31-A-009-0-00-006-0
DOC#97023505

ANN MEKO
PP#31-A-009-I-00-001-0
VOL. 634, PAGE 468

ANN MEKO
PP#31-A-009-I-00-002-0
VOL. 634, PAGE 468

THOMAS & FLORENCE SMITH
PP#31-A-009-H-00-001-0
VOL. 763, APGE 541

DEAN SHUMAKER TRUST
PP#31-A-009-H-00-002-0
DOC#960007557

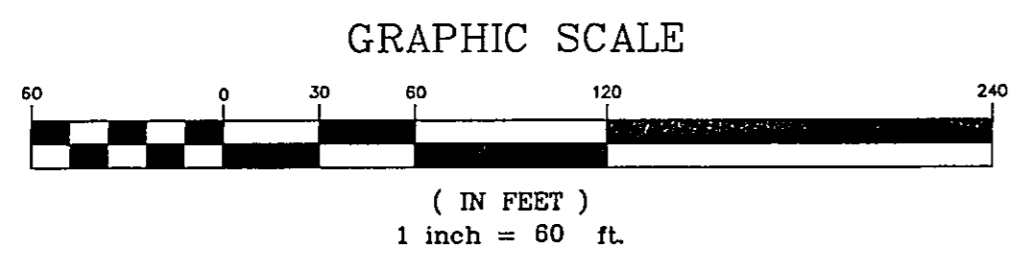

BEARINGS ARE TO AN ASSUMED MERIDIAN
AND ARE USED TO DENOTE ANGLES ONLY

REFERENCES:

STATE ROUTE 6 CENTERLINE & R/W RECORDS
LAK-6-3.60-3.76
LAK-174-1.50-154

SURVEY BY J.M. CRABBS P.S.#387
DATED SEPTEMBER, 1945

SURVEY BY AZTECH ENGINEERING & SURVEYING
DATED MAY, 2005

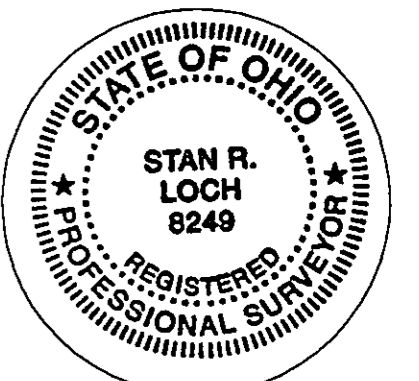

I CERTIFY THAT I HAVE SURVEYED
THE PREMISES AND PREPARED THE
SURVEY MAP IN ACCORDANCE WITH
THE PROVISIONS OF CHAPTER 4733-37
OF THE OHIO ADMINISTRATIVE CODE.

Stan Loch 5-26-06
STAN LOCH DATE
REG SURVEYOR #8249

38879 MENTOR AVENUE SUITE A
WILLOUGHBY OHIO 44094
440-602-9071



ENGINEERING and SURVEYING
Civil Engineering · Land Surveying

SHEET CONTENT

LOT CONSOLIDATION
SURVEY FOR
ANN MEKO
PP#31-A-009-I-00-001-0
& PP#31-A-009-I-00-002-0
PART OF LOT 8, TRACT 5
CITY OF WILLOUGHBY
HILLS
COUNTY OF LAKE
STATE OF OHIO
MAY 24TH, 2006

REVISIONS			
NO	DATE	DESCRIPTION	BY
1	5/26/06	REVISED PER COUNTY	CL

HORIZ. SCALE 1" = 60'	VERT. SCALE
DRAWN BY CL	DATE 5/24/06
CHECKED BY SRL	DRAWING NO 161848
JOB NO 161848	SHEET 1 OF 1