



REV. ANTHONY M. PILLA
29412 WHITE RD
No. 970012704
31A-5D-20

STANLEY & FRANCES MRVA
3014 ROCKEFELLER RD
VOL. 875 - PG. 791
31A-5D-11

1.033 Ac.
HARLEY A MOORE TR.
No. 200034987
31A-5D-10

NICHOLAS M. BOZICKOVICH
3020 ROCKEFELLER RD
No. 200026317
31A-5D-9

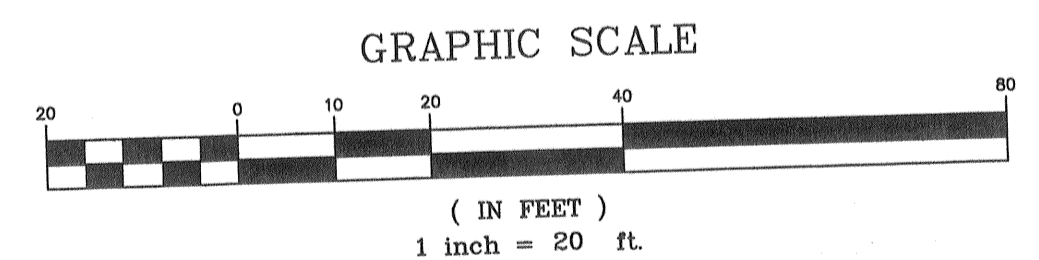
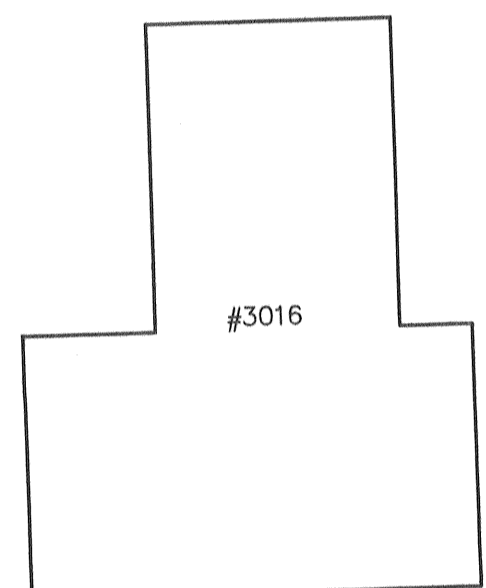

LAKE COUNTY
CUYAHOGA COUNTY

Bearings are based upon the centerline of Rockefeller Road being South 14°26'30" East and are used to describe angles only.

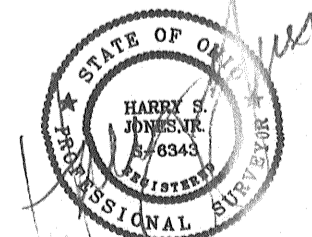

REV NO.	DESCRIPTION	DATE	BY	CHK'D

bj BABCOCK, JONES AND ASSOCIATES, INC
CIVIL ENGINEERS - SURVEYORS - LAND PLANNERS
PAINESVILLE OHIO 44077

DATE	4/25/05
DESIGN BY	H.J.
DRAWN BY	B.P.
APPROVED BY	H.J.
CREW CHIEF	W.B.

PLAT OF SURVEY
FOR
HARLEY MOORE
3016 ROCKEFELLER ROAD (P.P.#31A-5D-10)
LAKE COUNTY STATE OF OHIO

SCALE	1"=20'
JOB NO	83-147
SHEET	OF
1	1