

Plat of Survey

for

Amy Koudela

29745 Franklin Ave.

Part of Lloyd Lot, Tract No. 12

Wickliffe - Lake County - Ohio

July 2020 Scale 1"=40'

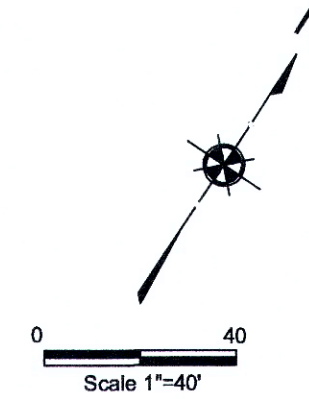

☪ TALMADGE ROAD
Vol. P, Pg. 2

Vol. L, Pg. 35

Vol. J, Pg. 94

☪ FRANKLIN AVENUE - 50'

JIMMY & MICHELLE
WHITNEY
2017R010107
29A-2N-37

KAYLA HAUSER
2019R031742
29A-2N-36

CURT ECKERTSON
2011R020507
29A-2N-35

SHIRLEY GRUDEN
2003R043328
29A-2N-26

AMY KOUDELA
2010R008075
29A-2N-27

THOMAS & CYNTHIA
SMITH
2018R026883
29A-2N-28

TOTAL 0.689 AC.
-RW 0.072 AC.
NET 0.617 AC.

NOTES:

This plat was prepared without the benefit of an abstract of title and is subject to any state of facts revealed by a examination of the same.

Documents used in preparation of this survey are cited on the plat.

Occupation is consistent with the title lines except where noted on survey.

Size of monumentation found or set is noted on plat.

All iron pins set are 5/8" x 30" and are capped S. LANDGRAF PLS 8085

Bearings are based upon the centerline of Franklin Ave. as being North 56°06'00" East and are used to describe angles only.

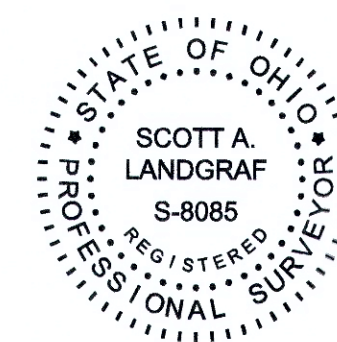

Scott A. Landgraf
Scott A. Landgraf P.S. #8085 Date 7/15/20

REVISIONS			Jones Surveying, LLC	
NO.	DATE	BY	SCALE	PHONE NO.
1		CAD	1"=40'	440-357-1811
2		CAD		
3		DRAWN BY GMB	DATE 7/15/2020	DRAWING NO. 20-181
4		CHKD. HSJ	APPD	
5		CREW CHIEF		



ENGINEERS - SURVEYORS - PLANNERS
1924 MENTOR AVE., PAINESVILLE, OHIO
(PH.) 440-357-1811 (FAX) 440-357-9173
(E-MAIL) tjonessurveying@yahoo.com