

*Boundary Survey  
for  
Mary E. Filidoro*

M.E. Filidoro  
Instrument #2006R002842  
(29A-21-11)

Part of Original Lot 3, Tract 12  
City of Wickliffe  
County of Lake, State of Ohio  
July 11th, 2006

THE BOUNDARY SURVEY PLAT WAS DRAWN ON JULY 11th, 2006

This Boundary Survey has been prepared in accordance with Chapter 4733-37, Ohio Administrative Code for Minimum Standards for Boundary Surveys as adopted 2-15-90. This survey was performed under my supervision, and is believed to be correct and accurate to the best of my knowledge.

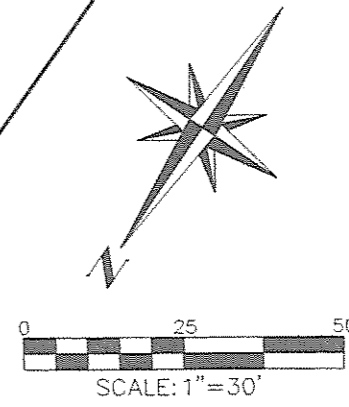

W. & F. Gruszka (Trustees)  
Gruszka Family Revocable Living Trust, UAD  
Instrument #200005593  
(29A-21-9)

*Lot Balance*  
0.257 Acres.  
11204.7 Sq.ft.

G.M. & L.R. Kita  
Instrument #2004R018370  
(29A-21-10)

N.R. & M. Doljac  
Vol. 892, Pg. 780  
(29A-21-3)

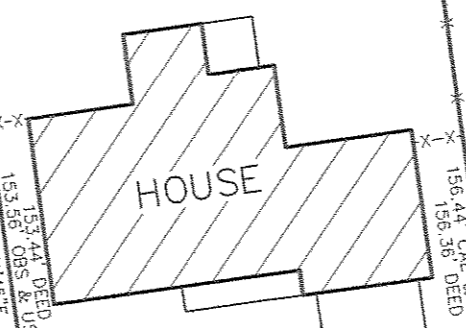

Talmadge Avenue-50'

Elmwood Avenue-60'

Grand Boulevard-60'

N. Elmwood Ave.-60'

NOTES

BASIS OF BEARINGS IS N56°06'00"E AS REFERRED TO IN GRAND BOULEVARD SUBDIVISION PLAT, AS RECORDED IN VOL. 6, PG. 40, LAKE COUNTY PLAT RECORDS.  
RECORDS INCLUDING DEEDS CITED ON EACH PARCEL ALONG WITH COUNTY ROAD RECORDS, WERE USED AS REFERENCE DOCUMENTS AND SOURCES OF DATA.  
ALL IRON PINS SET ARE 5/8" DIA x 30" LONG REBAR WITH A REGISTRATION CAP MARKED AS "AAA #7794"

*Lot Summary*

Lot	Gross Ac.	R/W Ac.	Net Ac.
Lot Balance	0.257 Acres. 11204.7 Sq.ft.	—	0.257 Acres. 11204.7 Sq.ft.

7-11-06  
KEITH B. JONES  
REGISTERED LAND SURVEYOR #7794  
AAA Land Surveying, Inc.  
100 Center Street, Suite 150  
Chardon, OH 44024  
(440) 286-2393

Drawing No. 06-090