

MAP OF SURVEY
FOR
30510 LAKELAND BOULEVARD

KNOWN AS BEING PART OF ORIGINAL WILLOUGHBY TOWNSHIP LOT 8, TRACT 11, PART OF ORIGINAL WILLOUGHBY TOWNSHIP LOT 11, TRACT 11, AND PART OF ORIGINAL WILLOUGHBY TOWNSHIP LOT 4, TRACT 15, NOW SITUATED IN THE

**CITY OF WILLOWICK
AND CITY OF WICKLIFFE**
COUNTY OF LAKE - STATE OF OHIO

McSteen
LAND SURVEYORS
1415 East 286th Street Wickliffe, OH 44092
Phone: 440.585.9800 www.mcsteen.com

THIS SURVEY IS A BOUNDARY SURVEY PREPARED IN ACCORDANCE WITH CHAPTER 4733-37, OHIO ADMINISTRATIVE CODE. DISTANCES ARE GIVEN IN FEET AND DECIMAL PARTS THEREOF. ALL IRON PINS SHOWN AS SET ARE 30" LONG 5/8" REBAR WITH AN IDENTIFICATION CAP STAMPED "MCSTEEN CA 02236".

K.R.D.
KYLE R. DANALS REG. PROF. SURV. No. 8704
Job No.: 20-164
Field Date: October 6, 2020
Survey Date: October 15, 2020
Drawn By: TEE

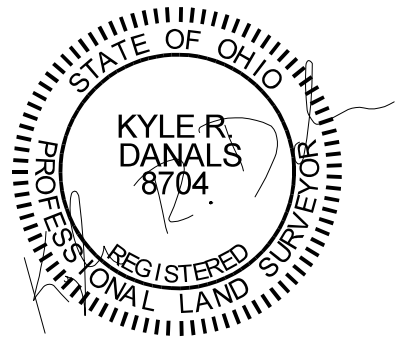

PPN 28-A-888-0-00-100-0
THE CLEVELAND ELECTRIC ILLUMINATING COMPANY
DEED VOL. 179, PG. 467 L.C.D.R.
05/08/1941
4.88 ACRE REC.

BASIS OF BEARINGS

THE BASIS OF BEARINGS FOR THIS SURVEY ARE FROM GNSS OBSERVATIONS TO THE OHIO STATE PLANE COORDINATES SYSTEM, NORTH ZONE, NAD83 (2011) DATUM DERIVED THROUGH THE O.D.O.T. V.R.S. NETWORK.

REFERENCES

- DOCUMENTS AS LISTED ON THIS PLAT
- PLAT VOLUME N PAGE 46 OF LAKE COUNTY RECORDER'S RECORDS
- LAKE COUNTY R/W PLANS FOR S.H. 3 SEC WICKLIFFE WILLOWICK, WILLOUGHBY TWP, WILLOUGHBY ON FILE AT THE LAKE COUNTY ENGINEER'S OFFICE
- ST. CLAIR STREET EXTENSION ROAD RECORD C, PAGE 161 LAKE COUNTY ENGINEER'S RECORDS
- SURVEY 28-A-023-0-00-022 OF LAKE COUNTY TAX MAP OFFICE SURVEY RECORDS
- SURVEY 29-A-001-M-00-016 OF LAKE COUNTY TAX MAP OFFICE SURVEY RECORDS

SIGNIFICANT OBSERVATIONS

- ▲ A GUARD RAIL EXTEND OVER THE WESTERLY LINE OF THE SURVEYED PROPERTY BY APPROXIMATELY 0.3 FEET.
- ▲ GRAVEL EXTENDS OVER THE EASTERLY LINE OF THE SURVEYED PROPERTY BY APPROXIMATELY 2.6 FEET.

- LEGEND**
- ⊗ AXLE FOUND AS NOTED
 - ⊗ DRILL HOLE FOUND AS NOTED
 - ⊗ DRILL HOLE SET
 - REBAR FOUND AS NOTED
 - ⊗ 5/8" DIAMETER X 30" LONG REBAR WITH "MCSTEEN CA 02236" ID CAP SET
 - ⊗ MAG NAIL FOUND AS NOTED
 - ⊗ MAG NAIL SET
 - ⊗ MONUMENT BOX FOUND AS NOTED
 - EMPTY MONUMENT BOX FOUND
 - PIPE FOUND AS NOTED
 - RAILROAD SPIKE FOUND AS NOTED
 - RAILROAD SPIKE SET
 - SPINDLE FOUND AS NOTED
 - STONE FOUND AS NOTED
 - ⊗ WOODEN LATHE SET
 - ⊗ X-CUT FOUND AS NOTED
 - CENTERLINE
 - R/W RIGHT-OF-WAY
 - CALC. CALCULATED DISTANCE OR ANGLE
 - REC. RECORD DISTANCE OR ANGLE
 - FD. FOUND
 - MON. MONUMENT
 - MSD. MEASURED
 - L.C.M.R. LAKE COUNTY MAP RECORDS
 - L.C.D.R. LAKE COUNTY DEED RECORDS
 - O.D.O.T. OHIO DEPARTMENT OF TRANSPORTATION

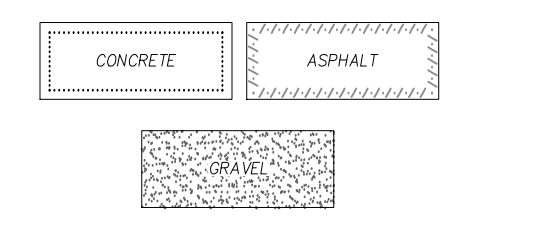

- (C1)**
- Δ = 7°08'46" CALC. & USED
7°08'30" REC.
 - R = 3,262.48' REC. & USED
 - A = 406.91' MSD. & USED
406.65' REC.
 - T = 203.72' CALC.
 - CH = 406.54' MSD. & USED
 - BRG = N 55°19'24" E

