

RESURVEY & COMBINING OF LANDS

ALL THAT CERTAIN LAND SITUATE IN LOTS 10 AND 23 IN THE GORE, AND LOT 124, NOW IN THE CITY OF WILLOUGHBY, TOWNSHIP NUMBER 10 NORTH, RANGE X WEST, IN THE CONNECTICUT WESTERN RESERVE SURVEY, COUNTY OF LAKE, STATE OF OHIO. A RESURVEY & COMBINING OF THE LANDS TO THE ANDREWS SCHOOL FOR GIRLS, INC., AS RECORDED IN DEED VOLUMES 53, PAGE 370 AND VOLUME 54, PAGE 593, PPN'S ██████████, 27B-37A-002, 27B-37A-003 AND 27B-039-024, IN THE OFFICE OF THE COUNTY RECORDER.

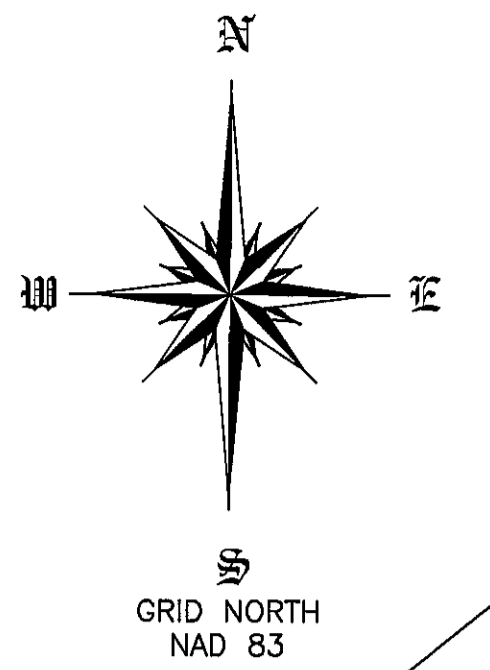

(NYC & ST. LOUIS)
NORFOLK & WESTERN RY. CO.

24.9303 ACRES
TOTAL COMBINED

U.S. ROUTE 20 - MENTOR AVENUE

U.S. ROUTE 20 - MENTOR AVENUE - VARIABLE WIDTH

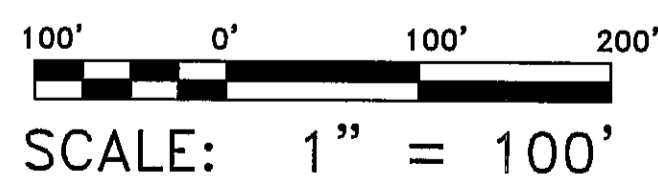

THIS SURVEY WAS PERFORMED TO AN ACCURACY AS SET FORTH IN THE 1999 OHIO ADMINISTRATIVE CODE 47.33-37

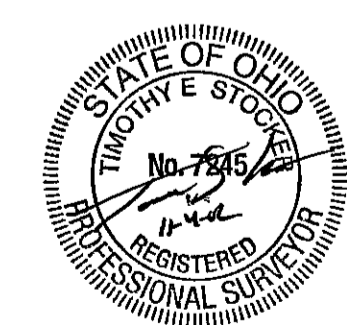

TIMOTHY E. STOCKER, P.S. 7245

DATE OF ORIGINAL:	OCTOBER 28	2002
REVISION:	CORRECTIONS	DATE: NOVEMBER 1, 2002
REVISION:		DATE: _____, 2002

CSS CRABBS' SURVEYING SERVICE 10 WEST ERIE STREET, SUITE 101 PAINESVILLE, OHIO 44077 1-800-488-3968	PREPARED FOR ANDREWS SCHOOL FOR GIRLS
	PROJECT NAME RESURVEY & COMBINING OF LANDS
CHK T STOCKER DRN S LOVEJOY	JOB 3196 PAGE 1 OF 1

