

**SURVEYOR STATEMENT**

I HEREBY CERTIFY THAT I HAVE SURVEYED THE PREMISES AND PREPARED THE ATTACHED PLAT IN ACCORDANCE WITH THE PROVISIONS OF CHAPTER 4733-37 OF THE OHIO ADMINISTRATIVE CODE AND THE DIMENSIONS OF THE LOTS AND ROAD ARE IN FEET AND DECIMAL PARTS THEREOF, ALL OF WHICH ARE CORRECT TO THE BEST OF MY KNOWLEDGE AND BELIEF. IRON MONUMENTS OR PINS AS INDICATED WERE FOUND OR SET AS SHOWN HEREON. THE TERM CERTIFY AS USED IN THIS STATEMENT IS UNDERSTOOD TO BE THE PROFESSIONAL OPINION OF THE SURVEYOR WHICH IS FORMULATED ON HIS BEST KNOWLEDGE, INFORMATION AND BELIEF, AND AS SUCH, IT DOES NOT CONSTITUTE A GUARANTEE OR WARRANTY, EITHER EXPRESSED OR IMPLIED.

*Daniel Laux*  
DANIEL LAUX P.S. #7087 DATE: 09/12/2013

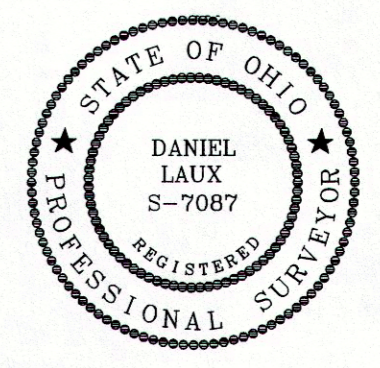

**BASIS OF BEARINGS**

THE BEARINGS USED HEREON ARE BASED ON THE CENTERLINE OF RIVER STREET AS SHOWN ON THE PLAT OF SURVEY FOR THE CLEVELAND TRUST COMPANY DATED JULY 25, 1939.

**BOUNDARY SURVEY LEGEND**

- 5/8" IRON PIN SET
  - IRON PIN/PIPE FOUND
  - M MON BOX FOUND WITH PIN/PIPE
  - MONUMENT BOX FOUND EMPTY
  - ▲ SURVEY NAIL SET
  - △ SURVEY NAIL FOUND
  - STONE MONUMENT FOUND
- A, ACT. ACTUAL MEASUREMENT OR CALCULATION  
 U, USED USED MEASUREMENT OR MONUMENT  
 M, MSD MEASURED  
 D, R, REC. DEED OR RECORD  
 CALC. CALCULATED  
 C/L CENTERLINE  
 O, OBS. OBSERVED  
 P.P.N. PERMANENT PARCEL NUMBER

**SURVEY REFERENCES**

- Lake County Recorder
- Lake County Auditor
- Lake County Plats and Surveys
- Lake County Tax Map

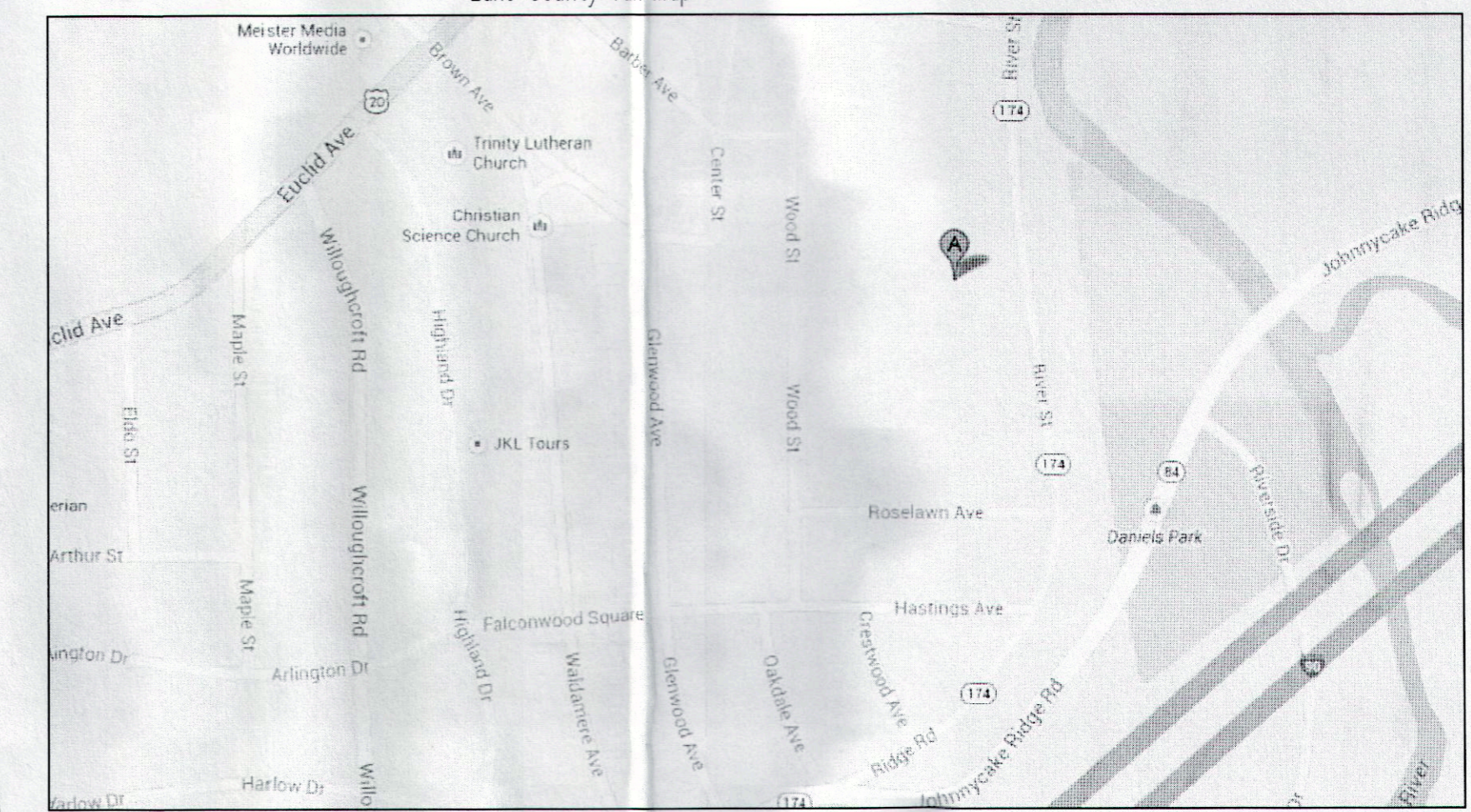

TONJA SCHLEICHER  
27-A-019-0-00-012-0  
4660 River Street-Willoughby-Ohio

POLARIS ENGINEERING & SURVEYING, INC.  
34600 CHARDON ROAD - SUITE D  
WILLOUGHBY HILLS, OHIO 44094  
(440) 944-4433 (440) 944-3722 (Fax)  
www.polaris-es.com

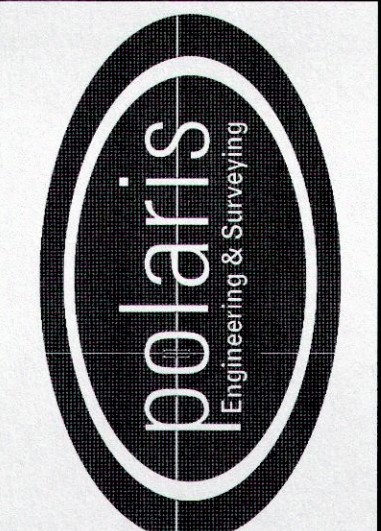

PLAT OF LOT SPLIT  
Situated in the City of Willoughby, County of Lake and the State of Ohio and known as being part of Original Willoughby Township Lots 2 and 3, Tract 13.

CONTRACT No. 13080	
SHEET 1	OF 1