

ORIGINAL - 14.083 AC.
 + LOT SPLIT - 0.141 AC.
 BALANCE - 14.224 AC.
 -R/W - 0.098 AC.
 NET - 14.126 AC.

ORIGINAL - 3.243 AC.
 - LOT SPLIT - 0.141 AC.
 BALANCE - 3.102 AC.
 -R/W - 0.097 AC.
 NET - 3.005 AC.

LOT SPLIT - 0.141 AC.
 -R/W - 0.001 AC.
 NET - 0.140 AC.

I hereby certify that this plat was prepared from a field survey made under my direct supervision. Monuments were found or set as indicated. Dimensions are expressed in feet and decimal parts thereof. All of which are correct to the best of my knowledge and belief. This plat was prepared in accordance with the provisions of Chapter 4733-37 of the Ohio Administrative Code. All Iron Pins Set are 5/8" x 30" long rebar and capped "H. Jones - 6343".

Harry S. Jones Jr.
 Harry S. Jones Jr. P.S. #6343

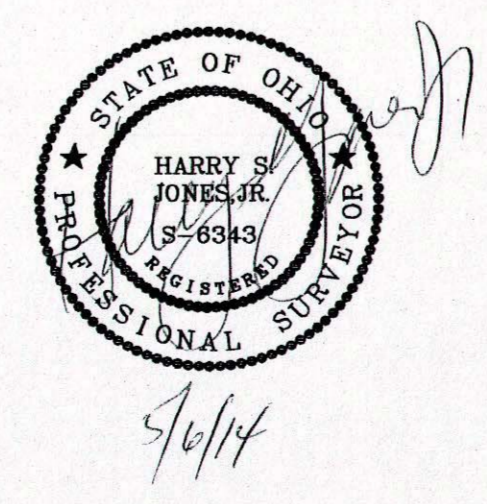

Revisions

MINOR SUBDIVISION
THOMAS GREIG
 CITY OF KIRTLAND - LAKE COUNTY - OHIO
 LOT No. 9 TRACT No. 2

Date: 5/5/14
 Scale: Hor. 1"=60'
 Vert. _____
 Filename: 14-027
 Tab Name: 1
 Computer: S

Jones Surveying, LLC
 ENGINEERS - SURVEYORS - PLANNERS
 1924 MENTOR AVE., PAINESVILLE, OHIO
 (PH.) 440-357-1811 (FAX) 440-357-9173
 (E-MAIL) hjonessurveying@yahoo.com

Sheet / Of
 1 / 1
 Contract No.
 14-027