

SITUATED IN THE CITY OF KIRTLAND, TOWNSHIP 9 NORTH, RANGE IX WEST, IN THE CONNECTICUT WESTERN RESERVE, COUNTY OF LAKE AND STATE OF OHIO AND KNOWN AS BEING PART OF LOT 45, TRACT 1 AND PART OF LOT 11, TRACT 2 AND BEING SUBLOT 23 AND SUBLOT 25 OF THE NORTH SECTION OF TEMPLE VIEW ALLOTMENT, RECORDED PLAT, VOLUME F, PAGE 71 LAKE COUNTY RECORD OF PLATS.  
 BEARINGS USED HEREIN ARE BASE ON THE NORTH LINE OF TEMPLE VIEW ALLOTMENT AT N 86°25'00" W TO DENOTE ANGULAR RELATIONSHIP ONLY AND DO NOT REPRESENT TRUE NORTH

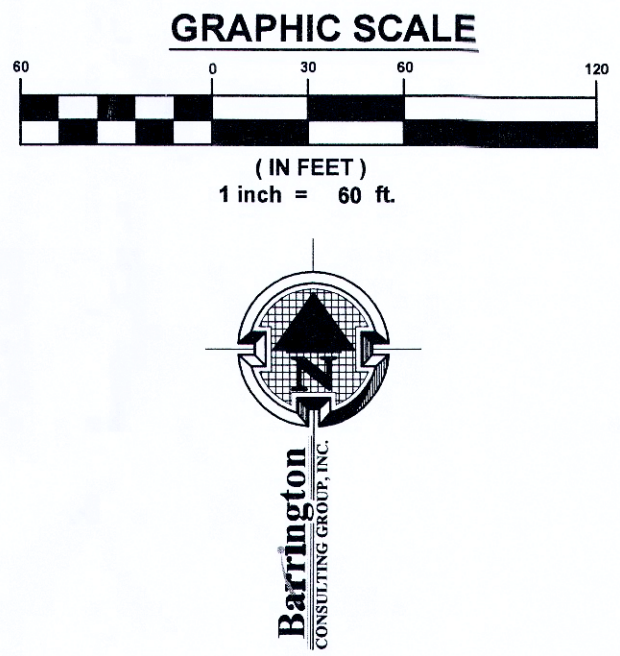

**CERTIFICATION:**  
 I HEREBY CERTIFY THAT AN ACTUAL BOUNDARY SURVEY WAS PREPARED BY ME ON THE 3rd DAY OF JULY, 2018, AND THAT THE SURVEY IS IN ACCORDANCE WITH THE OHIO REVISED CODE CHAPTER 4733-37, MINIMUM STANDARDS FOR BOUNDARY SURVEYS IN THE STATE OF OHIO. PERMANENT MONUMENTS WERE FOUND, OR SET AT ALL LOCATIONS SHOWN HEREON. ALL DIMENSIONS GIVEN ARE EXPRESSED IN FEET OR DECIMAL PARTS THEREOF. BEARINGS ARE TO AN ASSUMED MERIDIAN AND ARE SHOWN TO INDICATE ANGLES ONLY. ALL PINS SET ARE 5/8" DIA., 30" LONG REBAR WITH CAP MARKED "NOVAK 7507".

I HEREBY CERTIFY THAT, THIS PLAT WAS PREPARED BY ME AND IS CORRECT TO THE BEST OF MY KNOWLEDGE, INFORMATION AND BELIEF.  
 DWN 10/2/2018  
 DAVID W. NOVAK, P.S. No. 7507

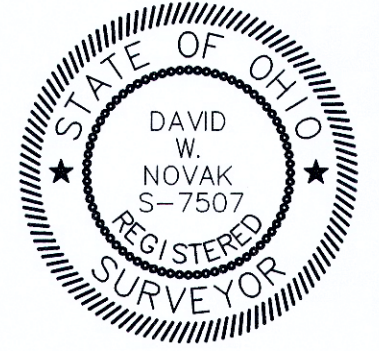

REVISIONS	BY

**Barrington**  
 CONSULTING GROUP, INC.  
 9114 TYLER BLVD., MENTOR, OHIO 44060  
 PHONE 440.205.1260 FAX 440.205.1262  
 www.BarringtonCGI.com

Welcome Home of Northeast Ohio, LLC  
**KURT KLUZNIK**  
 1447 NORTH RIDGE ROAD  
 PAINESVILLE TWP., OH 44077  
 440.357.8400

**BOUNDARY SURVEY**  
 9360 NORTH STAR ROAD  
 KIRTLAND, OH 44094

DRAWN DWN
CHECKED DWN
DATE OCT 2, 2018
SCALE 1" = 60'
JOB NO. 18010
SHEET 11