

C 1
 A=226.61' DEED
 R=1387.147' DEED
 $\Delta=9^{\circ}21'37''$
 N $08^{\circ}57'05''$ W
 C=226.36'
 T=113.55'

C 2
 A=100.23' DEED OBS
 R=1412.147' DEED
 $\Delta=4^{\circ}04'00''$
 N $15^{\circ}45'00''$ W
 C=100.21'
 T=50.14'

LOT SPLIT & COMBINATION OF LANDS

ALL THAT CERTAIN LANDS SITUATE IN LOT 5, TRACT 10, AND LOT 2, TRACT 14, CITY OF MENTOR, TOWNSHIP NUMBER 10 NORTH, RANGE IX WEST, IN THE CONNECTICUT WESTERN RESERVE SURVEY, COUNTY OF LAKE, STATE OF OHIO. A LOT SPLIT TAKEN FROM THE LANDS TO PAMELA R. MALONE, AS RECORDED IN DOCUMENT NUMBER 2020R012695, (PPN 16-D-118-A-00-004-0), TO BE COMBINED WITH THE LANDS TO KEITH C. ALBERT, AS RECORDED IN DOCUMENT NUMBER 2021R018185, (PPN 16-D-118-A-00-003-0), PAMELA R. BLEDSOE-MALONE, AS RECORDED IN DOCUMENT NUMBER 2022R008795, (PPN 16-D-118-A-00-009-0), AND MARK F. RAWLEY, AS RECORDED IN DOCUMENT NUMBER 2012R001319, (PPN 16-D-118-A-00-005-0), IN THE OFFICE OF THE COUNTY RECORDER.

S/L 106 #9620 J.J. & C.B. GRASSO DOC. 2019R015501 PPN 16-D-118-B-00-016-0	S/L 111 #9576 D.W. & S.A. HARBER DOC. 2005R036655 PPN 16-D-118-B-00-021-0
S/L 107 #9616 J.R. HAYDEN DOC. 2011R029031 PPN 16-D-118-B-00-017-0	S/L 112 #9572 D.J. OCONNELL & W.A. GEER DOC. 2000R047007 PPN 16-D-118-B-00-022-0
S/L 108 #9610 R. GRIFFITH DOC. 2012R026890 PPN 16-D-118-B-00-018-0	S/L 113 #9566 J. & J. MILLER DOC. 2020R009621 PPN 16-D-118-B-00-023-0
S/L 109 #9606 R., JR & V. WHITE DOC. 2011R019078 PPN 16-D-118-B-00-019-0	S/L 114 #9562 M.G., IV & H.K. CRAFFEY DOC. 2001R033713 PPN 16-D-118-B-00-024-0
S/L 110 #9586 D.R. & B.H. QUICK DOC. 2013R015177 PPN 16-D-118-B-00-020-0	

ACREAGE SUMMARY

PPN 16-D-118-A-00-004-0	0.5351 AC ORIGINAL
- 0.2297 AC SPLIT	
- 0.1135 AC SPLIT	
=	0.1919 AC SPLIT
PPN 16-D-118-A-00-003-0	0.8276 AC ORIGINAL
+ 0.1919 AC SPLIT	
=	1.0195 AC COMBINED
PPN 16-D-118-A-00-009-0	0.5741 AC ORIGINAL
+ 0.2297 AC SPLIT	
=	0.8038 AC COMBINED
PPN 16-D-118-A-00-005-0	0.5736 AC ORIGINAL
+ 0.1135 AC SPLIT	
=	0.6871 AC COMBINED

THIS SURVEY WAS PERFORMED TO AN ACCURACY AS SET FORTH IN THE 2003 OHIO ADMINISTRATIVE CODE 4733-37.

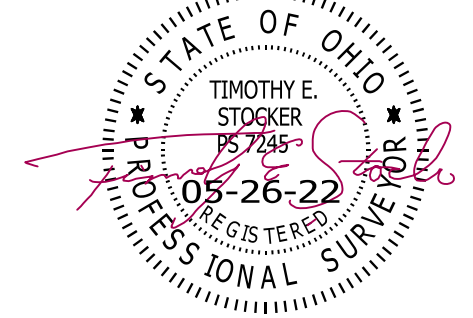

TIMOTHY E. STOCKER, P.S. 7245



SCALE: 1" = 60'
 SURVEY: MAY 15, 2022
 MAP: MAY 26, 2022

LEGEND

●	IRON PIN FOUND/SET
⊙	IRON PIPE
□	STONE MONUMENT
⊗	MONUMENT BOX
⊕	P.K. NAIL FOUND/SET
○	DRILL HOLE FOUND
CALC	CALCULATED
MEAS	MEASURED
OBS	OBSERVED
DEED	DEED RECITED
PLAT	PLAT RECITED

NOTES & REFERENCES

- ALL IRON PIN SET ARE 5/8" X 30" REBAR WITH CAP "CRABBS 7245".
- DEEDS OF RECORD
- SURVEY BY CRABBS' SURVEYING FOR MALONE, DATED NOV 2020, JOB 7983
- OCCUPATION AGREES WITH TITLE LINES AS PREVIOUSLY MONUMENTED EXCEPT AS SHOWN ON THIS PLAT

ITEMS OF INTEREST

NOTE 1: SUBJECTS BLACKTOP DRIVE IS OVER THE LINE 2.4'

PREPARED FOR: ALBERT BLEDSOE-MALONE RAWLEY	PROJECT NAME: LOT SPLIT & COMBINATION OF LANDS	PROJECT ADDRESS: 9579, 9587 & 9593 LAKE SHORE BOULEVARD MENTOR, OHIO
	PROJECT LOCATION: LAKE COUNTY, OHIO	JOB NUMBER: 8678
FOR INQUIRIES CONCERNING THIS SURVEY CONTACT:		CHK: T. STOCKER
CSS CRABBS' SURVEYING SERVICE P.O. BOX 908 PAINESVILLE, OHIO 44077 440-466-2025		DRN: S. HUPERTZ REV:
PAGE 1 OF 1		

