

16C-78-5

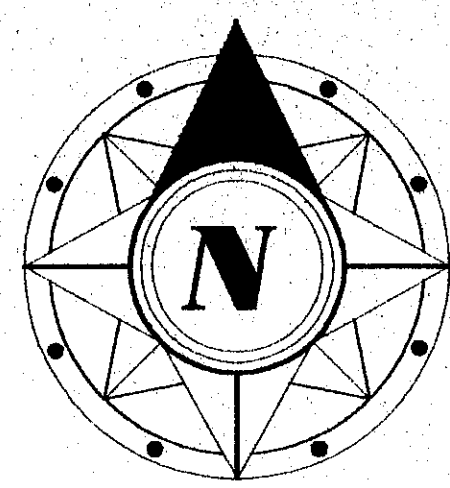
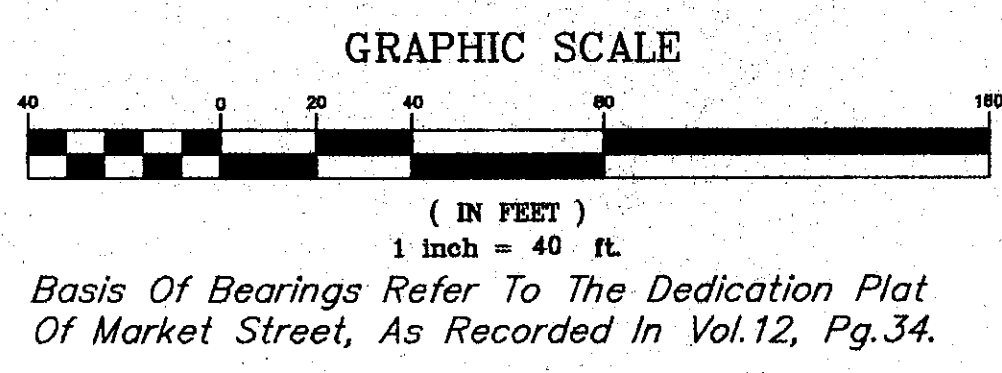
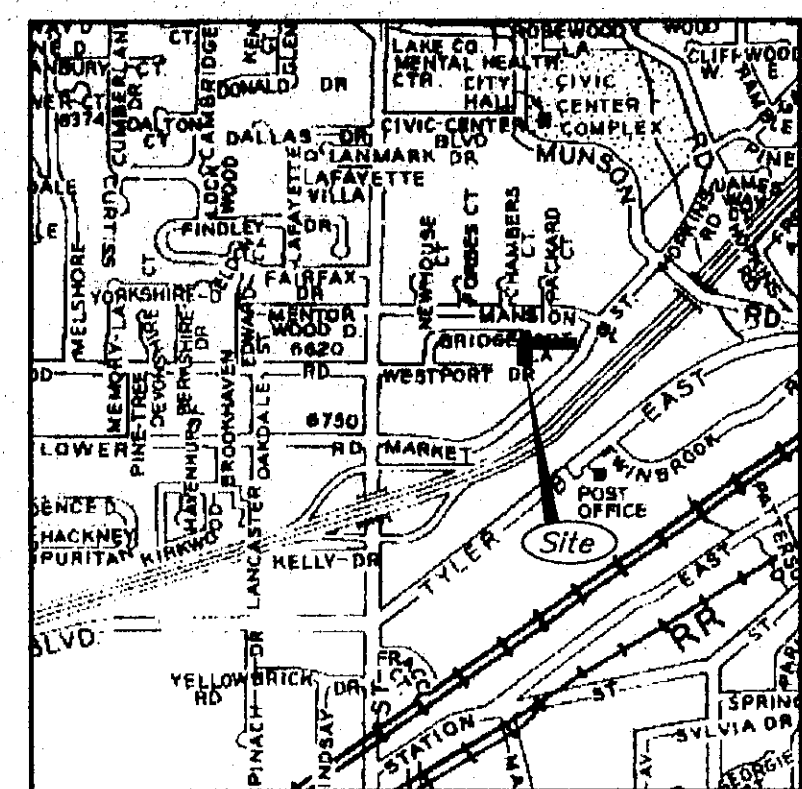

MELDON MANSIONAIRE SUBDIVISION VOL 14, P.G. 9

Mansion Blvd. 60'

TRACT 7 LOT 5
TRACT 8 LOT 4

L Curve Data
Delta=46°05'54"
Rad=300.00'
Arc=241.37'
Ch.=234.91'
N 23°43'38" E

Vicinity Map (N.T.S.)

Center Street (S.R. 615)

BRIDGEPORT CONDOMINIUMS
VOL. 6, PAGE 14-2

Westport Drive 60'

Market Street (Width Varies)
(Dedicated in Vol.12, Pg.34 L.C.P.R.)

P.P.N. 16C-78-5
The Laketran Board Of Trustees
Doc.#200103461
1-30-01
5.9701 Acres(Calc.From Survey)

P.P.N. 16C-78-21
Outback Steakhouse Of Florida, Inc.
Doc.#200000383
1-4-00

P.P.N. 16C-78-6
Edens & Avant
Holdings LLC
Doc.#990005797
2-5-99

LEGEND

- Iron Pin Found
- Iron Pipe Found
- ⊙ Iron Pin Set
- ⊞ Monument Box Found
- Monument Box Empty
- ▲ PK Set
- △ PK Found
- ⊙ Stone Found
- ⊕ Drill Hole Found
- ⊖ Drill Hole Set
- Horizontal Control Point
- ⊙ Vertical Control Point
- ⊞ Hub Found
- ⊞ Hub Set
- ⊞ Railroad Spike Found
- ⊞ Railroad Spike Set
- Meas. = Measured
- Plat = Subdivision Plat
- D./M. = Deed & Measured
- Dd = Deed
- Rec = Record
- Act = Actual

SURVEY REFERENCES:

1. Market Street Roadway Improvements, Prepared By C-T Consultants, 1989.
2. Market Street Dedication Plat, Vol.12, Pg.34.

CERTIFICATION:

I, THE UNDERSIGNED, HEREBY CERTIFY THAT THIS TOPOGRAPHY, INDICATED BY 6", 1", OR 2" CONTOURS, AND ELEVATIONS SHOWN HEREON, REPRESENT AN ACTUAL FIELD SURVEY MADE BY ME ON THE 24th DAY OF MAY, 2001, AND THAT THE ELEVATIONS WERE TAKEN AT APPROPRIATE INTERVALS AND THAT AS OF THAT DATE THEY EXISTED AS INDICATED HEREON.

I FURTHER CERTIFY THAT THIS PLAT WAS PREPARED FROM A FIELD SURVEY MADE UNDER MY DIRECT SUPERVISION. MONUMENTS WERE FOUND OR SET AS INDICATED. DIMENSIONS ARE EXPRESSED IN FEET AND DECIMAL PARTS THEREOF, ALL OF WHICH ARE CORRECT TO THE BEST OF MY KNOWLEDGE AND BELIEF. THIS PLAT WAS PREPARED IN ACCORDANCE WITH THE PROVISIONS OF CHAPTER 4733-37 OF THE OHIO ADMINISTRATIVE CODE. THIS PLAT WAS PREPARED WITHOUT THE BENEFIT OF AN ABSTRACT OF TITLE AND IS SUBJECT TO ANY STATE OF FACTS REVEALED BY AN EXAMINATION OF THE SAME.

James R. Pegoraro, P.S. 5388

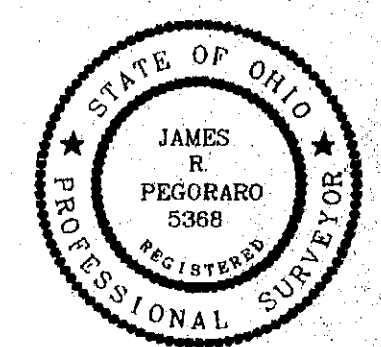

| REV. No. | DATE | BY | CHK'D |
|----------|------|----|-------|
| | | | |
| | | | |
| | | | |

LAND DESIGN consultants
www.LDCinc.net
ENGINEERS · PLANNERS · SURVEYORS

8585 East Avenue Mentor, Ohio 44060
TEL: (440) 255-8463 (440) 951-1440
(440) 554-6938 FAX: (440) 255-9575

1471 Leas Industrial Park Area, Ohio 44011
TEL: (440) 937-5601 (440) 937-5602
FAX: (440) 937-5603

PPN: 16C-78-05, Market Street
Lands Shown Are Known As Being A Part Of Original Mentor Township, Lot 5, In Tract 8, Situated Now In The City Of Mentor, County Of Lake, State Of Ohio.

DATE: June 5th, 2001
SCALE: HOR. 1"=40'-0"
VERT. 1"=10'-0"
FILENAME: JRP1\Survey.dwg
CHK'D BY: R.A.T.
Field: T.U.S.

PLAT OF SURVEY
Prepared For: **Laketran**

SHEET 1 OF 1
CONTRACT No. LAKET1-0001