

I hereby certify that this plat was prepared from a field survey made under my direct supervision. Monuments were found or set as indicated. Dimensions are expressed in feet and decimal parts thereof. Bearings refer to a Plat of Tyler Boulevard as shown. All of which are correct to the best of my knowledge and belief. This plat was prepared in accordance with the provisions of Chapter 4733-37 of the Ohio Administrative Code. This plat was prepared without the benefit of an abstract of title and is subject to any state of facts revealed by a examination of the same.

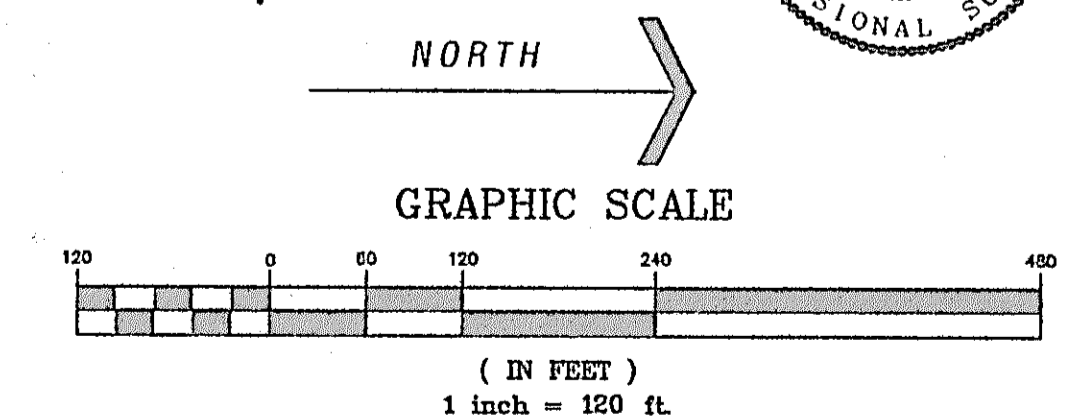
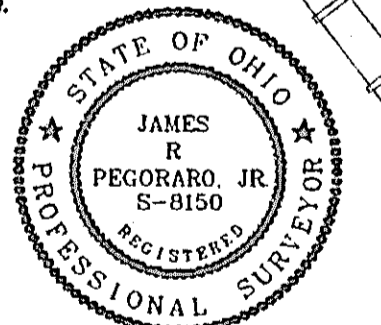

LEGEND

● Iron Pin Found	⊕ Drill Hole Found
○ Iron Pin Set	⊕ Drill Hole Set
⊙ Iron Pin Set	△ Horizontal Control Point
⊙ Monument Box Found	○ Vertical Control Point
□ Monument Box Empty	⊕ Hub Found
△ PK Set	⊕ Hub Set
△ PK Found	⊕ Railroad Spike Found
⊙ Stone Found	⊕ Railroad Spike Set
Meas = Measured	Dd = Deed
Plat = Subdivision Plat	Rec = Record
D.M. = Deed & Measured	Act = Actual

CURVE TABLE

CURVE	LENGTH	RADIUS	DELTA	TANGENT	CHORD	BEARING
C-1	46.36	50.00	53°07'48"	25.00	44.72	S21°52'17"W
C-2	203.44	50.00	233°07'48"	NA	89.44	S68°07'43"E
C-3	343.63	1970.00	10°00'00"	172.35	343.39	S86°42'09"W
C-4	257.81	680.00	21°43'21"	130.47	256.27	S80°50'28"W
C-5	172.73	432.00	22°54'33"	87.53	171.58	N51°05'32"E

REV. No.	DATE	BY	CHK'D

LAND DESIGN consultants
www.LDCinc.net
ENGINEERS · PLANNERS · SURVEYORS

8383 East Avenue, Mentor, Ohio 44060
TEL: (440) 255-8863 FAX: (440) 951-1480
(440) 354-6978 FAX: (440) 255-9372

1471 Lear Industrial Park, Avon, Ohio 44011
TEL: (440) 937-5601 FAX: (440) 937-5602
(440) 937-5603

Lands Remaining
Heisley-Hopkins, Inc.
City of Mentor - Lake County - Ohio

DATE February 12th, 2002
SCALE: HOR. 1"=120'
VERT. none
FILENAME Rem/Lands
COMPUTER Jrp
FIELD CREW

Plat of Survey
Remaining Lands of PPN:16B-62-01
Sited in the City of Mentor, County of Lake and State of Ohio, Known as being part of Original Township Lots 7 & 8, Tract 6 and Lot 3, Tract 7.

PRINTED 1/2002
LDC, INC.

SHEET	OF
1	1
CONTRACT No.	
Osair1-0201	