

CURVE #	LENGTH	RADIUS	DELTA	TANGENT	BEARING	CHORD
C1	160.08'	1382.29'	6°39'07"	80.13'	S40°41'30"W	160.00'
C2	248.89'	680.00'	20°58'15"	125.85'	S39°56'16"W	247.50'
C3	684.15'	7970.00'	4°55'06"	342.29'	N31°54'42"E	683.94'
C4	744.87'	8000.00'	5°20'00"	372.80'	N32°07'09"E	744.40'
C5	706.21'	650.00'	62°15'00"	392.49'	S60°34'39"W	671.98'
C6	57.74'	8000.00'	0°24'46"	28.87'	N34°34'45"E	57.74'

**SURVEY REFERENCES:**  
 PLAT OF SURVEY FOR 8989 TYLER BOULEVARD BY  
 MCSTEEN & ASSOCIATES DATED 4/09/07

Situated in the City of Mentor, County of Lake and State of Ohio, and known as being part of Original Mentor Township Lot No. 3, Tract No. 7

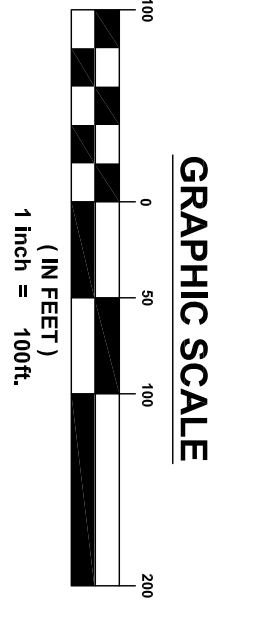

**AREA SUMMARY:**  
 P.N. 16-B-059-0-00-015-0 - 22.2683 ACRES  
 P.N. 16-B-059-0-00-027-0 - 4.0717 ACRES  
 CONSOLIDATED PARCEL - 26.3400 ACRES

**MONUMENT BOXES FOUND** COULD NOT BE OPENED.  
 POINTS RE-ESTABLISHED BY REFERENCE DRILL HOLES FOUND.

**CERTIFICATION:**  
 I HEREBY CERTIFY THAT AN ACTUAL BOUNDARY SURVEY WAS PREPARED BY ME ON THE 31st DAY OF DEC., 2019, AND THAT THE SURVEY IS IN ACCORDANCE WITH THE OHIO REVISION CODE CHAPTER 4733-37, MINIMUM STANDARDS FOR BOUNDARY SURVEYS IN THE STATE OF OHIO. PERMANENT MONUMENTS WERE FOUND, OR SET AT ALL LOCATIONS SHOWN HEREON. ALL DIMENSIONS GIVEN ARE EXPRESSED IN FEET OR DECIMAL PARTS THEREOF. BEARINGS ARE TO AN ASSUMED MERIDIAN AND ARE SHOWN TO INDICATE ANGLES ONLY. ALL PINS SET ARE 5/8" DIA., 30" LONG REBAR WITH CAP MARKED 'NOVAK 7507'.

I HEREBY CERTIFY THAT THIS PLAT WAS PREPARED BY ME AND IS CORRECT TO THE BEST OF MY KNOWLEDGE, INFORMATION AND BELIEF.

DAVID W. NOVAK  
 S-7507  
 SURVEYOR

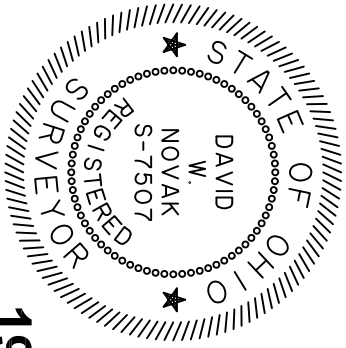

REVISIONS	BY

**Barrington**  
 CONSULTING GROUP, INC.  
 9114 TYLER BLVD., MENTOR, OHIO 44060  
 PHONE 440.205.1260 FAX 440.205.1262  
 www.BarringtonCGI.com

**BUYERS PRODUCTS COMPANY**  
**JIM LINES**  
 9049 TYLER BOULEVARD  
 MENTOR, OHIO 44060  
 CELL: 440-415-2442

**BUYERS PRODUCTS COMPANY**  
 9049 TYLER BOULEVARD  
 MENTOR, OHIO 44060  
**CONSOLIDATION PLAT**

DR. DWN  
 CHECKED  
 11/21/2019  
 SCALE: 1"=100'  
 SHEET NO. 19100  
 OF 11 SHEETS