

DISBRO, SHADRA LEE
9234 JOHNNYCAKE RIDGE ROAD
16-A-021-C-00-002-0
VOL. 1046, PG. 848

1
3.4930 AC
152156 SQ. FT.
(0.1269 AC IN RW)
K AND F QUALITY HOMES, INC.
9240 JOHNNYCAKE RIDGE ROAD
16-A-021-C-00-016-0
2012R027586

2
1.5629 AC
68080 SQ. FT.
(0.0735 AC IN RW)
K AND F QUALITY HOMES, INC.
16-A-021-C-00-004-0
2012R027586

HIDDEN HOLLOW SUBDIVISION No. 1,
VOL. P., PAGE 60

SITUATED IN THE CITY OF MENTOR, COUNTY OF LAKE AND STATE OF OHIO AND KNOWN AS BEING PART OF LOT 2, IN TRACT 1 BEARINGS USED HEREIN ARE TO DENOTE ANGULAR RELATIONSHIP ONLY AND DO NOT REPRESENT TRUE NORTH.

CERTIFICATION:
I HEREBY CERTIFY THAT AN ACTUAL BOUNDARY SURVEY WAS PREPARED BY ME ON THE 2nd DAY OF OCTOBER 2012, AND THAT THE SURVEY IS IN ACCORDANCE WITH THE OHIO REVISED CODE CHAPTER 4733-37, MINIMUM STANDARDS FOR BOUNDARY SURVEYS IN THE STATE OF OHIO. PERMANENT MONUMENTS WERE FOUND, OR SET AT ALL LOCATIONS SHOWN HEREON. ALL DIMENSIONS GIVEN ARE EXPRESSED IN FEET OR DECIMAL PARTS THEREOF. BEARINGS ARE TO AN ASSUMED MERIDIAN AND ARE SHOWN TO INDICATE ANGLES ONLY. ALL PINS SET ARE 5/8" DIA., 30" LONG REBAR WITH CAP MARKED "NOVAK 7507".

I HEREBY CERTIFY THAT, THIS PLAT WAS PREPARED BY ME AND IS CORRECT TO THE BEST OF MY KNOWLEDGE, INFORMATION AND BELIEF.

David W. Novak 01/14/2013
DAVID W. NOVAK, P.S. No. 7507

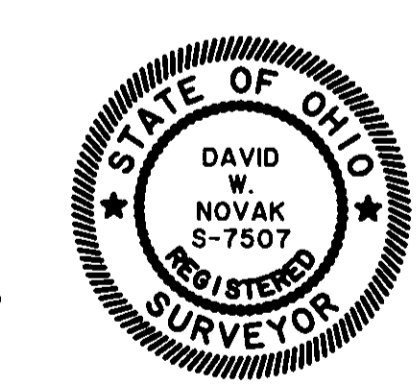
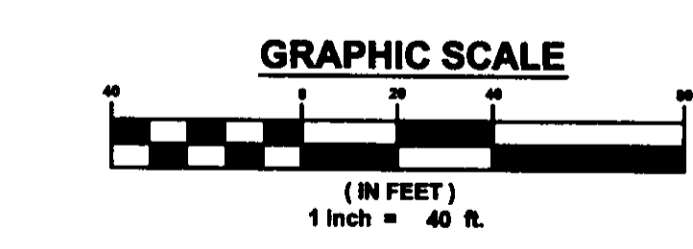

RECEIVED
CITY OF MENTOR
JAN 16 2013
ECONOMIC DEVELOPMENT
DEPARTMENT

PARCEL NUMBER	DEED	ADDRESS	OWNER(S)
1	16-A-021-F-00-002-0	870540	7746 HIDDEN HOLLOW DR. GAUBER LAWRENCE C & ANITA M
2	16-A-021-F-00-003-0	870540; 2004R045424	7756 HIDDEN HOLLOW DR. TRAN THANG (C)
3	16-A-021-F-00-004-0	8581280; 2003R028221	7764 HIDDEN HOLLOW DR. SMITH ROLAND J & AMY E
4	16-A-021-F-00-005-0	530227	7772 HIDDEN HOLLOW DR. GARTON ROBERT A & MARILYN J
5	16-A-021-F-00-006-0	82841	7780 HIDDEN HOLLOW DR. KRSTOLIC KENNETH & LYNDIA
6	16-A-021-F-00-007-0	481224; 200638832	7786 HIDDEN HOLLOW DR. CLAUSEN PETER & MELANIE
7	16-A-021-F-00-008-0	1861061	7794 HIDDEN HOLLOW DR. TRENTON ARTHUR M JR & JACKIE A
8	16-A-021-G-00-001-0	770128	7804 HIDDEN HOLLOW DR. HENKSON ROBERT E & RUTH ANN
9	16-A-021-G-00-002-0	617752; 990048913 2011R014137	7814 HIDDEN HOLLOW DR. JOBLING ALYBON TRUSTEE OF THE ALYBON JOBLING REV TRUST DTD 8/23/11
10	16-A-021-G-00-003-0	2007R031861	7822 HIDDEN HOLLOW DR. GLOWACKI CARMA LOU TR (C)
11	16-A-021-G-00-004-0	2011R019088	7828 HIDDEN HOLLOW DR. MEGERY BRIAN T & AMANDA S
12	16-A-021-G-00-005-0	564901; 2003R028965	7836 HIDDEN HOLLOW DR. JERSON JAMES A & CHRISTINE M
13	16-A-021-G-00-006-0	19370; 2001R036988	7836 HIDDEN HOLLOW DR. CHRISTOFF PATRICK T & AMY S
14	16-A-021-G-00-007-0	304852; 2003R028350	7846 HIDDEN HOLLOW DR. BANKAL JOHN R TR (C)

REVISIONS	BY

Barrington
CONSULTING GROUP, INC.
9114 TYLER BLYD., MENTOR, OHIO 44060
PHONE 440.205.1260 FAX 440.205.1262
www.BarringtonCGI.com

K and F Quality Homes
Gary Kovacich
10241 Karaboo
Concord, OH 44077
440.478.8455

LOT SPLIT
9240 JOHNNYCAKE RIDGE ROAD
MENTOR, OHIO 44060

KOVACICH RESIDENCE

DATE
NOV. 20 2012
SCALE
1" = 40'
JOB NO.
12075
SHEET

OF SHEETS